

RG4

Recessed / Grid

The Regolo RG4 series is a narrow recessed, nominal 4" wide profile, slot unit designed for grid ceiling systems. The slender design is ideal for corridors, open and private offices, classrooms, lobbies and general purpose rooms.

Construction: The housing consists of visible white powder coat extruded aluminum trim rails, with formed 20 gauge galvanized steel back channel and heavy gauge end caps. Steel alignment tabs and white snap-in joiner clips are used for continuous row applications. Luminaire is finished textured white.

Reflector / Driver: Reflector / driver cover is finished with high reflectant white paint. Drivers are standard constant current electronic driver with 0-10V dimming input with dimming range from 100% down to 1% and Universal (UNV) voltage from 120 - 277V, 50/60 Hz.

Shielding: Extruded frosted or satin white acrylic snap-in lens with DR.

LED Module: Distributed LED array in a variety of lumen output packages. LED color is available in 3000K, 3500K, 4000K or 5000K and in 80CRI or 90CRI. Module is replaceable. L90 ≥ 100,000 hrs.

Mounting: Compatible with 9/16" and 1" T-Bar and Slotted Grid ceilings. IC rated. Individual mount or continuous rows.

Labels: EL Listed, conforms to UL Standard 1598/8750, CSA Standard C22.2 and Damp Location.

Warranty: 5-Year Warranty Standard

Quick Ship: 10 Day lead time for options highlighted in orange. Available in 4' nominal increments; includes 4' & 8' standalone fixtures and continuous rows.

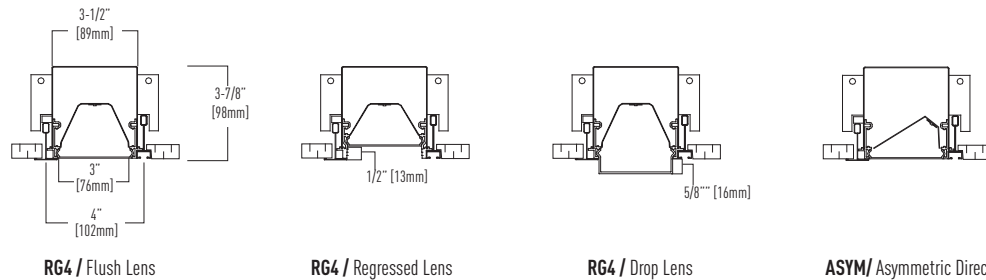

ORDERING INFORMATION / Example: QS-RG4-05-L35-U-D-11-FRF-WH-4

RG4					
SERIES	LUMEN PACKAGE ²	CRI/ CCT	VOLTAGE	DRIVER	
RG4¹ - Recessed Linear LED Luminaire Designed for Grid Ceilings, Nominal 4" Aperture Width. QS-RG4¹ - Quick Ship 10-Day Lead Time	03 - 390 lm/ft (3.28W/ft)	L30 - 80 CRI, 3000K	U - Universal	Dimming 0-10V D - Dim to 1% (Standard) D0⁴ - Dim to 1%, Fade to Off D02 - Eldoled Solodrive, Dim to 0% TW10 - Tunable White LUTRON - See options on page 2	
	05 - 569 lm/ft (4.85W/ft)	L35 - 80 CRI, 3500K	1 - 120 Volts		
	06 - 724 lm/ft (6.38W/ft)	L40 - 80 CRI, 4000K	2 - 277 Volts		
	09 - 899 lm/ft (7.79W/ft)	L50 - 80 CRI, 5000K			
	10 - 1036 lm/ft (9.39W/ft)	H30³ - 90 CRI, 3000K			
		H35³ - 90 CRI, 3500K			
		H40³ - 90 CRI, 4000K			
		TW - 90 CRI, 2700-6000K			

DALI Dimming

ELE - Eldoled Ecodrive, Dim to 1%
ELS - Eldoled Solodrive, Dim to 0%
TWDA - DALI Tunable White

CIRCUITING ⁵ / EMERGENCY OPTIONS ⁶			SHIELDING	FINISH	LENGTHS ⁹	OPTIONS
Qty of Power Circuits 1 - 1 Circuit 2 - 2 Circuits	Qty of Control Circuits 1 - 1 Circuit 2 - 2 Circuits	Options B5⁷ - 5 Watt Battery Pack B7⁷ - 7 Watt Battery Pack B12⁷ - 12 Watt Battery Pack CEC⁹ - CEC Compliant (10 Watt Battery Pack) EM - Dedicated Emergency Circuit GTD - Generator Transfer Device	FRF - Frosted Flush Lens FRL - Frosted Drop Lens (Luminous Ends) FRR⁸ - Frosted Regressed Lens STF - Satin White Flush Lens STL - Satin White Drop Lens (Luminous Ends) STR⁸ - Satin White Regressed Lens	WH - White Painted Finish SV - Silver Painted Finish BK - Black Painted Finish	2 - 24" 3 - 36" 4 - 48" 5 - 60" 6 - 72" 7 - 84" 8 - 96" XX - Specify run lengths in 6" increments (US 4" increments). Consult factory for custom lengths.	ASYM¹⁰ - Asymmetric Reflector CP - Chicago Plenum DSOS¹¹ - Combined Daylight and Occupancy Sensor FLEX - 6' of Flexible Conduit GLR - Fusing PMT - Perimeter Mount

Notes:

- Some products are DesignLights Consortium™ Qualified, refer to www.designlights.org Qualified Products List.
- Nominal lumen output per foot for frosted lens and 3500K.
- Significant efficacy reduction with 90CRI, consult factory for data.
- Consult factory for specifications and manufacturer.
- Multiple power circuits and control circuits can be accommodated. In Direct fixtures, the power and control circuits will be left to right within a fixture and/or row. Consult factory if the sum of the two numerals exceeds 4 (i.e. "32"). Unable to accommodate left-right zoning in fixtures 5' or less.
- The EM Option will illuminate the direct light of a 4' section in fixtures 6' or greater.

Notes (Continued):

- Battery Pack not available in fixtures 3' or less.
- The Satin White lens is recommended with the Regressed shielding.
- Fixtures can be provided in custom run lengths down to the nearest (+/- 1/8").
- Asymmetric reflector only available in the Frosted Flush Lens.
- Sensor not available in Drop Lens (FRD, FRL, STD or STL).

Specifications and dimensions are subject to change without notification.

Ceiling Grid Details

1" Grid Detail

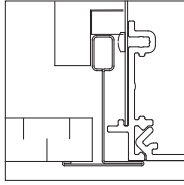

Standard Tile

9/16" Grid Detail

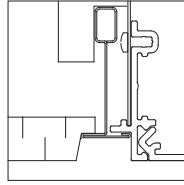

Tegular Tile

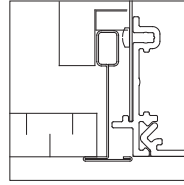

Standard Tile - 1-1/2" T height & supported by grid hook extension

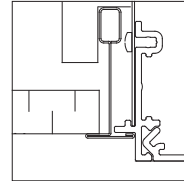

Standard Tile - Drop-down Luminaire

Screw Slot Detail

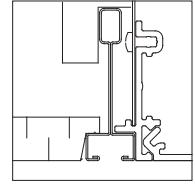

Tegular Tile

1" End Detail

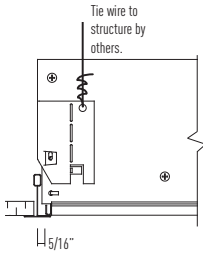

9/16" End Details

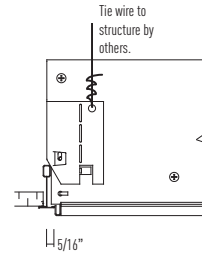
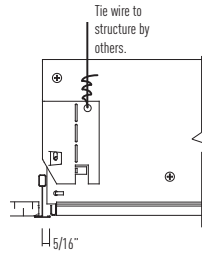
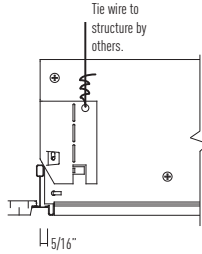

Screw Slot End Detail

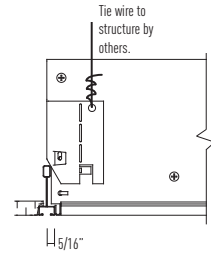

Conventional, Techzone, and Logix ceilings are acceptable.

Lens Options

Shielding



Frosted

Frosted Lens

This diffuser is designed for a balance between efficiency and lens uniformity. (Transmission ~ 89%)

Satin White Lens

This diffuser is designed for visible lens uniformity. It's recommended for regressed lens configuration in our shallow housing. (Transmission ~ 69%)

Lutron Driver Ordering Codes

Nulite Code	Lutron Prefix	Lutron Series	Dim Level	Quantity of Wires	Dim to Dark (Smooth)
L11*	PEQ	Hi-Lume™ Premiere	0.1%	2	X
L12	LTEA	Hi-Lume™ 2-Wire 120V forward phase	1%	No Control Wires - Uses Hot	
L15	LDE1	Hi-Lume™ H-Series	1%	2	X
L16	LDE5	Hi-Lume™ 5-Series	5%	2	

*Maximum lumen package with L11 is 05

Position

Regressed Lens - "R"



1/2" Regressed Lens (Satin White lens is

Drop Lens - "L"



1/2" Drop Lens with Luminous Acrylic Ends

DSOS Sensor Option:

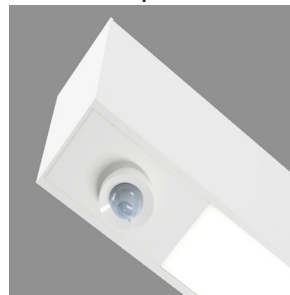

Integral Daylight and Occupancy Sensor

The Regolo series is available with a combination PIR occupancy and daylight sensor for daylight harvesting. Consult factory for more details on sensor operation and commissioning.

Individual Lengths

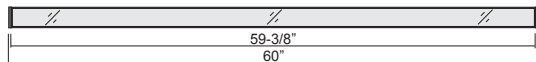
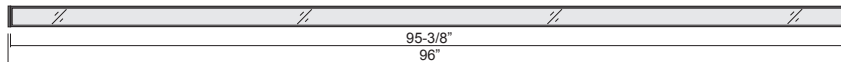
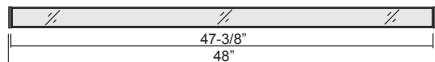
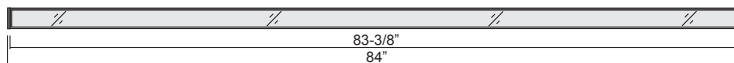
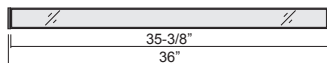
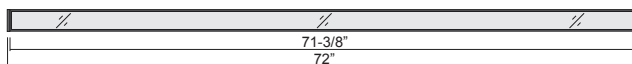
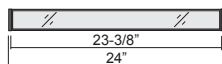

Continuous Row Joiner Detail

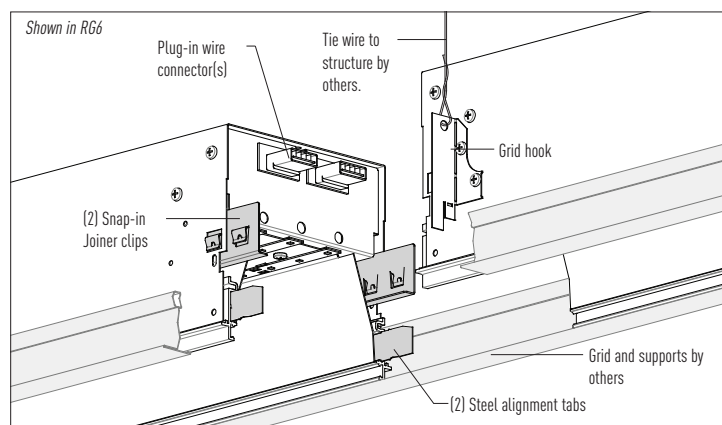

Continuous Run Lengths

Run Length

		2'	3'	4'	5'	6'	7'	8'	9'	10'	11'	12'	13'	14'	15'	16'	17'	18'	19'	20'	21'	22'	23'	24'	25'	26'	27'	28'	29'	30'	31'	32'	33'	34'	35'	36'	37'	38'	39'	40'	41'	42'	43'	44'			
Number of Housings	2'	1																																													
	3'		1																																												
	4'			1					1	1	1	1					1	1	1	1					1	1	1	1					1	1	1				1	1	1	1					
	5'				1				1				1				1				1				1		1	1	1				1				1				1						
	6'					1				1				1				1				1				1				1				1				1				1					
	7'						1				1				1				1				1				1				1				1				1				1				
	8'							1				1	1	1	1	1	2	1	1	1	2	2	2	2	3	2	2	2	3	3	3	3	4	3	3	3	4	4	4	4	5	4	4	4	5		

Photometric Curves

Cat. # RG4-05L35-...-FRF-...-4'
Frosted Flush Lens
 Wattage/ft - 4.85
 Lumens/Watt - 117

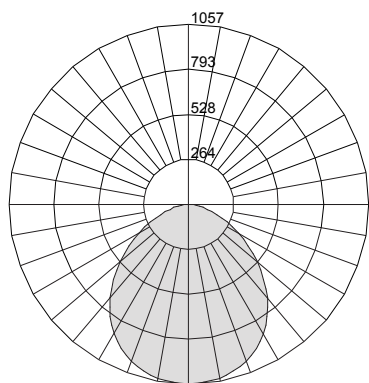

Cat. # RG4-09L35-...-FRF-...-4'
Frosted Flush Lens
 Wattage/ft - 7.79
 Lumens/Watt - 115

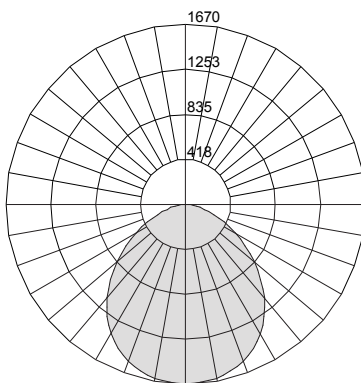

Cat. # RG4-05L40-...-FRF-...-4'-ASYM
Frosted Flush Lens
 Wattage - 5.25
 Lumens/Watt - 110

