

RG2

Recessed / Grid

Description:

The Regolo RG2 LED series is a narrow recessed, nominal 2" wide profile, slot unit designed for grid ceiling systems. The slender design is ideal for corridors, open and private offices, classrooms, lobbies and general purpose rooms.

Construction: The housing consists of visible extruded aluminum trim rails with formed cold rolled steel back channel and heavy gauge end caps. Steel alignment tabs and white snap-in joiner clips are used for continuous row applications. Luminaire is finished textured white.

Reflector / Driver: Reflector / driver cover is finished with high reflectance white paint. Standard constant current electronic driver with 0-10V dimming input; dimming range from 100% down to 1%. Universal (UNV) voltage is from 120 - 277V, 50/60 Hz.

Shielding: Extruded frosted or satin white acrylic snap-in lens with DR.

LED Module: Distributed LED array in a variety of lumen output packages. LED color is available in 3000K, 3500K or 4000K and in 80CRI or 90CRI. Module is replaceable. L90 > 100,000 hrs.

Mounting: Ceiling grid system. IC rated. Individual mount or continuous runs.

Labels: ETL listed, conforms to UL Standard 1598 / 8750 and CSA Standard C22.2, Damp location.

Warranty: 5-year limited warranty on LED and Driver.

Quick Ship: 10 Day lead times for options highlighted in orange. Only available in 4' and 8' individuals, and for continuous available in increments of 4'. 1000' maximum order size.

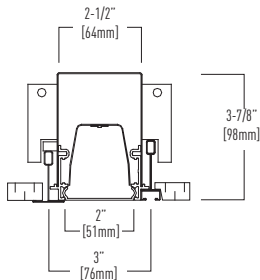

RG2 / Flush Lens

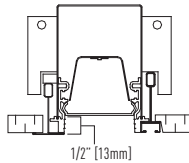

RG2 / Regressed Lens

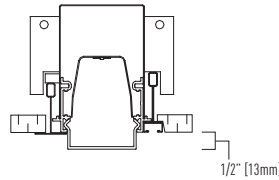

RG2 / Drop Lens



ORDERING INFORMATION / Example: QS-RG2-05-L35-1C-FRF-U-D-4

RG2	LUMEN PACKAGE	CRI/ CCT	CIRCUIT	SHIELDING / POSITION
RG2¹ - Recessed linear LED luminaire design for Grid ceilings, nominal 2" aperture width QS-RG2¹ - Quick Ship, 10 day lead time	03 - 300 lm/ft 05 - 500 lm/ft 06 - 600 lm/ft 09 - 900 lm/ft	L30 - 80 CRI, 3000K L35 - 80 CRI, 3500K L40 - 80 CRI, 4000K L50 - 80 CRI, 5000K H30 - 90 CRI, 3000K H35 - 90 CRI, 3500K H40 - 90 CRI, 4000K TW - 90 CRI, 2700-6000K	1C - Single Circuit 1E⁵ - Single Circuit w/ EM Circuit 1B⁵ - Single Circuit w/ Battery Pack 2C - Dual Circuit 2E - Dual Circuit w/ EM Circuit 2B - Dual Circuit w/ Battery Pack CEC - CEC Compliant (10W Battery Pack)	FR - Frosted Lens ST - Satin White Lens F - Flush R⁶ - Regressed L - Luminous Ends (Drop Lens) D - Opaque Ends (Drop Lens)

VOLTAGE	DRIVER ⁴	LENGTH	OPTIONS ⁵
U - Universal 1 - 120 volt 2 - 277 volt	Dimming 0-10V D³ - Dims to 1% (Standard) DO⁴ - Dims to 1%, fade to off DO2⁴ - Eldoled Solodrive, dims to 0% TW10 - 0-10v Tunable white driver DALI Dimming ELE - Eldoled Ecodrive, dims to 1% ELS - Eldoled Solodrive, dims to 0% TWDA - DALI Tunable white driver	2 - 2 ft 3 - 3 ft 4 - 4 ft 5 - 4 ft 6 - 4 ft 7 - 4 ft 8 - 8 ft XX⁷ - specify run lengths in 1' increments (QS 4' increments), consult factory for custom lengths	CP - Chicago Plenum DSOS⁸ - Combined daylight and occupancy sensor FLEX - 6' of flexible conduit GLR - Fusing

Notes:
 1. Some products are DesignLights Consortium™ Qualified, refer to www.designlights.org Qualified Products List.
 2. Nominal lumen output per foot for frosted lens and 3500K.
 3. Standard driver, don't connect low-voltage wires for non-dimming applications. Consult factory for specifications and manufacturer.
 4. Consult factory for specifications and manufacturer.
 5. Circuiting option does NOT come with a plug-in wire connector between units. Contractor must field wire. Battery N/A in 2' and 3'.

Notes (Continued):
 6. We recommend our Satin White lens for the Regressed position.
 7. 6" increments are common custom lengths. We can provide custom run length down to the nearest (+/- 1/8").
 8. Not available with Drop Lens.

Ceiling Grid Details

1" Grid Detail

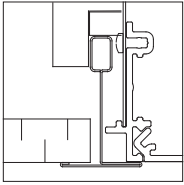

Standard Tile

9/16" Grid Detail

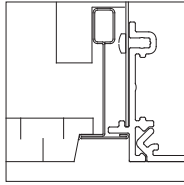

Regular Tile

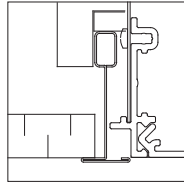

Standard Tile - 1-1/2"
"T" height & supported by grid hook extension

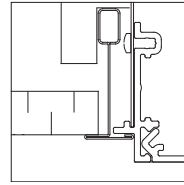

Standard Tile - Drop-down Luminaire

Screw Slot Detail

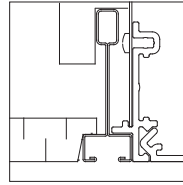

Regular Tile

1" End Detail

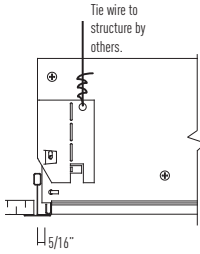

9/16" End Details

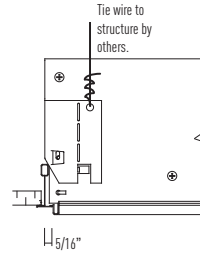
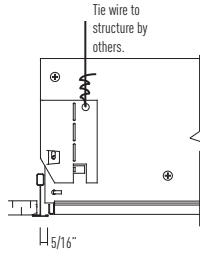
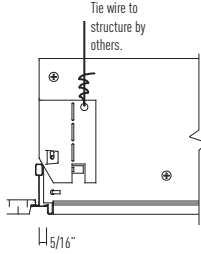

Screw Slot End Detail

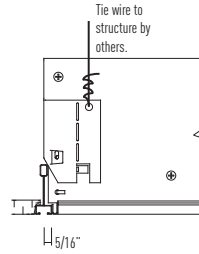

Lens Options

Shielding



Frosted Lens

This diffuser is designed for a balance between efficiency and lens uniformity. (Transmission ~ 89%)

Satin White Lens

This diffuser is designed for visible lens uniformity. It's recommended for regressed lens configuration in our shallow housing. (Transmission ~ 69%)

Lutron Driver Ordering Codes

Nulite Code	Lutron Prefix	Lutron Series	Dim Level	Quantity of Wires	Dim to Dark (Smooth)
L11*	PEQ	Hi-Lume™ Premiere	0.1%	2	X
L12	LTEA	Hi-Lume™ 2-Wire 120V forward phase	1%	No Control Wires - Uses Hot	
L15	LDE1	Hi-Lume™ H-Series	1%	2	X
L16	LDE5	Hi-Lume™ 5-Series	5%	2	

*Maximum lumen package with L11 is 05

Position

Regressed Lens - "R"

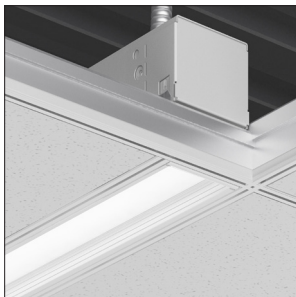

1/2" Regressed Lens (Satin White lens is

Drop Lens - "L"

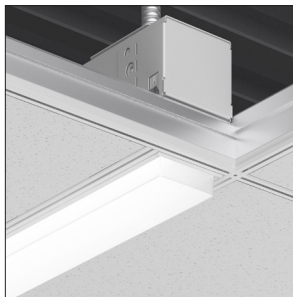

1/2" Drop Lens with Luminous Acrylic Ends

Sensor Option



Occupancy and/or Daylight Sensor

Individual Lengths

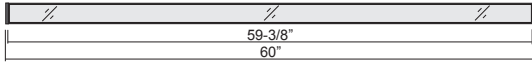
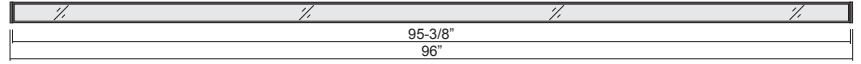
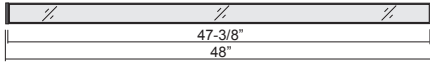
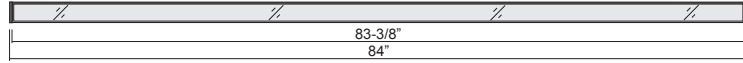
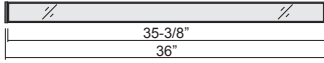
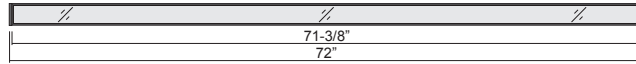
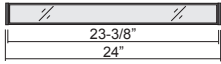

Continuous Row Joiner Detail

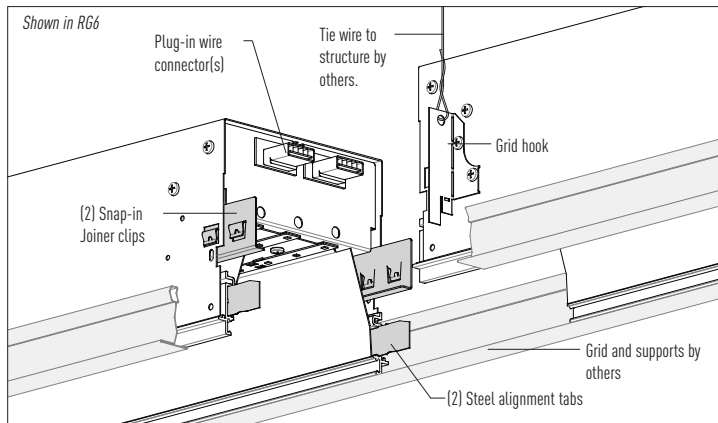

Continuous Run Lengths

Run Length

		2'	3'	4'	5'	6'	7'	8'	9'	10'	11'	12'	13'	14'	15'	16'	17'	18'	19'	20'	21'	22'	23'	24'	25'	26'	27'	28'	29'	30'	31'	32'	33'	34'	35'	36'	37'	38'	39'	40'	41'	42'	43'	44'						
Number of Housings	2'	1																																																
	3'		1																																															
	4'			1						1	1	1	1					1	1	1	1				1	1	1	1					1	1	1	1				1	1	1	1							
	5'				1						1		1					1			1				1			1					1			1														
	6'					1						1		1				1			1				1			1					1			1														
	7'						1					1		1				1			1				1			1					1			1														
	8'							1				1	1	1	1	1	2	1	1	1	2	2	2	2	3	2	2	2	3	3	3	3	4	3	3	3	4	4	4	4	4	5	4	4	4	5				

Photometric Curves

Cat. # RG2-05L35...-FRF...-4'
 Frosted Flush Lens
 Wattage/Ft - 4.85
 Lumens/Watt - 118

