



WARNINGS:

- Do not assemble continuous run on the ground and lift into place. Joints will distort and not create a tight fit. Joining hardware will have to be purchased and replaced.
- Risk of electrical shock or fire, disconnect power during installation or servicing. Read all instructions completely before starting installation. Install and wire in accordance to all national and local codes by a certified electrician. Fixture may be sharp, handle with care. Let fixture cool before maintenance.

ADVERTENCIA:

Riesgo de descarga eléctrica o un incendio, desconecte la alimentación durante la instalación o servicio. Leer todas las instrucciones completas antes de empezar la instalación. Instalar y cablear en acuerdo a las reglas nacionales y códigos locales por un electricista certificado. El accesorio puede estar agudo, agarre con cuidado deje que el accesorio se enfríe antes de mantenimiento.

AVERTISSEMENTS:

- Risque d'électrocution ou d'incendie. Déconnectez l'alimentation durant l'installation ou la maintenance. Lisez attentivement toutes les instructions avant de commencer toute installation. Faites installer et câbler selon les normes Nationales et Locales par un électricien certifié. Les installations peuvent être coupantes, à manipuler avec précaution. Laissez refroidir les installations avant une opération de maintenance.

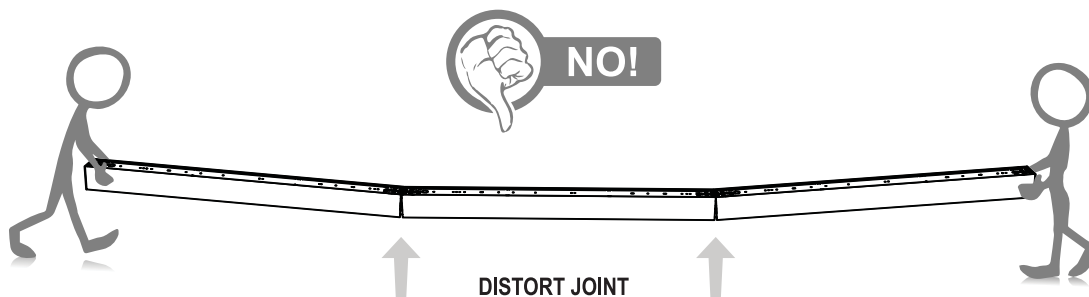

INSTALLATION AND MOUNTING DETAILS

Inaccessible Ceilings (Sheet Rock Typical)

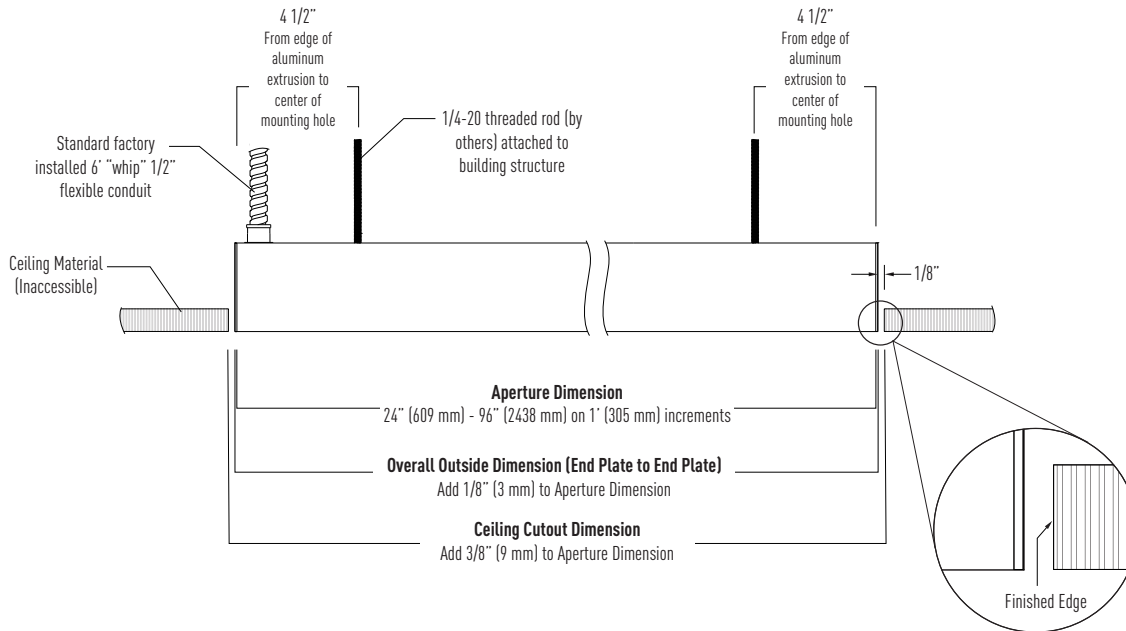

ROW LAYOUT DETAILS

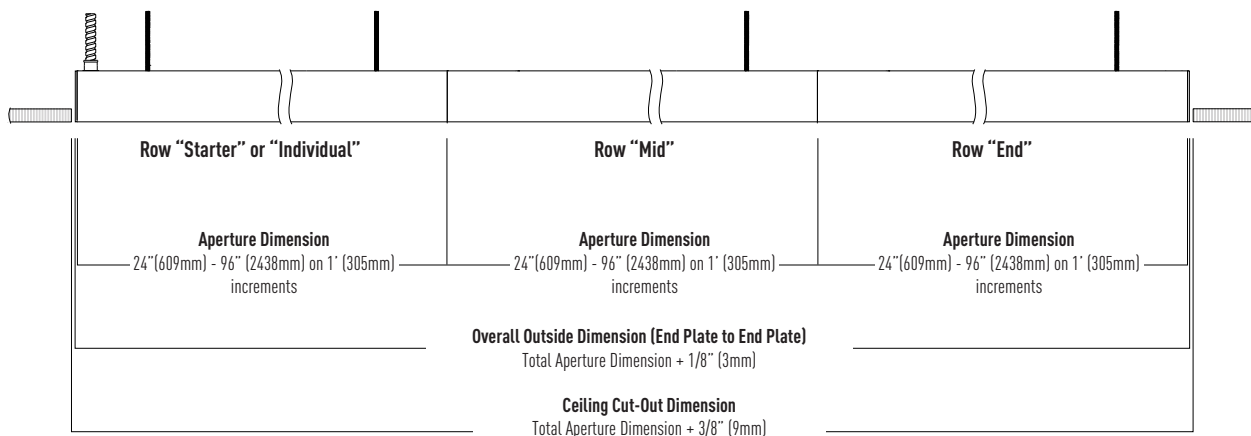

INSTALLING AN INDIVIDUAL OR ROW- STARTER LUMINAIRE

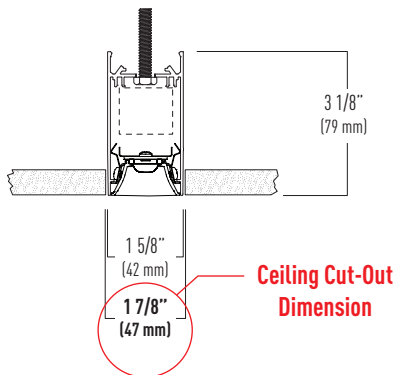

Ceiling Cut-Out
Dimension



1

Prepare Ceiling and Aperture as Shown, Interior Vertical Edge Must be of Premium Tolerance and Finish

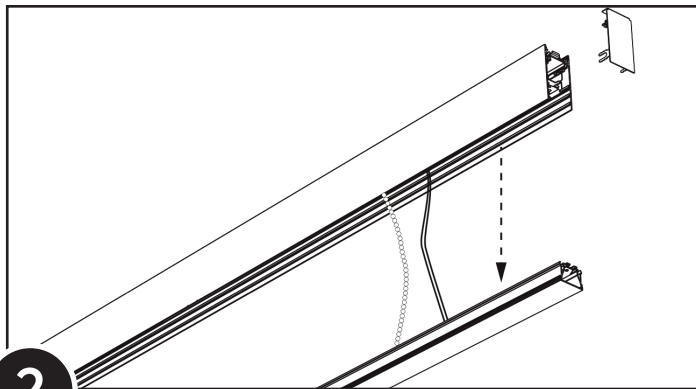

2

Remove End Cap and Dislodge Lens or Baffle

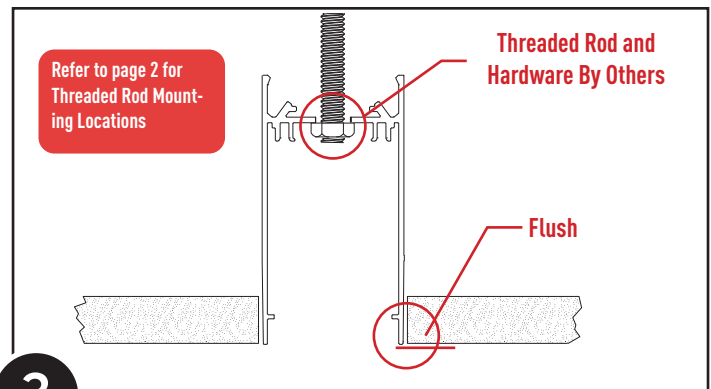

3

Connect Fixture to Structure with threaded rod (by others) and make sure bottom of fixture is level with ceiling surface

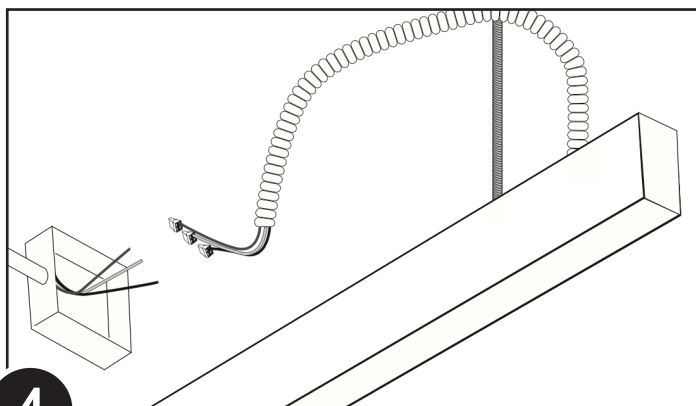

4

Make Low Voltage and Line Voltage Building connections with pre-attached flex conduit

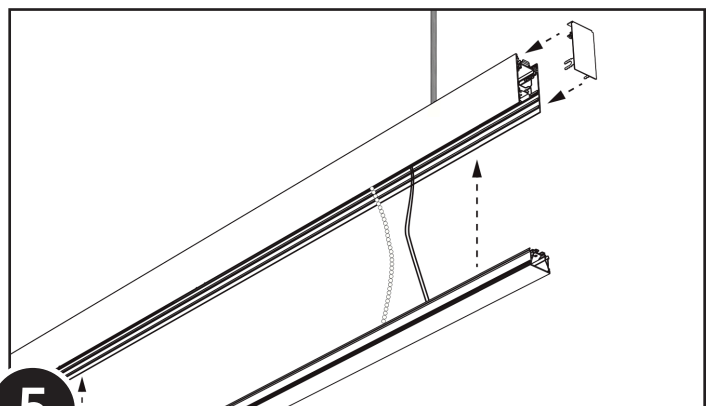

5

Re-Attach Lens/Baffle and End Cap, Energize Luminaire, Great Job, You are Done!

INSTALLING A MID OR ROW-END IN A CONTINUOUS ROW

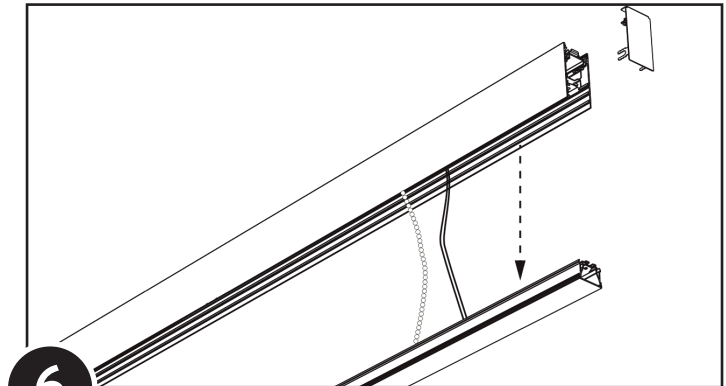

6

Locate Next Fixture In Row, Remove Lens or Baffle Assembly with Small Flathead Screw Driver or Pick

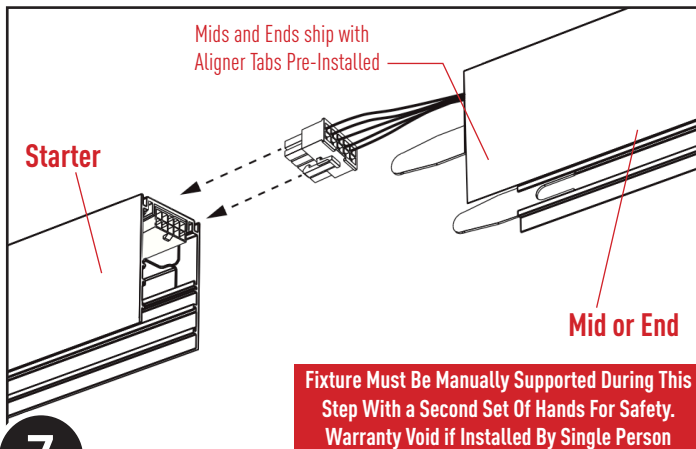

7

Pull Out Male Wire Harness and Align To Female Harness In First Fixture

Fixture Must Be Manually Supported During This Step With a Second Set Of Hands For Safety. Warranty Void if Installed By Single Person

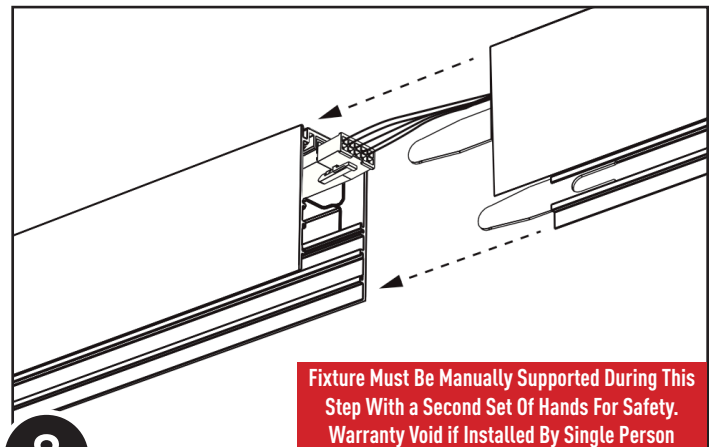

8

Make Quick Wire Connection of Power and Low Voltage Control Thru-Wiring

Fixture Must Be Manually Supported During This Step With a Second Set Of Hands For Safety. Warranty Void if Installed By Single Person

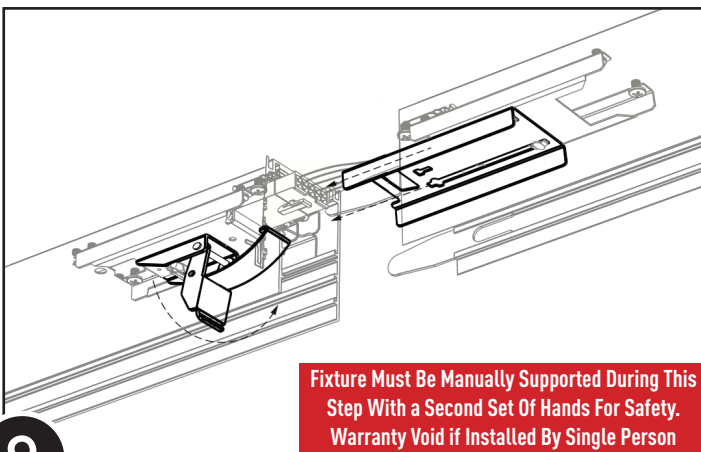

9

Slide Out Joining Bracket In Next Fixture

Fixture Must Be Manually Supported During This Step With a Second Set Of Hands For Safety. Warranty Void if Installed By Single Person

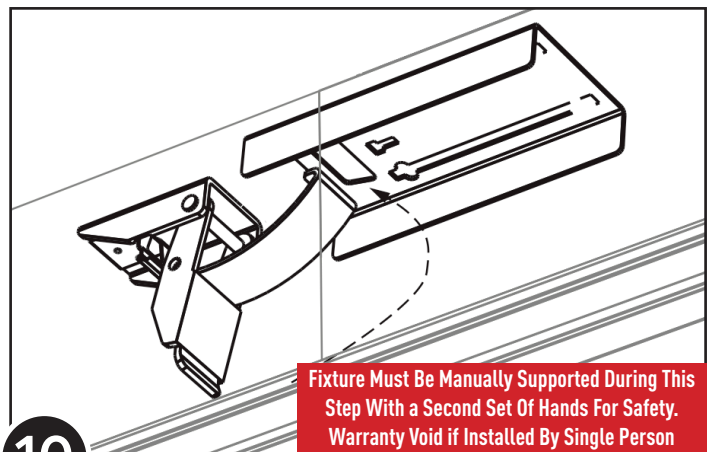

10

Align Joining Buckle In First Fixture To Slot In Bracket In Second Fixture

Fixture Must Be Manually Supported During This Step With a Second Set Of Hands For Safety. Warranty Void if Installed By Single Person

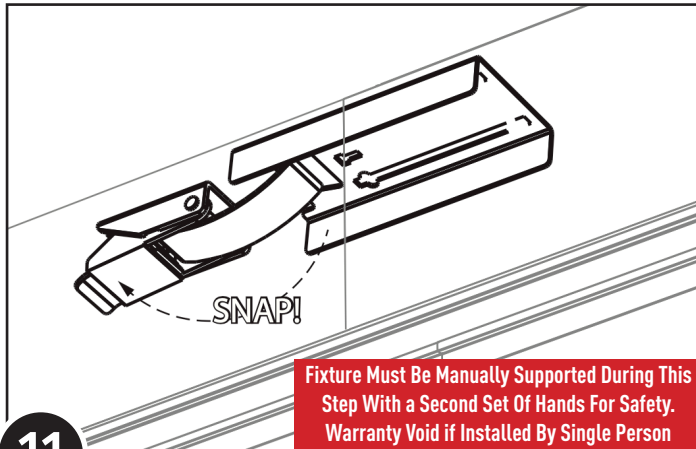

11

Snap Joining Buckle Backward for Final Fixture Joining

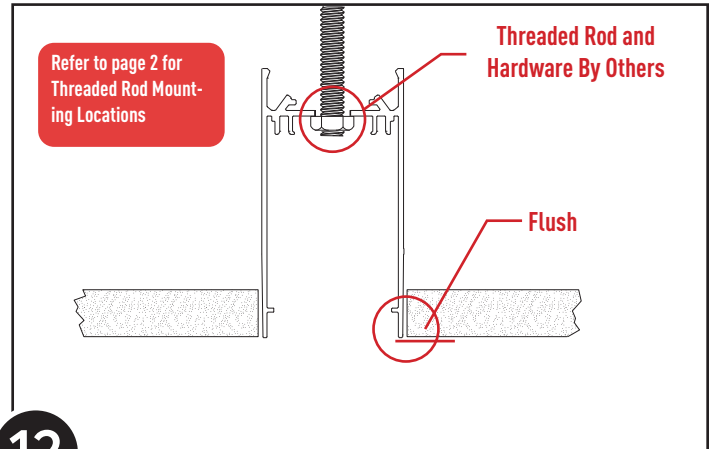

12

Connect Fixture to Structure with threaded rod (by others) and make sure bottom of fixture is level with ceiling surface

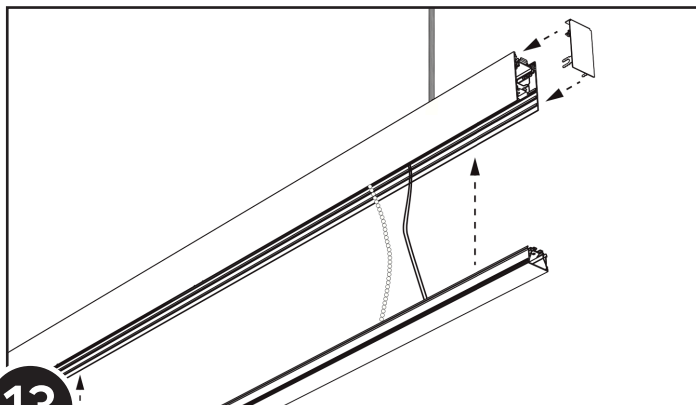

13

Re-Attach Lens/Baffle and End Cap, Energize Luminaire, You are Done, Great Job!!