

WARNINGS:

- Do not assemble continuous run on the ground and lift into place. Joints will distort and not create a tight fit. Joining hardware will have to be purchased and replaced.
- Risk of electrical shock or fire, disconnect power during installation or servicing. Read all instructions completely before starting installation. Install and wire in accordance to all national and local codes by a certified electrician. Fixture may be sharp, handle with care. Let fixture cool before maintenance.

ADVERTENCIA:

Riesgo de descarga eléctrica o un incendio, desconecte la alimentación durante la instalación o servicio. Leer todas las instrucciones completas antes de empesar la instalación. Instalar y cablear en acuerdo a las reglas nacionales y códigos locales por un electricista certifi cado. El accesorio puede estar agudo, agarre con cuidado deje que el accesorio. Enfriar antes de mantenimiento.

AVERTISSEMENTS:

- Risque d'électrocution ou d'incendie. Déconnectez l'alimentation durant l'installation ou la maintenance. Lisez attentivement toutes les instructions avant de commencer toute installation. Faites installer et câbler selon les normes Nationales et Locales par un électricien certifi é. Les installations peuvent être coupantes, à manipuler avec précaution. Laissez refroidir les installations avant une opération de maintenance.

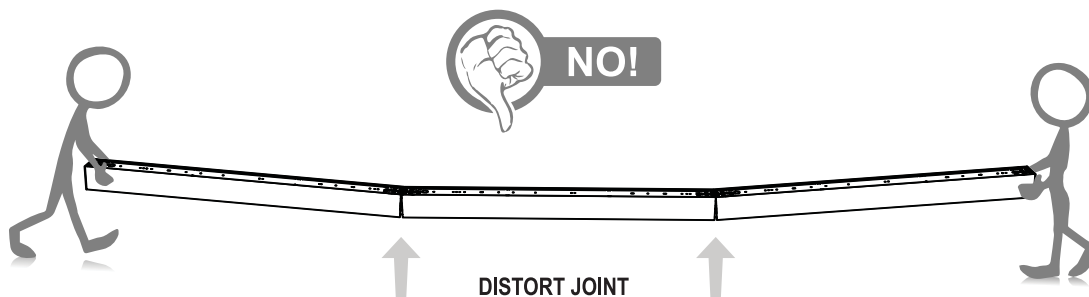

INSTALLATION AND MOUNTING DETAILS

Inaccessible Ceilings (Sheet Rock Typical)

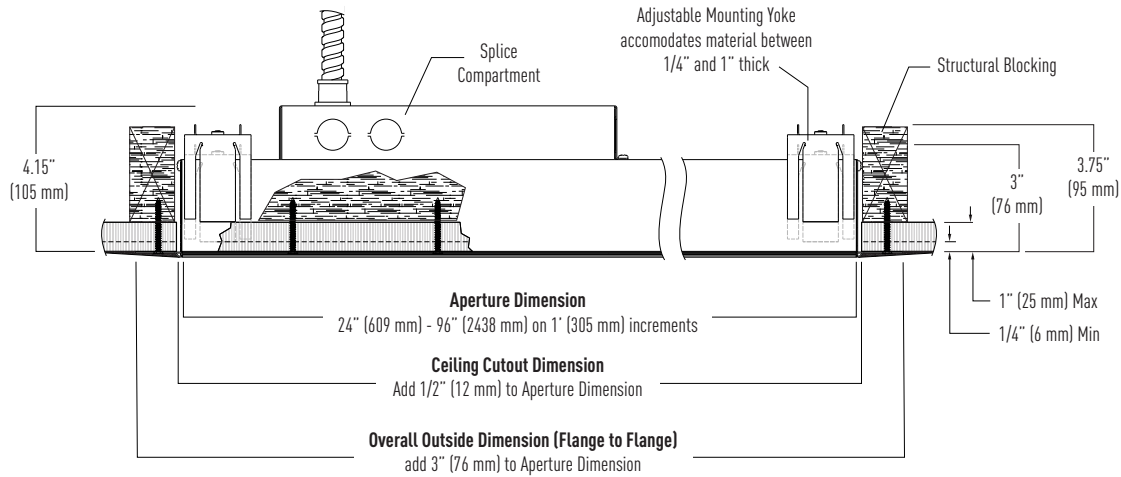

ROW LAYOUT DETAILS

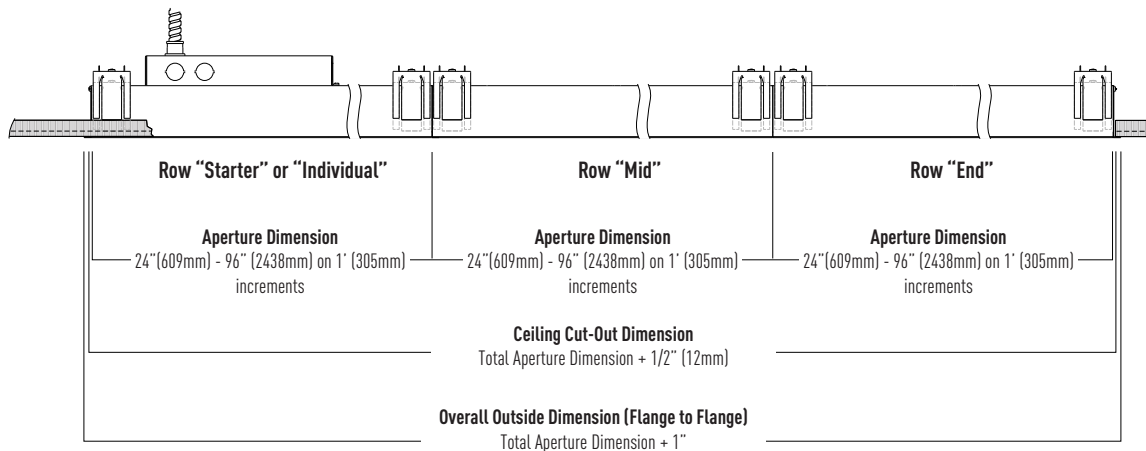

INSTALLING AN INDIVIDUAL OR ROW- STARTER LUMINAIRE

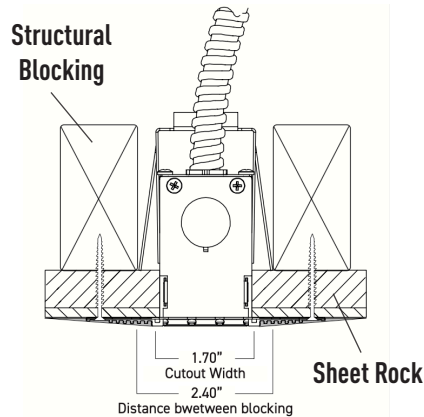

1 Appropriate Tradesmen to Prepare Ceiling, Electrical Whip and Blocking As Shown, and then Make Ceiling Cut-Out

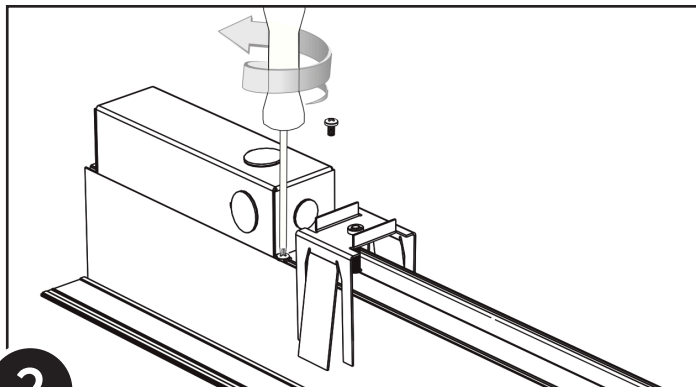

2 Remove Splice Box With Philips Head Screw Driver

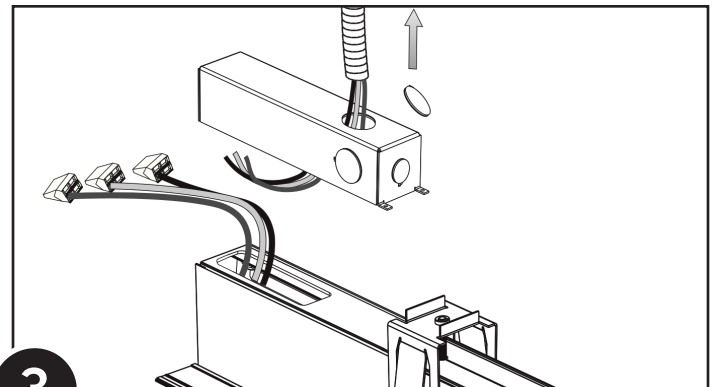

3 Remove 7/8" Knock-Out and Feed Line and Low Voltage Leads Through Opening

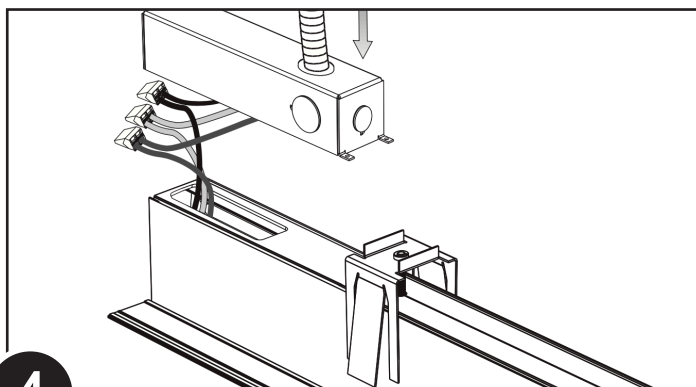

4 Connect Whip and Make Line and Low Voltage Wire Connections

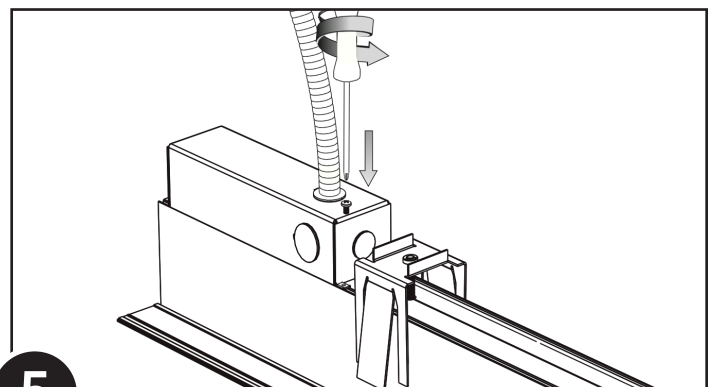

5 Re-Attach Splice Box

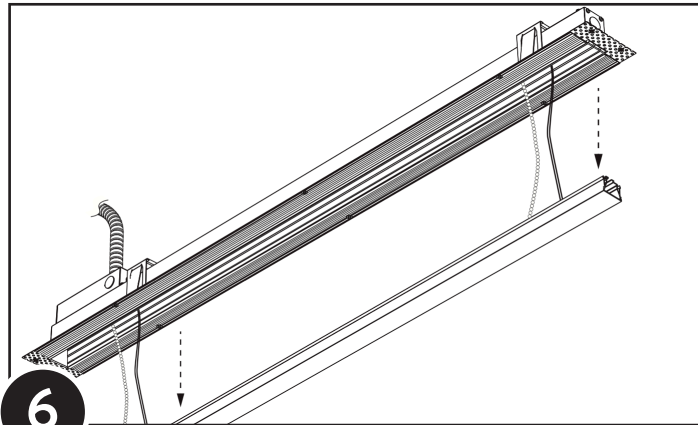
6

Remove Lens or Baffle Assembly with Small Flathead Screw Driver or Pick

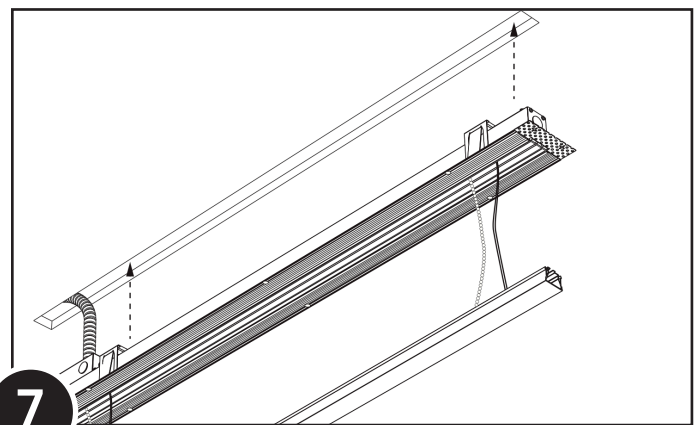

7

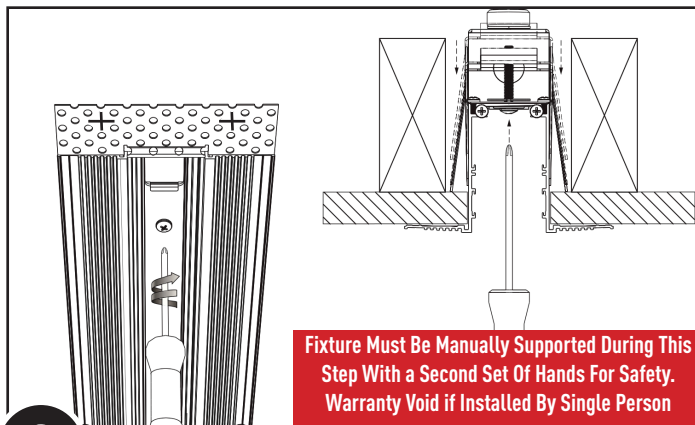
Insert Fixture Into Drywall Cut-Out

8

From Inside Fixture Use Philips Head to Cinch Down Yoke Bracket By Rotating Screw Clockwise

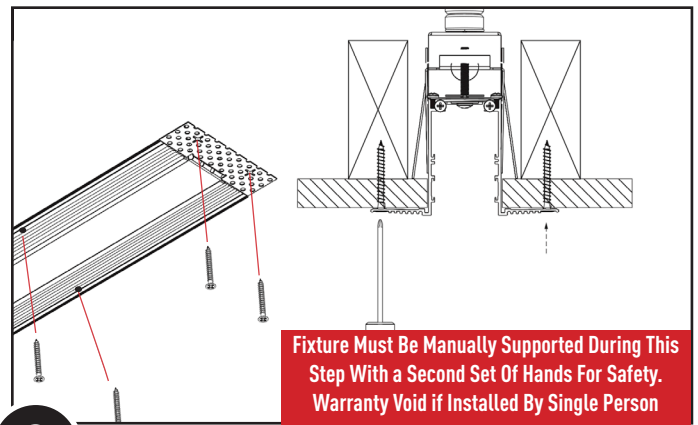
Fixture Must Be Manually Supported During This Step With a Second Set Of Hands For Safety. Warranty Void if Installed By Single Person



9

Secure Fixture To Structure by Drilling Appropriate Screws (By Others) Through Flange Holes

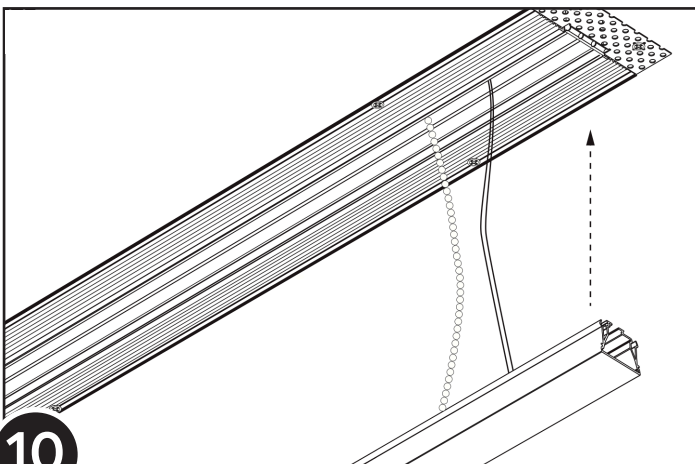
Fixture Must Be Manually Supported During This Step With a Second Set Of Hands For Safety. Warranty Void if Installed By Single Person

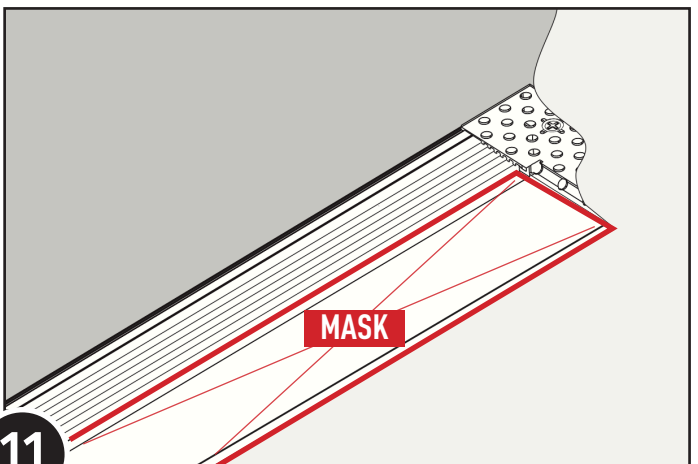

10

Snap Lens or Baffle Back Into Fixture Aperture

11

Appropriate Tradesman to "Float" Plaster To Finished Edge of Fixture and Paint up to Finished Edge. Energize Fixture and You are Done!

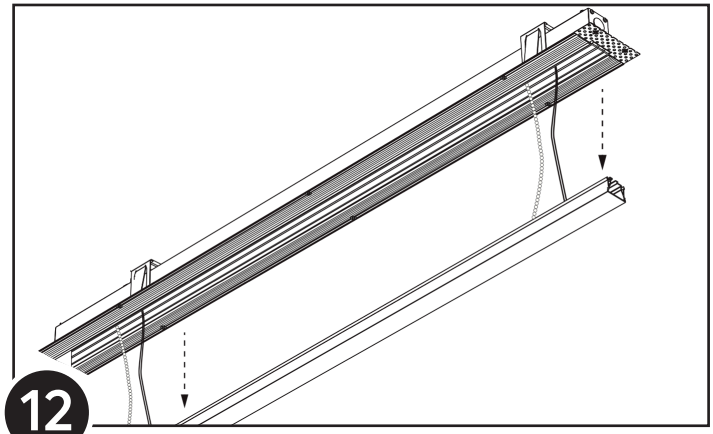
INSTALLING A MID OR ROW-END IN A CONTINUOUS ROW



12

Locate Next Fixture In Row, Remove Lens or Baffle Assembly with Small Flathead Screw Driver or Pick

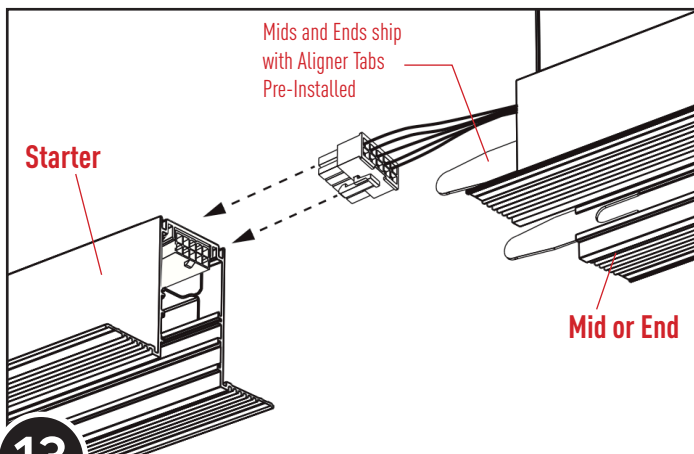

13

Pull Out Male Wire Harness and Align To Female Harness In First Fixture

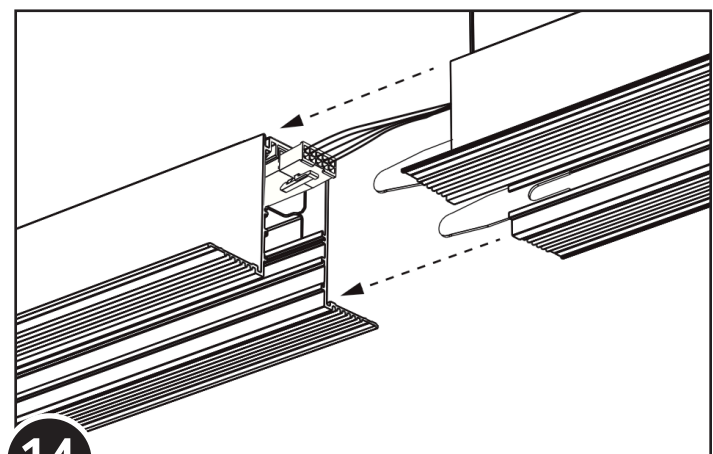

14

Make Quick Connect Of Power and Low Voltage Control Through Wiring

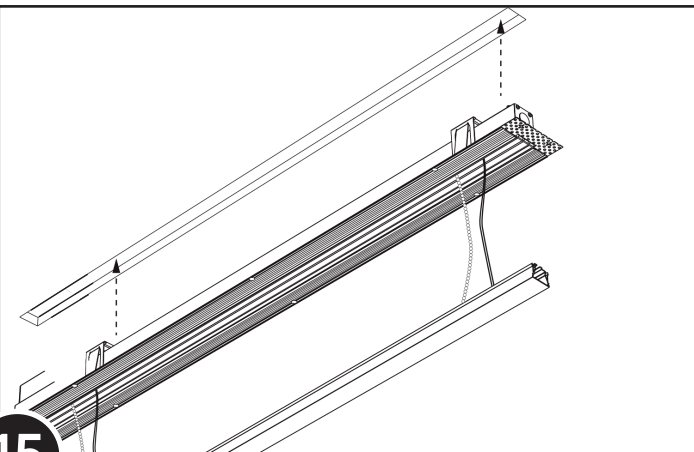

15

Insert Fixture Into Drywall Cut-Out

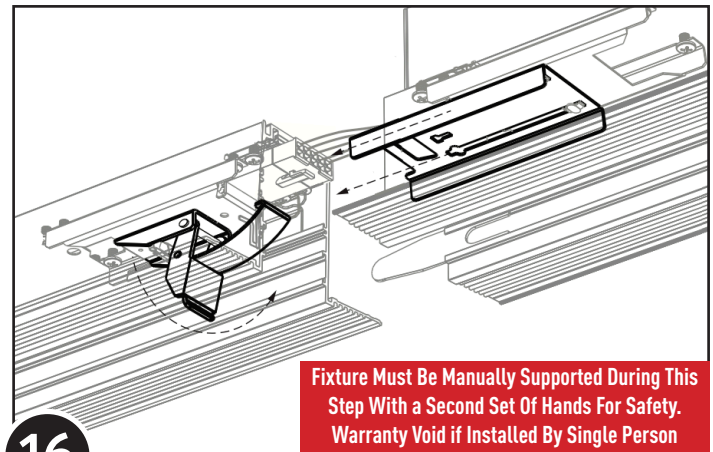

16

Locate Joining Buckle On First Fixture, And Then Slide Out Joining Bracket On Second Fixture

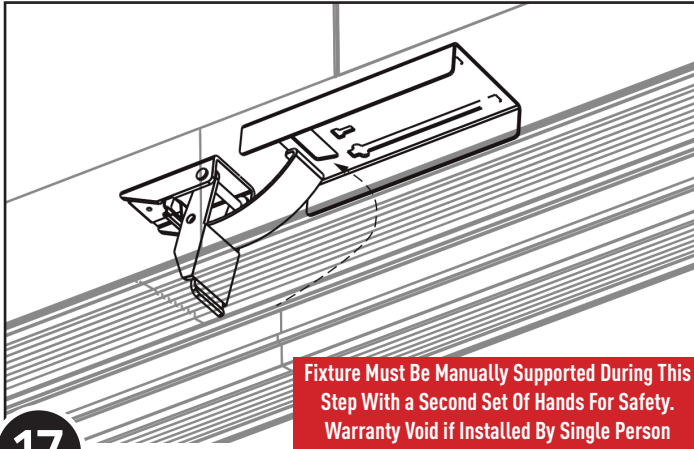

17

Rotate Joining Buckle Into Slot Opening In Joining Sleeve in Second Fixture

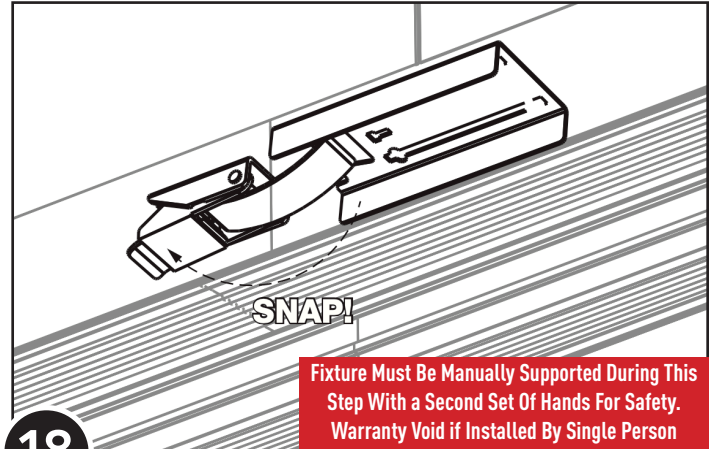

18

Snap Joining Buckle Back Into Place For Final Fixture Joining

REPEAT STEPS 8-11

19