



WARNINGS:

- Do not assemble continuous run on the ground and lift into place. Joints will distort and not create a tight fit. Joining hardware will have to be purchased and replaced.

- Risk of electrical shock or fire, disconnect power during installation or servicing. Read all instructions completely before starting installation. Install and wire in accordance to all national and local codes by a certified electrician. Fixture may be sharp, handle with care. Let fixture cool before maintenance.

AVERTISSEMENTS

- Risque d'électrocution ou d'incendie. Déconnectez l'alimentation durant l'installation ou la maintenance. Lisez attentivement toutes les instructions avant de commencer toute installation. Faites installer et câbler selon les normes Nationales et Locales par un électricien certifié. Les installations peuvent être coupantes, à manipuler avec précaution. Laissez refroidir les installations avant une opération de maintenance.

ADVERTENCIA

- Riesgo de descarga eléctrica o un incendio, desconecte la alimentación durante la instalación o servicio. Leer todas las instrucciones completas antes de empezar la instalación. Instalar y cablear en acuerdo a las reglas nacionales y códigos locales por un electricista certificado. El accesorio puede estar agudo, agarre con cuidado deje que el accesorio. Enfriar antes de mantenimiento.

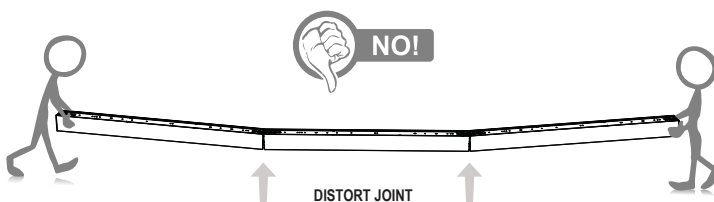

1. LUMINAIRE



Package Contents

Luminaire

Includes Factory installed 4 conductor low voltage power cord (48" or 120")

2. SURFACE MOUNTED DRIVER ENCLOSURE

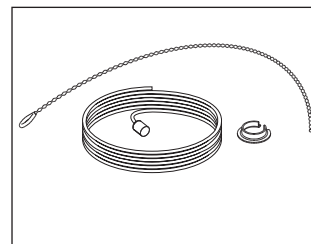
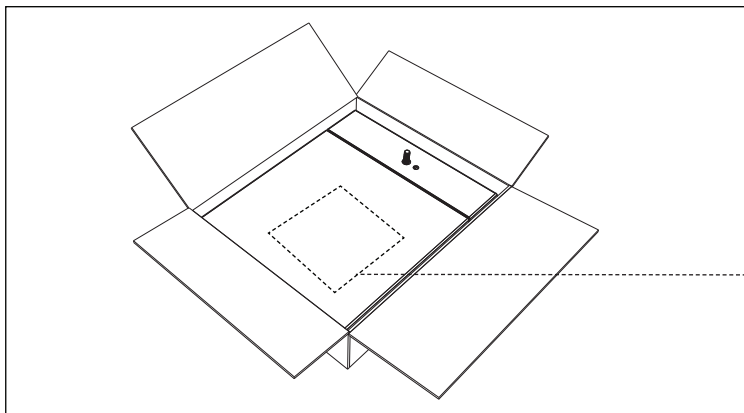

Package Contents

- Driver enclosure for surface mounting applications
- Power Canopy Hardware Packet
 - (1) Metal cord crimp
 - (1) Zip tie
 - (1) 48" or 120" aircraft cable

3. NON-POWER MOUNT HANGING HARDWARE

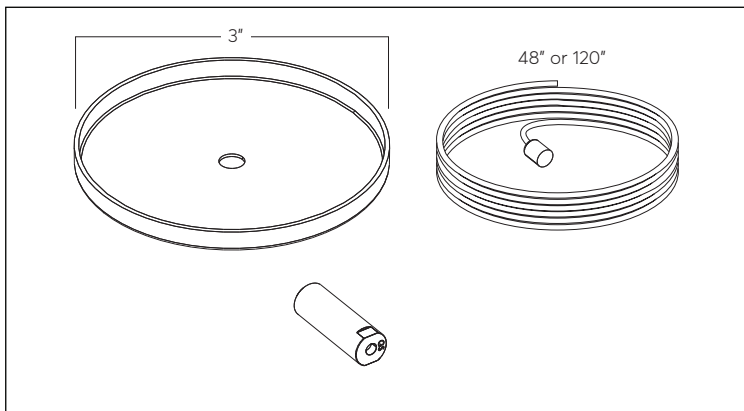

Package Contents

- Non-Power Canopy Hardware Packet
 - (1) 3" diameter canopy
 - (1) Stainless Steel aircraft cable coupler
 - (1) 48" or 120" aircraft cable

NOTE: Non-Power canopy hardware is only necessary for individual and row starter luminaires

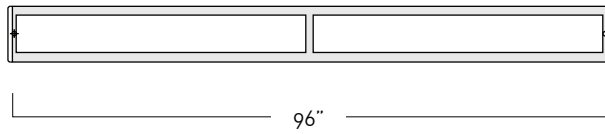
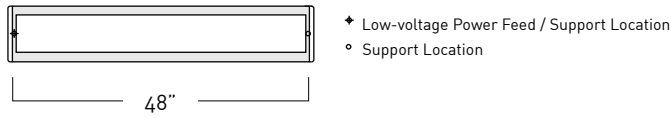

Individual

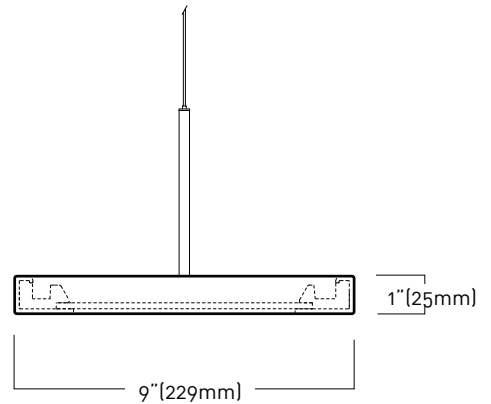
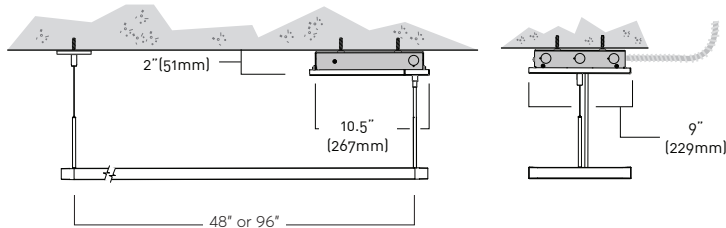

Continuous Row

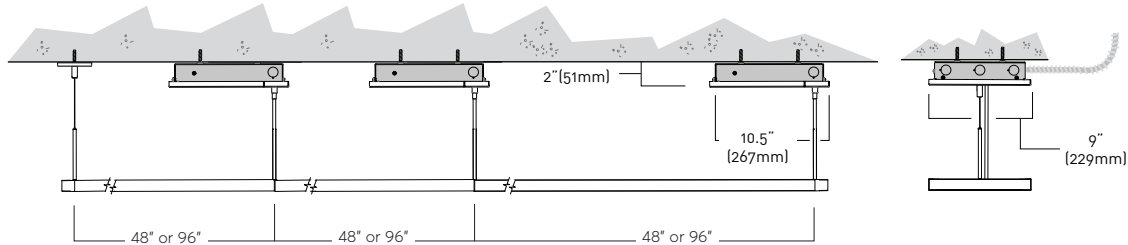

DRIVER ENCLOSURE DIMENSIONS

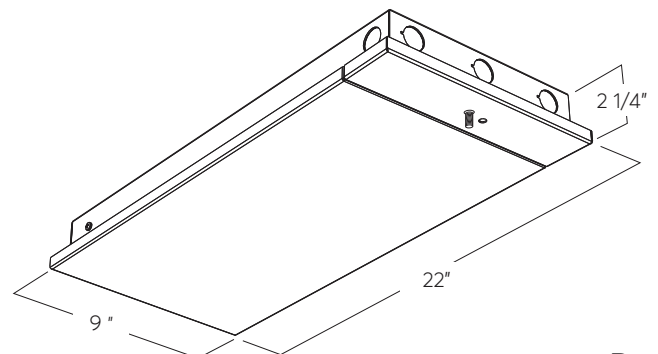
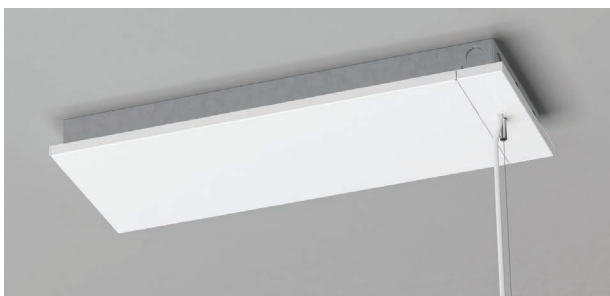
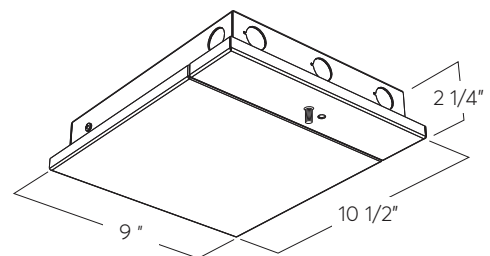

INSTALL DRIVER ENCLOSURE/ POWER MOUNT

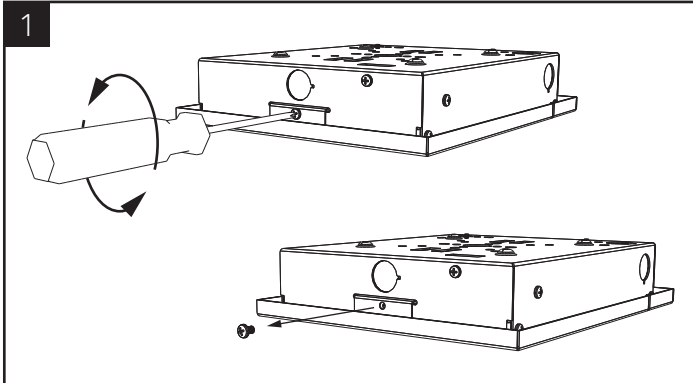

1 Remove the security screw from the wiring box cover.

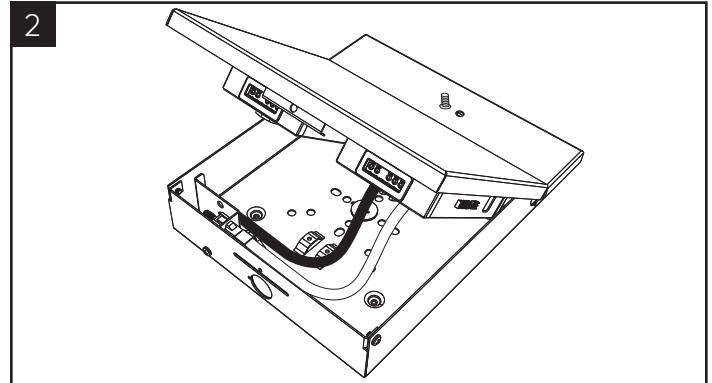

2 Lift open the wiring box cover.

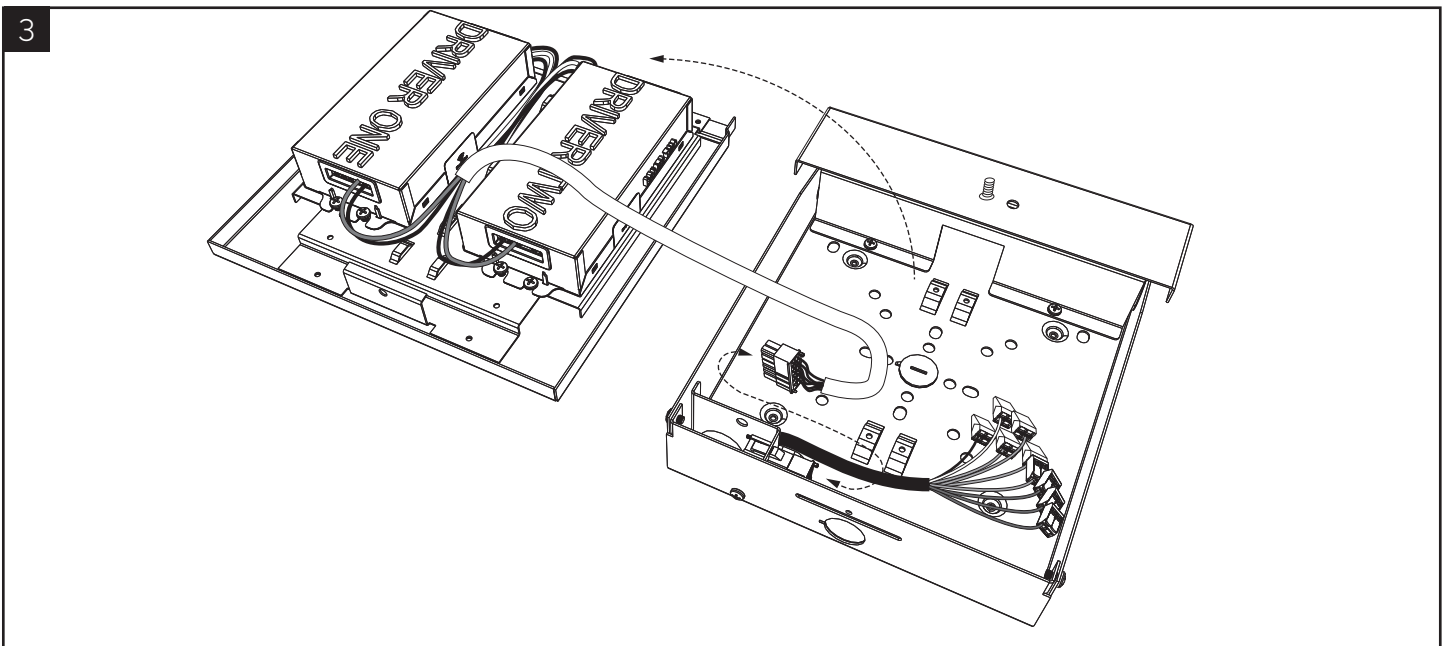

3 Remove wiring box cover and disconnect the driver wiring harness from the wiring box. Set cover aside.

INSTALLING AN INDIVIDUAL OR ROW STARTER LUMINAIRE

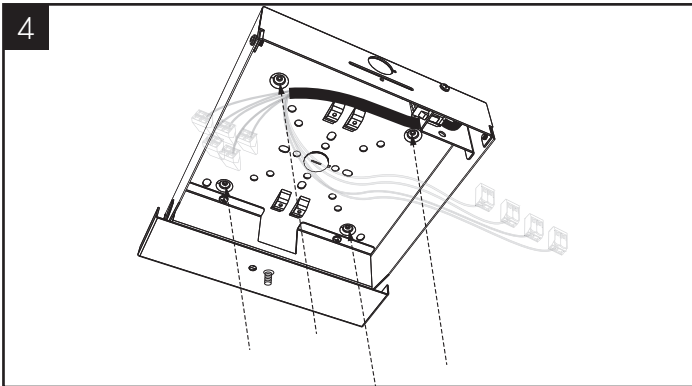

Mount wiring box to structure at the indicated holes. Mounting hardware by others.

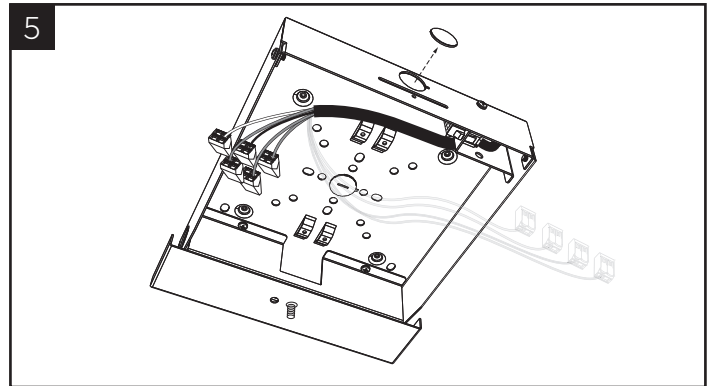

Remove knockout for line voltage.

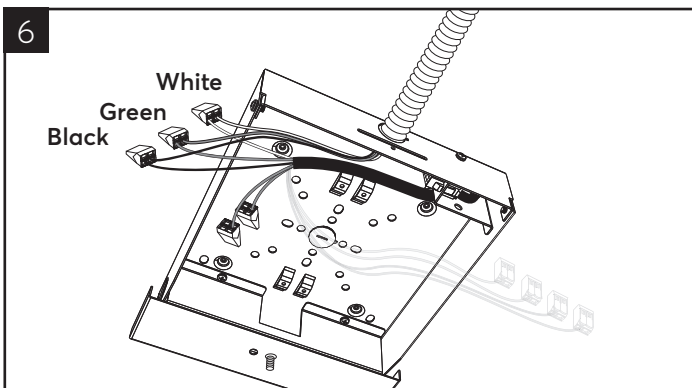

Connect line voltage flex to wiring box. Connect line voltage leads to wiring harness. Black (Hot), Green (Ground), White (Neutral).

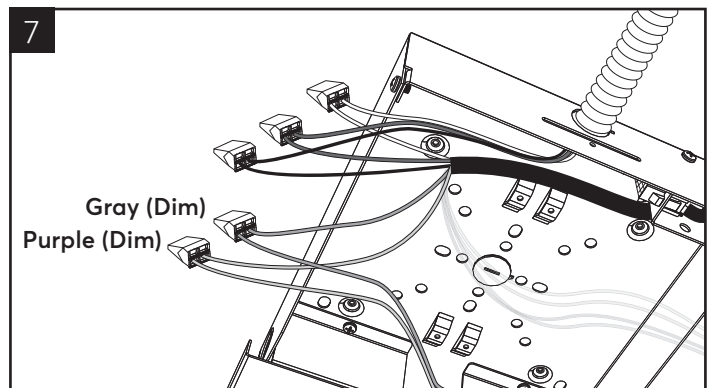

If Dimming is required make dimming wire connections.

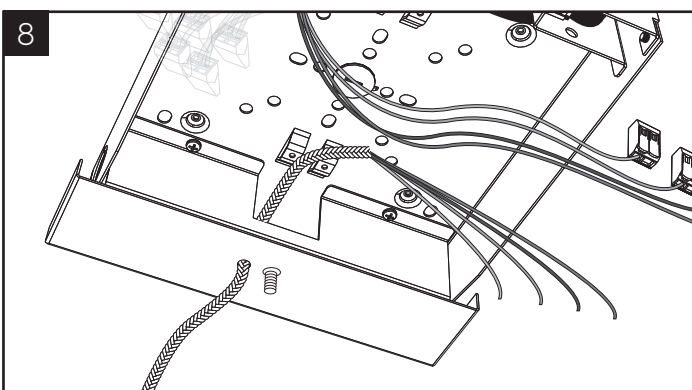

Feed braided silver fixture cord through hole

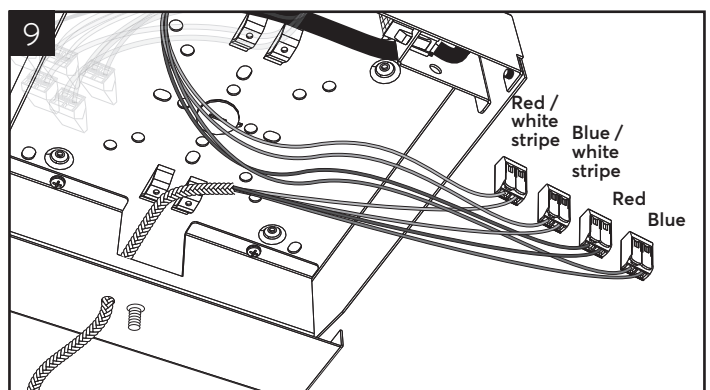

Connect low voltage wires from fixture cord as shown.

INSTALLING AN INDIVIDUAL OR ROW STARTER LUMINAIRE

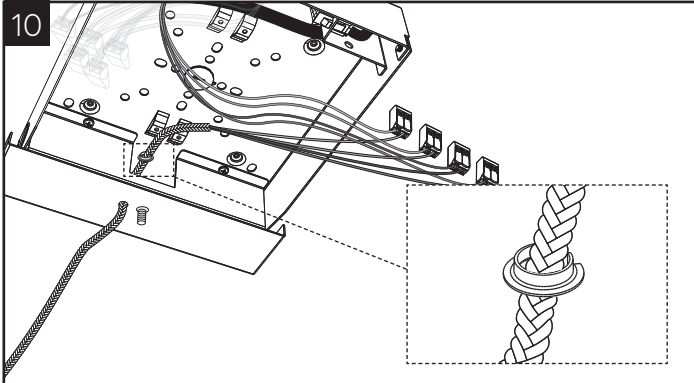

Secure braided fixture cord with cord-crimp provided. Cinch tight with pliers.

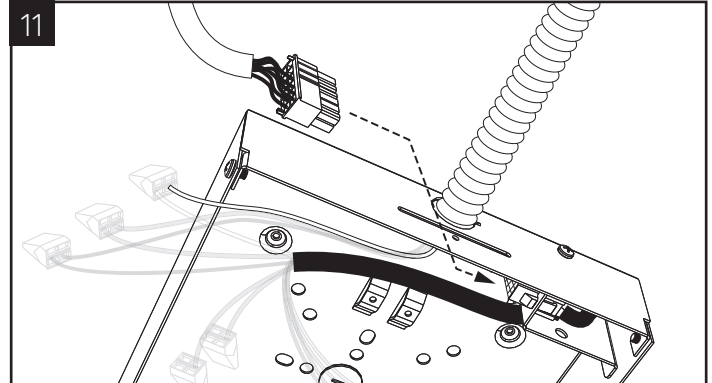

Reconnect the wiring harness from the drivers on the wiring box cover.

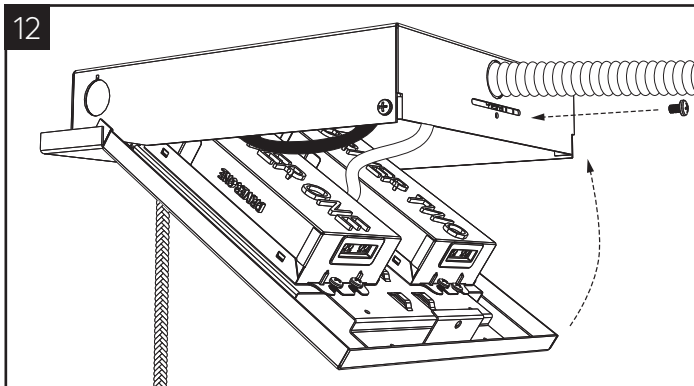

Tuck all wires into the wiring box and re-attach the cover by reversing steps 1 & 2.

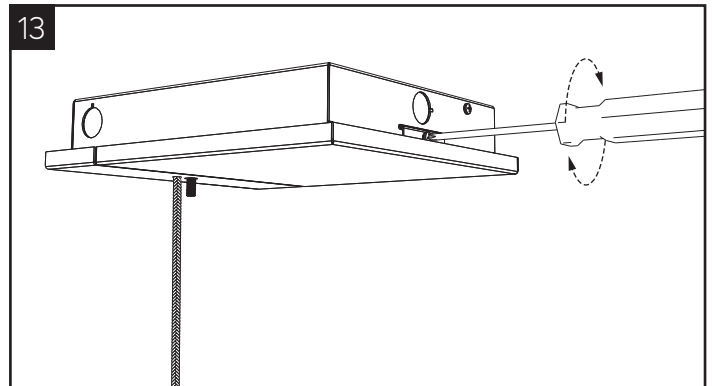

Tighten security screw with screwdriver.

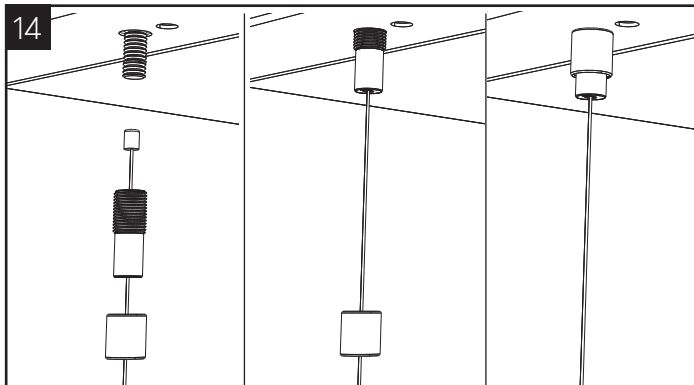

(A) Thread outer and inner coupler onto aircraft cable. (B) Align cable assembly with threaded stem and thread coupler onto threaded stem. (C) Thread outer coupler to inner coupler.

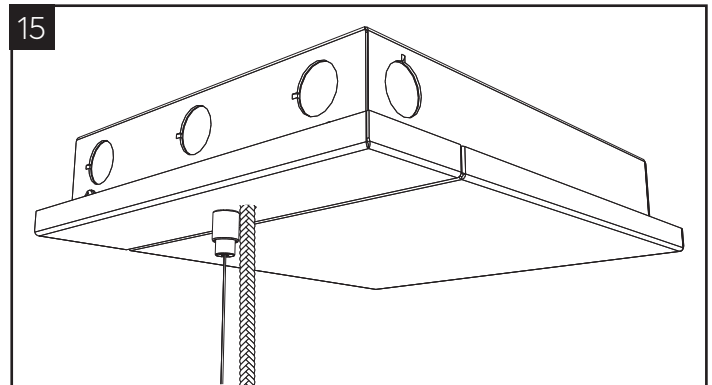

Wiring box installation is complete.

INSTALLING AN INDIVIDUAL OR ROWSTARTER LUMINAIRE

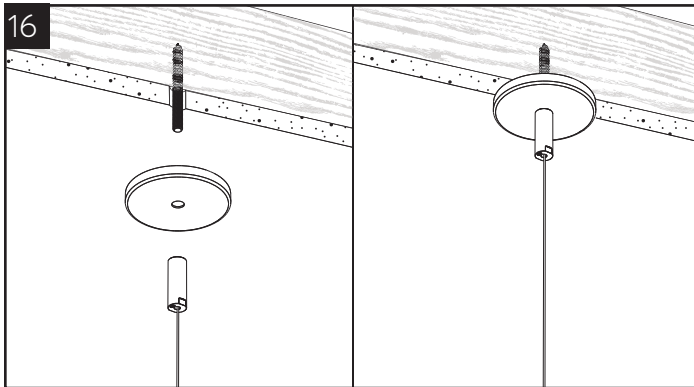

16
Screw threaded coupler and non-power canopy onto mounting stem to physically hang luminaire

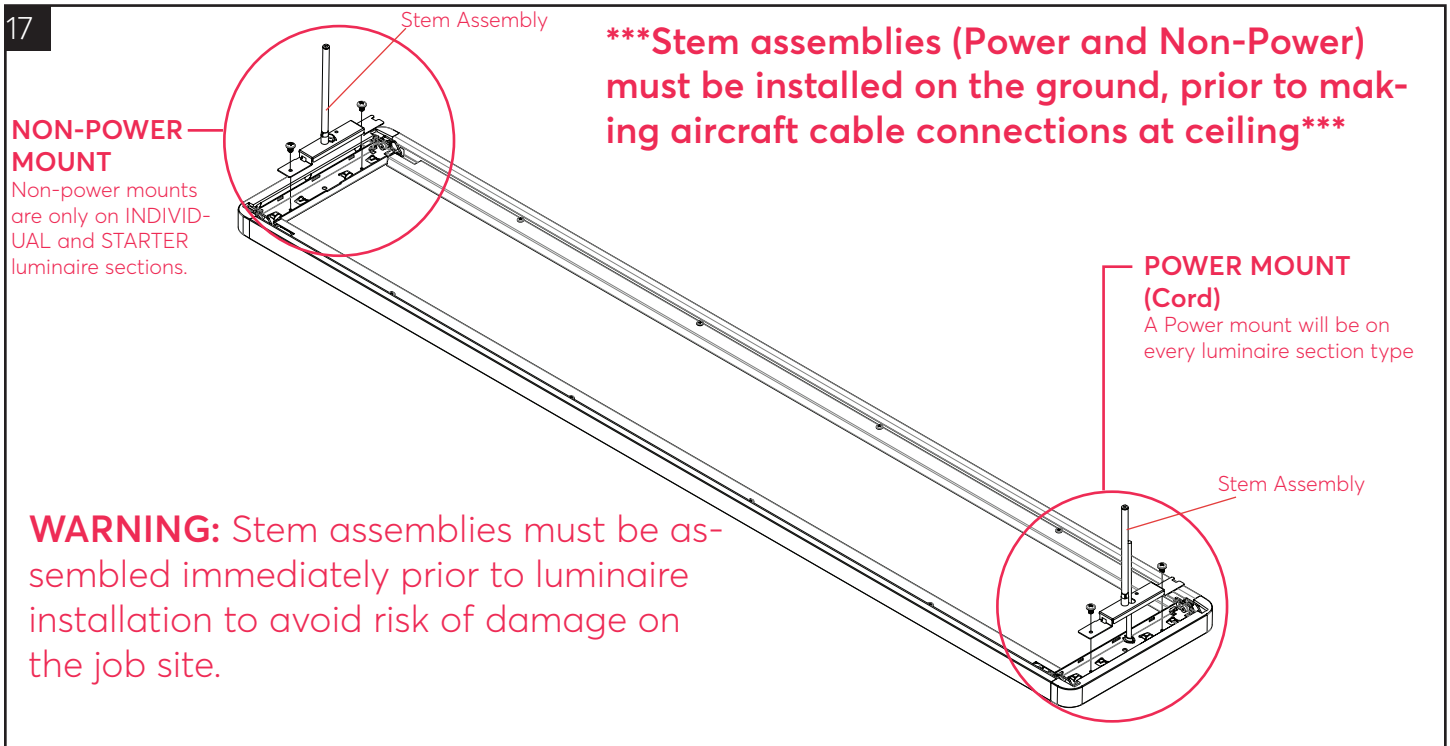

INSTALLING AN INDIVIDUAL OR ROWSTARTER LUMINAIRE

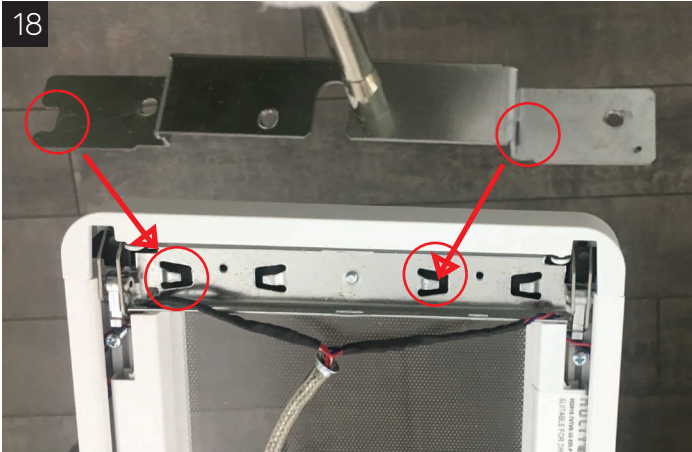

Make sure Stem assembly is aligned properly to tab features on luminaire

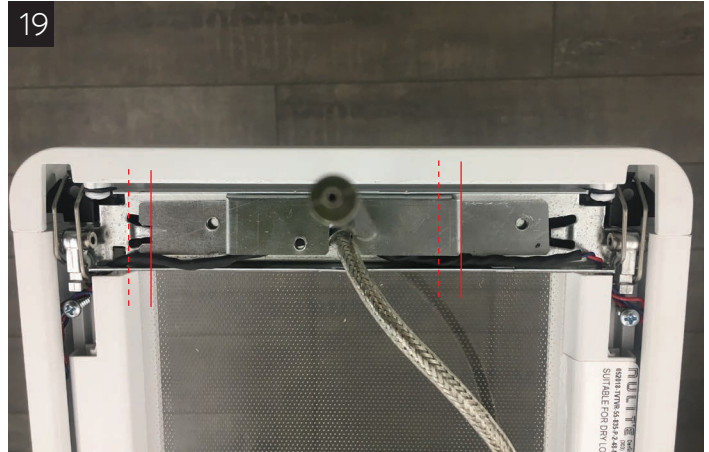

Drop stem assembly into place as shown, for power mounts make sure wires are managed as indicated on image.

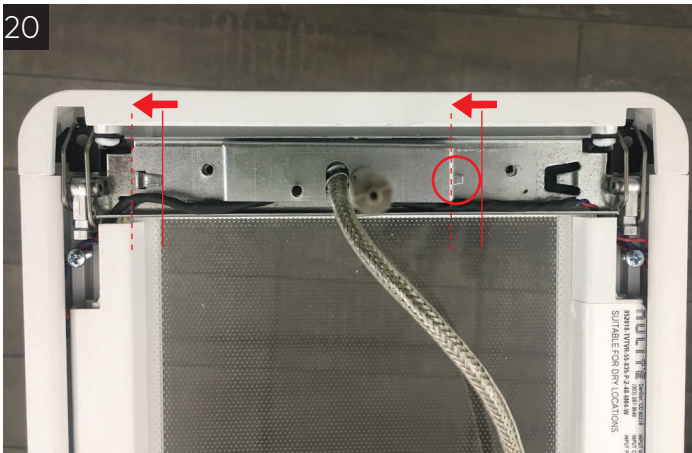

Push stem assembly laterally as shown until tabs engage



You may have to slightly bend tabs upward with a flat head screw driver to allow for full engagement

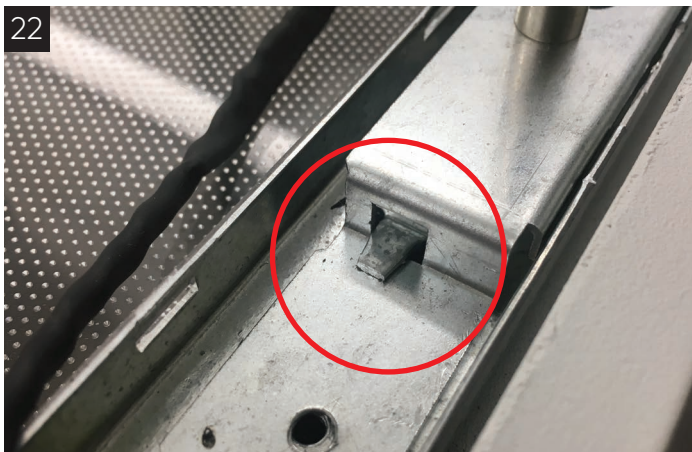

When tabs are properly engaged the tabs should appear as indicated in image

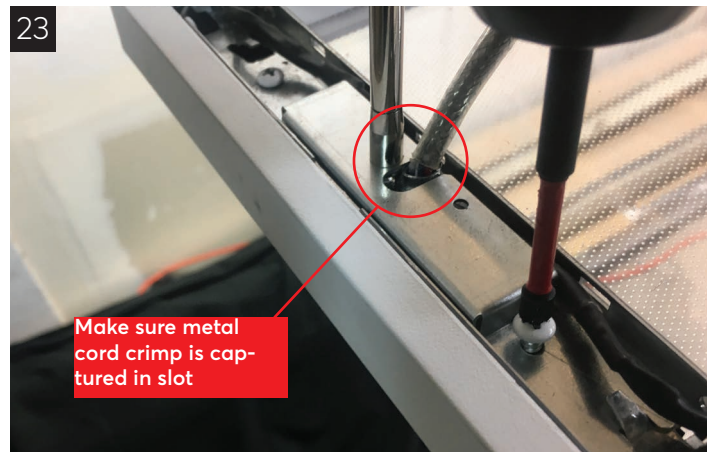

Attach stem assembly with two white screws, make sure wires are routed as shown, and metal cord crimp is captured in slot

INSTALLING AN INDIVIDUAL OR ROWSTARTER LUMINAIRE



Thread aircraft cable through cover.



Install aircraft cable into the top of stem by simply pressing into stem plunger.



If necessary push cable through cable exit... level luminaire.. then trim excess.

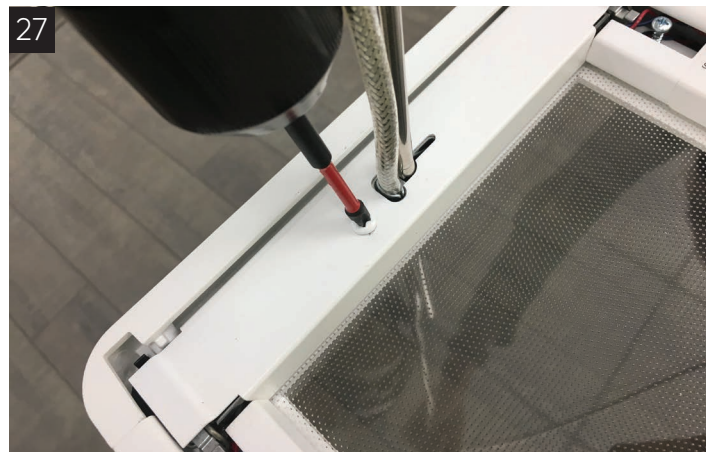

Final step, drop cover into place and attach white screw

JOINING FIXTURES



After the "Row Mid" or "Row End" has been suspended at the far end, connect the luminaire to the "Row Starter" by sliding the luminaires together and then using the spring latch to securely make the final connection.