

SOTTILE
L2D2 / L2D4 Architectural Troffer

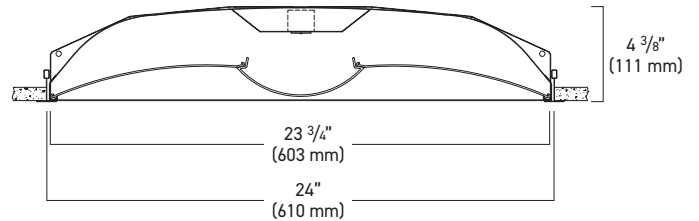

- Architectural troffer that provides soft, high ambient lighting for open and private offices, classrooms, and general purpose rooms.
- Standard housing and flange are constructed of die formed cold rolled steel housing. Housing finish is white baked enamel.
- Long-life distributed LED array in a variety of lumen output packages. LED color is available in 3000K, 3500K or 4000K with a CRI of 80 or 90. Custom outputs are available. L90>100,000 hours.
- Standard constant current electronic drive with 0-10V dimming inputs; dimming range from 100% down to 1%. Dims to 0% and DALI are available.
- Extruded 3-piece smooth frosted acrylic diffuser.

L2D2 (Round Lens)
 100% Downlight

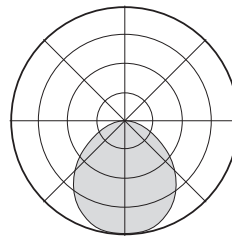

2'x2'

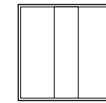

Length 23 3/4"
 Width 23 3/4"
 Depth 4 3/8"

2'x4'

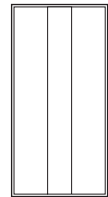

Length 47 3/4"
 Width 23 3/4"
 Depth 4 3/8"

ORDERING INFORMATION

SAMPLE NUMBER: L2D2-R-30L35-U-D-W

L2D					
SERIES	SIZE	LUMEN PACKAGE ¹		CRI/CCT	BATTERY OPTIONS ³
L2D - Sottile 2' width recessed grid	2 - 2' x 2' 4 - 2' x 4'	<u>2' x 2'</u> 20 - 2000 LM 20HP - 2000 LM 30 - 3000 LM 30HP - 3000 LM 40 - 4000 LM XX ²	<u>2' x 4'</u> 30 - 3000 LM 30HP - 3000 LM 40 - 4000 LM 40HP - 4000 LM 50 - 5000 LM 50HP - 5000 LM 60 - 6000 LM 70 - 7000 LM XX ²	L30 - 80 CRI, 3000K L35 - 80 CRI, 3500K L40 - 80 CRI, 4000K L50 - 80 CRI, 5000K H30 - 90 CRI, 3000K H35 - 90 CRI, 3500K H40 - 90 CRI, 4000K	B5 - 5W Battery Pack B7 - 7W Battery Pack B10 - 10W Battery Pack B12 ⁴ - 12W Battery Pack CEC - CEC Compliant (10W Battery Pack)

Notes:
 1. Nominal lumen output for 3500K, 80 CRI
 2. Consult factory for custom lumen package
 3. 2x2 will require additional housing that increases height of fixture by -2".
 4. 12W battery will be remote with 2x2' fixture
 5. Consult factory for specifications and custom dimming options. See page 2 for additional information
 6. Consult factory for additional options
 7. Specify 1 - 120 volt or 2 - 277 volt

VOLTAGE	DRIVER ⁵		W	LUMINAIRE FINISH	MOUNTING OPTIONS	OPTIONS ⁶
U - Universal 1 - 120 Volt 2 - 277 Volt	Dimming 0-10V D - Dims to 1% (Standard) D0 - Dims to 1%, fade to off D02 - Eldoled Solodrive, dims to 0%	DALI Dimming ELE - Eldoled Ecodrive, dims to 1% ELS - Eldoled Solodrive, dims to 0% Lutron Dimming L11 - Lutron HiLume™ Premier, dims to 0.1% L12 - Lutron HiLume™ 2-Wire 120V Forward Phase, dims to 1% L15 - Lutron HiLume™ H-Series, dims to 1% L16 - Lutron HiLume™ 5-Series, dims to 5%	W - White (Standard)	W - White (Standard)	FLG - Flange	RPO - Round perforated overlay center diffuser CP - Chicago plenum SIC - Seismic clips 20PAF - 20 ga. CRS / paint after Fabrication GLR - Fusing FLEX3 - 6' of Flex, 3-wire FLEX5 - 6' of Flex, 5-wire ETS ⁷ - Electronic transfer switch GTD ⁷ - Generator transfer device UP - Unit pack

PHOTOMETRICS

L2D2

Cat # L2D2-30L35-U-D-W
 ITL Test #: 84432
 Total Delivered Lumens: 2599
 Input Watts: 23.8
 Efficacy: 109 lm/W
 100% Downlight

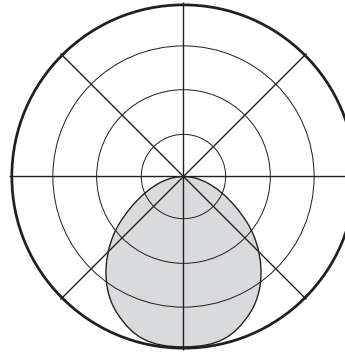

Luminance Data (CD/SQ.M)

Angle in Degrees	Average 0-Deg	Average 45-Deg	Average 90-Deg
45	1136	1245	1300
55	1010	1178	1231
65	862	1083	1120
75	694	1022	1049
85	517	1065	746

Zonal Lumen Summary

Zone	Lumens	%Fixt
0-30	716	28
0-40	1173	45
0-60	2054	79
0-90	2599	100
0-180	2599	100

LIGHTING CONTROL

Nulite provides flexibility in meeting the needs of each project by easily integrating with several manufacturers for lighting control options.

0-10V: A non-directional dimming system. The control system tells the LED driver what to do and it adjusts according to the voltage on the control circuit.

DALI: Digital Addressable Lighting Interface is a simple two-wire control connection that goes to each fixture to form the control network. It allows LED drivers to be controlled independently from lighting control circuits.

Solution	Manufacturer	Prefix	Series	Dim Level	Quantity of Wires	Dim to Dark (Smooth)	Fade to Off
Dimming 0-10V							
D	Variable			1%	2		
D0	Variable			0%	2		X
D02	eldoLed		SOLOdrive	0%	2	X	
DALI Dimming							
ELE	eldoLed		ECOdrive	1%	2	X	
ELS	eldoLed		SOLOdrive	0%	2	X	
Lutron Dimming							
L11*	Lutron	PEQ	Hi-Lume Premier	0.1%	2	X	
L12	Lutron	LTEA	Hi-lume™ 2-Wire 120V forward phase	1%	No Control Wires - Uses Hot		
L15	Lutron	LDE1	Hi-lume™ - H Series	1%	2	X	
L16	Lutron	LDE5	5-Series	5%	2		

*Maximum lumen package is 20 and 20HP

LIGHT OUTPUT AND ENERGY CONSUMPTION*

2x2			
Lumen Package	Input Watts	Output Lumens	Efficacy
20 (2000)	15.9	1880	118
20HP** (2000)	15.9	2085	131
30 (3000)	23.8	2599	109
30HP** (3000)	23.8	2951	124
40* (4000)	31.7	3743	118

*Lumen output may vary. 3500K utilized for above results. Multiply output by 95.3% for 3000K and 102.6% for 4000K @ 80CRI

**Based on 2-board cross section

2x4			
Lumen Package	Input Watts	Output Lumens	Efficacy
30 (3000)	23.8	3045	128
30HP** (3000)	23.8	3387	132
40 (4000)	31.7	3858	122
40HP** (4000)	31.7	4282	135
50 (5000)	39.6	4608	116
50HP** (5000)	39.6	5182	131
60** (6000)	47.6	6085	128
70	55.4	6912	125

INSTALLATION DETAILS

GRID CEILING

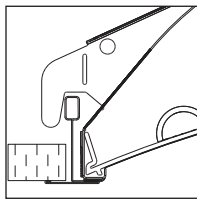

1" Tee Grid

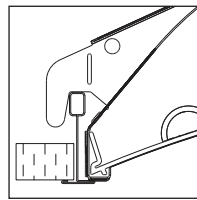

9/16" Tee Grid

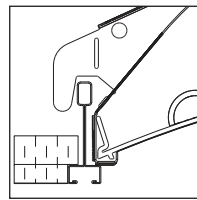

Screw Slot Grid

Sottile universal flange detail accomodates all typical grid types

INACCESSIBLE CEILINGS

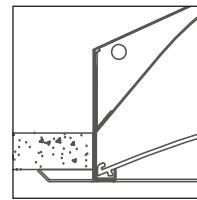

FLG - Inaccessible ceiling option (Sheet Rock typical)

Special inaccessible luminaire body is fully assembled at the factory. Overall length and width dimensions are larger than standard grid luminaires. Refer to installation instructions for sheet rock cut-out guidelines.

-2x2 > 25 13/16" x 25 13/16"

-2x4 > 25 13/16" x 49 13/16"

INTEGRAL BATTERY PACK DIMENSIONS

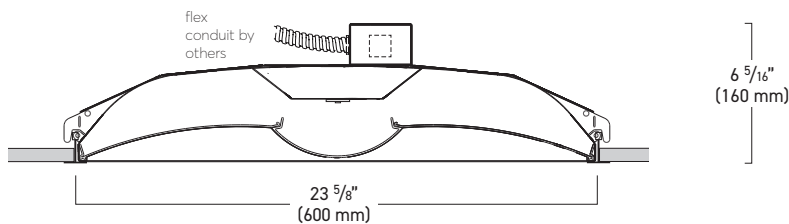

*2x2 with battery

PRODUCT DETAILS

LIGHT SOURCE LED custom linear array is mounted with quick-connect wiring to facilitate service. A wide array of lumen packages are available. All luminaire configurations tested in accordance with IESNA LM-79. Diodes tested in accordance with IESNA LM-80.

DRIVER Standard constant electronic driver with 0-10V dimming input standard; dimming range from 100% down to 1%. Dims to 0% and DALI available. Universal (U), 120 volt (1) and 277 volt (2).

OPTIONAL DALI Digital Addressable Lighting Interface is a simple two-wire control connection that goes to each fixture to form a the control network. DALI enables dimmable transformers, relay modules, emergency fittings, and controllers from different manufacturers to be mixed and matched into a single control system, allowing LED drivers to be controlled independently from lighting control circuits.

OPTIONAL BATTERY AND EMERGENCY OPTIONS Recyclable Ni-Cad battery pack, battery run time is 90 minutes. 5W, 7W, 10W or 12W battery packs are available. Total output is determined by exact efficacy of specified configuration multiplied by battery wattage (i.e. L2D2-R-30L35-U-D-W with a 10W battery pack is a 1,090 battery lumen output). 2x2 with battery pack adds additional ~2" to height of fixture. Recharge time of 24 hours.

MOUNTING Designed to install into grid (T1, T9 or TS clips). Optional inaccessible ceiling types, IC rated. Refer to installation instructions for appropriate ceiling details.

WARRANTY 5-year limited warranty on LED and driver from date of shipment. Refer to the full warranty details on www.nulite-lighting.com.

WEIGHT 2x2 - ~20 lbs., 2x4 - ~24 lbs.

APPROVALS ETL listed, conforms to UL Standard 1598 / 8750 and CSA Standard C22.2, indoor dry/damp locations.

INDEPENDENT TESTING

IESNA LM79 - Testing method for the Electrical and Photometric Measurements of Solid State Lighting on the complete system, such as luminous flux, electrical power, luminous intensity distribution, and various properties of chromaticity.

IESNA LM80 - Testing method for measuring lumen maintenance of LED light sources, applies to the LED package, array or module alone, not the complete system.