

SOTTILE L1D4

Architectural Troffer

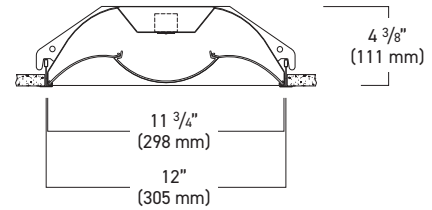

- Architectural troffer that provides soft, high performance ambient lighting for open and private offices, classrooms, and general purpose rooms.
- Standard housing is die formed cold rolled steel housing. Flange is constructed of 20-gauge cold-rolled steel. Housing finish is white baked enamel.
- Long-life distributed LED array in a variety of lumen output packages. LED color is available in 3000K, 3500K or 4000K with a CRI of 80 or 90. Custom outputs are available. L90>100,000 hours.
- Standard constant current electronic driver with 0-10V dimming inputs; dimming range from 100% down to 1%. Dims to 0% and DALI are available.
- Extruded 3-piece smooth frosted acrylic diffuser.

L1D4

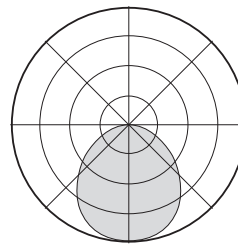

1'x4'

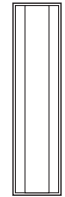

Length 47 3/4"
Width 11 3/4"
Depth 4 3/8"

ORDERING INFORMATION

SAMPLE NUMBER: L1D4-30L35-U-D-W

L1D	4			
SERIES	SIZE	LUMEN PACKAGE ¹	CRI/CCT	BATTERY OPTIONS ³
L1D - Sottile 1' width recessed grid	4 - 1' x 4'	1' x 4' 30 - 3000 LM 30HP - 3000 LM 40 - 4000 LM 40HP - 4000 LM 50 - 5000 LM 50HP - 5000 LM 60 - 6000 LM 70 - 7000 LM XX ²	L30 - 80 CRI, 3000K L35 - 80 CRI, 3500K L40 - 80 CRI, 4000K L50 - 80 CRI, 5000K H30 - 90 CRI, 3000K H35 - 90 CRI, 3500K H40 - 90 CRI, 4000K	B5 - 5W Battery Pack B7 - 7W Battery Pack B10 - 10W Battery Pack B12 - 12W Battery Pack CEC - CEC Compliant (10W Battery Pack)

Notes:
 1. Nominal lumen output for 3500K, 80 CRI
 2. Consult factory for custom lumen package
 3. Consult factory for additional options
 4. Consult factory for specifications and custom dimming options. See page 2 for additional information
 5. Specify 1 - 120 volt or 2 - 277 volt

VOLTAGE	DRIVER ⁴		W	MOUNTING OPTIONS	OPTIONS ³
			LUMINAIRE FINISH		
U - Universal 1 - 120 Volt 2 - 277 Volt	Dimming 0-10V D - Dims to 1% (Standard) DO - Dims to 1%, fade to off DO2 - Eldoled Solodrive, dims to 0%	DALI Dimming ELE - Eldoled Ecodrive, dims to 1% ELS - Eldoled Solodrive, dims to 0% Lutron Dimming L12 - Lutron HiLume™ 2-Wire 120V Forward Phase, dims to 1% L15 - Lutron HiLume™ H-Series, dims to 1% L16 - Lutron HiLume™ 5-Series, dims to 5%	W - White (Standard)	FLG - Flange	RPO - Round perforated overlay center diffuser CP - Chicago plenum SIC - Seismic clips 20PAF - 20 ga. CRS / paint after Fabrication GLR - Fusing FLEX3 - 6' of Flex, 3-wire FLEX5 - 6' of Flex, 5-wire GTD ⁵ - Generator transfer device ETS ⁵ - Electronic transfer switch UP - Unit pack

PHOTOMETRICS

L1D4

Cat # L1D4-R-30L35-U-D-W
 ITL Test #: ITL 84432
 Total Delivered Lumens: 2980
 Input Watts: 23.8
 Efficacy: 125 lm/W
 100% Downlight

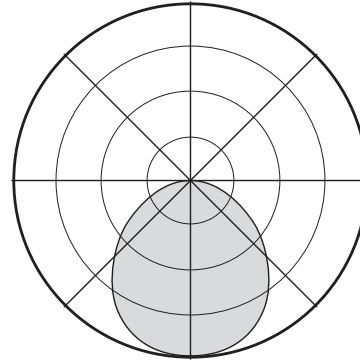

Luminance Data (CD/SQ.M)

Angle in Degrees	Average 0-Deg	Average 45-Deg	Average 90-Deg
45	2496	2736	2857
55	2220	2589	2705
65	1894	2381	2462
75	1524	2246	2305
85	1137	2340	1640

Zonal Lumen Summary

Zone	Lumens	%Fixt
0-30	821	28
0-40	1345	45
0-60	2355	79
0-90	2980	100
0-180	2980	100

LIGHTING CONTROL

Nulite provides flexibility in meeting the needs of each project by easily integrating with several manufacturers for lighting control options.

0-10V: A non-directional dimming system. The control system tells the LED driver what to do and it adjusts according to the voltage on the control circuit.

DALI: Digital Addressable Lighting Interface is a simple two-wire control connection that goes to each fixture to form the control network. It allows LED drivers to be controlled independently from lighting control circuits.

Solution	Manufacturer	Prefix	Series	Dim Level	Quantity of Wires	Dim to Dark (Smooth)	Fade to Off
Dimming 0-10V							
D	Variable			1%	2		
D0	Variable			1%	2		X
D02	eldoLed		SOLOdrive	0%	2	X	
DALI Dimming							
ELE	eldoLed		ECOdrive	1%	2	X	
ELS	eldoLed		SOLOdrive	0%	2	X	
Lutron Dimming							
L12	Lutron	LTEA	Hi-lume™ 2-Wire 120V forward phase	1%	No Control Wires - Uses Hot		
L15	Lutron	LDE1	Hi-lume™ - H Series	1%	2	X	
L16	Lutron	LDE5	5-Series	5%	2		

LIGHT OUTPUT AND ENERGY CONSUMPTION*

1x4			
Lumen Package	Input Watts	Output Lumens	Efficacy
30 (3000)	23.8	2980	125
30HP** (3000)	23.8	3323	140
40 (4000)	31.7	3781	119
40HP** (4000)	31.7	4197	132
50 (5000)	39.6	4514	114
50HP** (5000)	39.6	5079	128
60** (6000)	47.6	5965	125
70 **	55.4	6775	122

*Lumen output may vary. 3500K utilized for above results. Multiply output by 95.3% for 3000K and 102.6% for 4000K @ 80CRI

**Based on 2-board cross section

INSTALLATION DETAILS

GRID CEILING

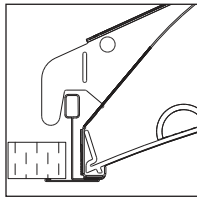

1" Tee Grid

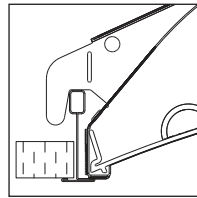

9/16" Tee Grid

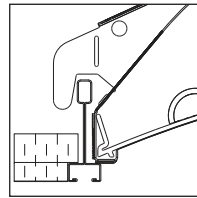

Screw Slot Grid

Sottile universal flange detail accomodates all typical grid types

INACCESSIBLE CEILINGS

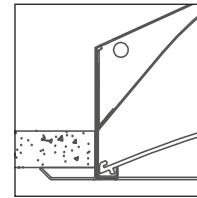

FLG - Inaccessible ceiling option (Sheet Rock typical)

Special inaccessible luminaire body is fully assembled at the factory. Overall length and width dimensions are larger than standard grid luminaires. Refer to installation instructions for sheet rock cut-out guidelines.

-1x4 > W 13 13/16" x L 49 13/16"

PRODUCT DETAILS

LIGHT SOURCE LED custom linear array is mounted with quick-connect wiring to facilitate service. A wide array of lumen packages are available. All luminaire configurations tested in accordance with IESNA LM-79. Diodes tested in accordance with IESNA LM-80.

DRIVER Standard constant electronic driver with 0-10V dimming input standard; dimming range from 100% down to 1%. Dims to 0% and DALI available. Universal (U), 120 volt (1) and 277 volt (2).

OPTIONAL DALI Digital Addressable Lighting Interface is a simple two-wire control connection that goes to each fixture to form a the control network. DALI enables dimmable transformers, relay modules, emergency fittings, and controllers from different manufacturers to be mixed and matched into a single control system, allowing LED drivers to be controlled independently from lighting control circuits.

OPTIONAL BATTERY AND EMERGENCY OPTIONS Recyclable Ni-Cad battery pack, battery run time is 90 minutes. 5W, 7W, 10W or 12W battery packs are available. Total output is determined by exact efficacy of specified configuration multiplied by battery wattage (i.e. L1D4-R-30L35-U-D-W with a 10W battery pack is a 1,250 battery lumen output). Recharge time of 24 hours.

MOUNTING Designed to install into grid (T1, T9 or TS clips). Optional inaccessible ceiling types, IC rated. Refer to installation instructions for appropriate ceiling details.

WARRANTY 5-year limited warranty on LED and driver from date of shipment. Refer to the full warranty details on www.nulite-lighting.com.

WEIGHT ~20 lbs.

APPROVALS ETL listed, conforms to UL Standard 1598 / 8750 and CSA Standard C22.2, indoor dry/damp locations.

INDEPENDENT TESTING

IESNA LM79 - Testing method for the Electrical and Photometric Measurements of Solid State Lighting on the complete system, such as luminous flux, electrical power, luminous intensity distribution, and various properties of chromaticity.

IESNA LM80 - Testing method for measuring lumen maintenance of LED light sources, applies to the LED package, array or module alone, not the complete system.