

Type:	Project:	Qty:
	Date:	
Catalog #:		

Description:

The Nulite Regolo RW6 wall series is a nominal 6" wide, profile unit. This product is ideal for corridors, open and private offices, classrooms, lobbies and general purpose rooms.

Specifications:

Construction: The housing consists of visible extruded aluminum side rails with formed cold rolled steel support channel, heavy gauge end caps and wall mounting plates. Housing is finished with electrostatically applied powder coat paint.

Reflector / Ballast: Reflector / ballast cover is finished with high reflectance white paint. Standard electronic, Class P, ballast. Universal (UNV) voltage ballast is from 120 - 277V.

Shielding: Bottom extruded frosted acrylic or satin white acrylic snap-in lens with DR; semi-specular cross blade baffle.

Lamping: Non-staggered 1, 2 or 3 lamp cross-section T5, T5HO or T8; Non-staggered 3, 4 or 5 lamp available for Bidirectional. Luminaire can be ordered with lamps, consult factory.

Mounting: Wall mount, individual mount or continuous runs.

Labels: UL / cUL listed Damp location.

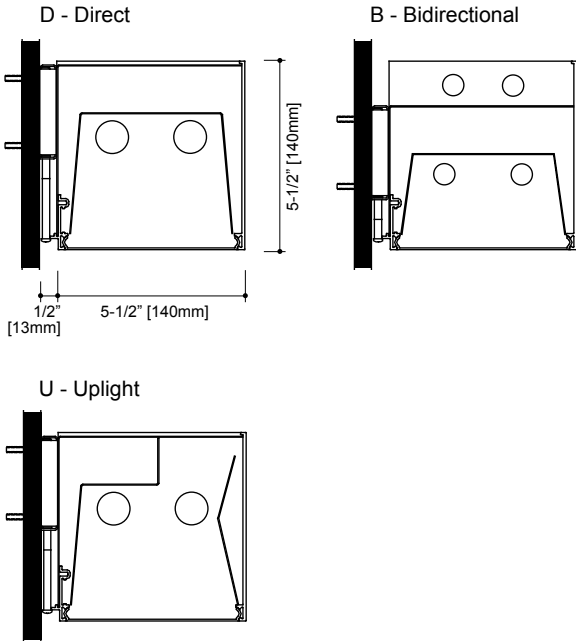

Ordering Information

Sample: RW6-6D-2T8-N-UNV-ISN-1C-FRF-WH-20'

Series	Height / Distribution	Lamp	Staggered	Voltage	Ballast	Circuit	Shielding	Color	Length	Options	
RW6			N								
RW6 (Wall - Nom. 6")	6	D ¹ Direct B ¹ Bidirectional U ¹ Uplight	N (Non-Staggered)	UNV 120 277 347 ²	T8 Options IS (Standard) Instant Start PS Program Start HEIS High Efficiency Instant Start HEPS High Efficiency Program Start T5/T5HO PS (Standard) Program Start HEPS ² High Efficiency Program Start All Lamp Dimming Options DIM ² Dimming SD ² Step Dimming	Ballast Factor N Normal (Standard) L Low H High	1C Single Circuit 1E Single Circuit w/ EM Circuit 1B ³ Single Circuit w/ Battery Pack 2C Dual Circuit 2E Dual Circuit w/ EM Circuit 2B ³ Dual Circuit w/ Battery Pack	FRF (Frosted Flush) STF (Satin White Flush) SBB (Flush Semi-spec Blade) Consult factory for upright shielding or dust cover	WH (White) BK (Black) SV (Silver) CC (Custom Color)	2' 3' 4' 5' 6' 7' 8' Continuous Runs XX' Specify run length in 1 foot increments. Consult factory for custom lengths.	GLR Fusing

Notes:

1. Direct and Uplight available in 1, 2 or 3 lamp. Bidirectional is available in 2 (1 up/1 dwn), 3 (1 up/2 dwn), 3X (2 up/1 dwn), 4 (2 up/2 dwn) or 5 (2 up/3 dwn) lamp cross-sections.
2. Consult factory for availability.
3. Specific voltage must be ordered for this option. Not all options are available, consult factory.

Specifications and dimensions are subject to change without notification. Specification sheets on our website supersede all other versions. 2015 Rev. D Nulite reserves the right to bulk package any order.

Lens Options



Frosted Lens
 This diffuser is designed for a balance between efficiency and lens uniformity. (Transmission ~ 89%)

Satin White Lens
 This diffuser is designed for visible lens uniformity. It's recommended for regressed lens configuration in our shallow housing. (Transmission ~ 69%)

Wall Mounting Plate Detail

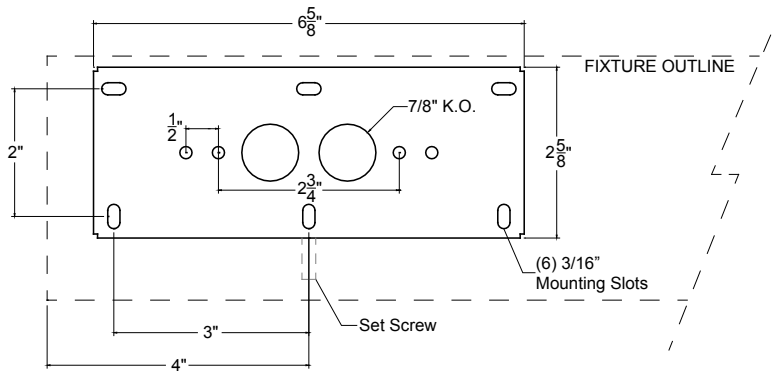

Individual Lengths

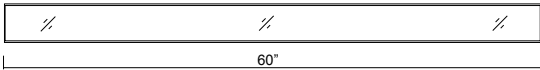
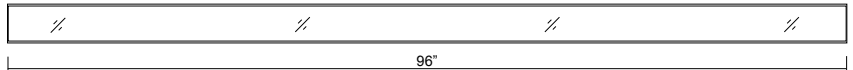
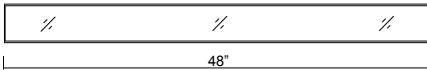
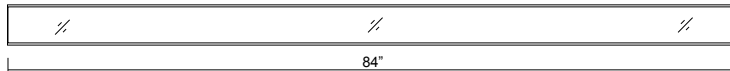
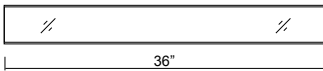
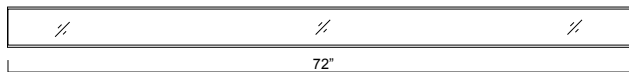
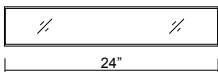

Add 3/32" per end cap to the length.

Specifications and dimensions are subject to change without notification.

Non-Staggered Run Length (A = Stand Alone Housing, S = Starter Housing, M = Mid Housing, E = End Housing)

	2	3	4	5	6	7	8	9	10	11	12	13	14	15	16	17	18	19	20	21	22	23	24	25	26	27	28	29	30	31	32	33	34	35	36	37	38	39	40		
24A	1																																								
36A		1																																							
48A			1																																						
60A				1																																					
72A					1																																				
84A						1																																			
96A							1																																		
72S								1	1							1	1									1	1						1	1							
96S										1	1	1	1	1	1				1	1	1	1	1	1			1	1	1	1	1	1			1	1	1	1	1	1	
96M																1	1	1	1	1	1	1	1	1	2	2	2	2	2	2	2	2	3	3	3	3	3	3	3	3	
36E								1		1						1		1							1		1						1		1						
48E									1		1						1		1							1		1						1		1					
60E												1								1									1									1			
72E													1								1									1									1		
84E														1									1								1									1	
96E															1									1								1								1	

Shaded columns require all 4' lamps.

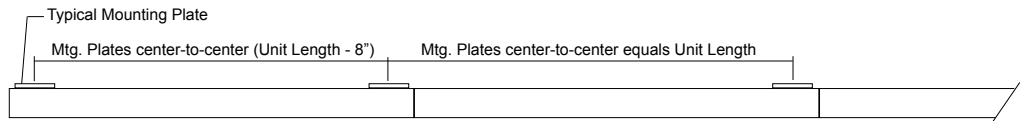

Photometric Curves

Cat. # RW6-6D-2T5-...-FRF-...-4'
Frosted Flush Lens
Initial lamp lumens - 5200

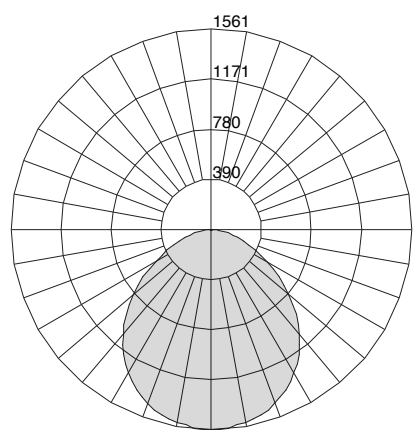

Cat. # RW6-6D-2T8-...-FRF-...-4'
Frosted Flush Lens
Initial lamp lumens - 5600

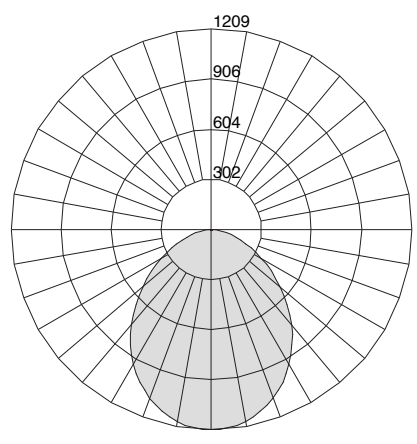

Cat. # RW6-6D-2T8-...-SBB-...-4'
Specular Blade Baffle
Initial lamp lumens - 5600

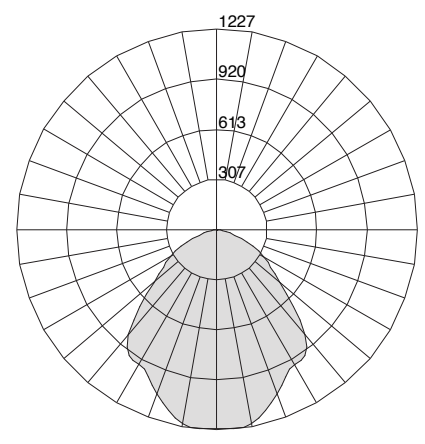

Specifications and dimensions are subject to change without notification.