

Type:	Project:	Qty:
	Date:	
Catalog #:		

Description:

The Regolo RT4 series is a nominal 4" wide recessed trimless LED luminaire. The slender design is ideal for corridors, open and private offices, classrooms, lobbies and general purpose rooms.

Specifications:

Construction: The housing consists of extruded aluminum side rails with formed cold rolled steel back channel and heavy gauge end caps. Standard finish is powder coat textured white. Optional silver, black or custom color paint finishes.

Reflector / Driver: Reflector / driver cover is finished with high reflectance white paint. Optional asymmetric semi-specular aluminum reflector. Standard constant current electronic driver with 0-10V dimming input; dimming range from 100% down to 1%. Universal (UNV) voltage is from 120 - 277V, 50/60 Hz.

Shielding: Extruded frosted or satin white acrylic snap-in lens with DR.

LED Module: Distributed LED array in a variety of lumen output packages. LED color is available in 3000K, 3500K or 4000K and in 80CRI or 90CRI. Module is replaceable. L90 ≥ 100,000 hrs.

Mounting: Recessed, individual or continuous row. Non-IC rated.

Labels: ETL listed, conforms to UL Standard 1598 / 8750 and CSA Standard C22.2, Damp location.

Warranty: 5-year limited warranty on LED and Driver.

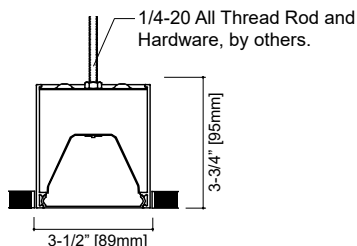

Drop Lens Option

ASYM Option

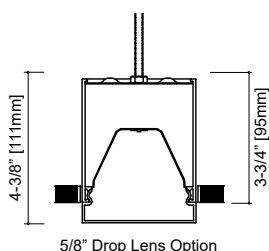

5/8" Drop Lens Option

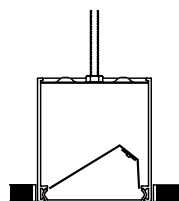

Ordering Information

Sample: RT4-05L35-UNV-ELE-1C-FRF-WH-20'

Series	Lumen Package ¹ / Color	Voltage	Driver	Circuit	Shielding	Color	Length	Options	
RT4									
RT4 (Trimless - Nom. 4")	03 (~390 lm/ft, 3.28W/ft)	UNV	Dimming (0-10V)	1C Single Circuit	FRF (Frosted Flush)	WH (White - Standard) BK (Black) SV (Silver) CC (Custom Color)	2'	OS ⁵ End of run Occupancy Sensor DS ⁵ End of run Daylight Sensor FLEX ⁶ 6' of Flex ASYM ⁵ Asymmetric Reflector GLR Fusing See Accessories for Corners and Downlight Modules	
	05 (~569 lm/ft, 4.85W/ft)			1E Single Circuit w/ EM Circuit	FRD (Frosted Drop Opaque End)		3'		
	06 (~724 lm/ft, 6.38W/ft)			1B Single Circuit w/ Battery Pack	FRL (Frosted Drop Luminous End)		4'		
	09 (~899 lm/ft, 7.79W/ft)	277	Lutron Dimming	CEC	STF (Satin White Flush)		5'		
	10 (~1036 lm/ft, 9.39W/ft)			See Page 2 for Ordering Codes	STD (Satin White Drop Opaque End)		6'		
				DALI Dimming	STL (Satin White Drop Luminous End)		7'		
				eldoLED ECOdrive			8'		Continuous Runs ⁴ XX: Specify run length in 1 foot increments. Consult factory for custom lengths.
				ELE (Dim to 1%)					
				eldoLED SOLOdrive					
				ELS (Dim to 0%)					

Notes:

- Nominal lumen output per foot w/ frosted lens and 3500K.
- Standard driver, don't connect low-voltage wires for non-dimming applications. Consult factory for specifications and manufacturer.
- Consult factory for specifications and manufacturer.
- 6" increments are common custom lengths. We can provide custom run length down to the nearest (+/- 1/8").
- Only available with Frosted Flush lens.



Specifications and dimensions are subject to change without notification. Specification sheets on our website supersede all other versions. 2019 Rev. E1 Nulite reserves the right to bulk package any order.

Lens Options

Shielding

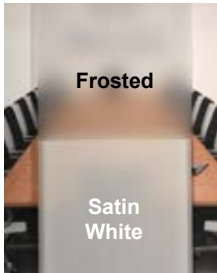

Frosted Lens

This diffuser is designed for a balance between efficiency and lens uniformity. (Transmission ~ 89%)

Satin White Lens

This diffuser is designed for visible lens uniformity. It's recommended for regressed lens configuration in our shallow housing. (Transmission ~ 69%)



Drop Lens w/ Luminous End



Drop Lens w/ Opaque End

Lutron Driver Ordering Codes

Nulite Code	Lutron Prefix	Lutron Series	Dim Level	Quantity of Wires	Dim to Dark (Smooth)
L11*	PEQ	Hi-Lume™ Premiere	0.1%	2	X
L12	LTEA	Hi-Lume™ 2-Wire 120V forward phase	1%	No Control Wires - Uses Hot	
L15	LDE1	Hi-Lume™ H-Series	1%	2	X
L16	LDE5	Hi-Lume™ 5-Series	5%	2	

*Maximum lumen package with L11 is 05

Sensor Options



Occupancy and/or Daylight Sensor (Surface Mount Shown)

Back of Housing Mounting Holes & Power Feed KO

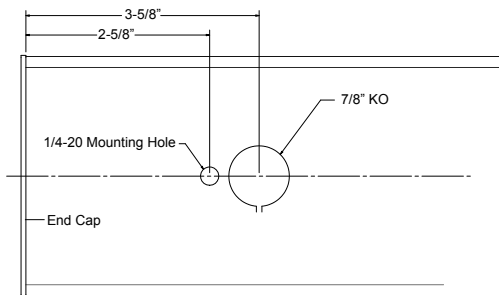

Typical End of Housing Detail

Individual Lengths

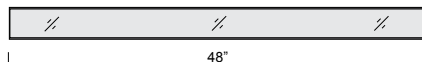
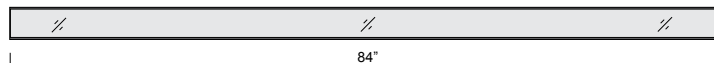
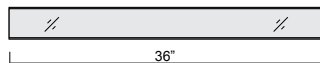
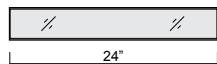

Continuous Run Lengths

		Run Length																																																	
		2'	3'	4'	5'	6'	7'	8'	9'	10'	11'	12'	13'	14'	15'	16'	17'	18'	19'	20'	21'	22'	23'	24'	25'	26'	27'	28'	29'	30'	31'	32'	33'	34'	35'	36'	37'	38'	39'	40'	41'	42'	43'	44'							
Number of Housings	2'	1																																																	
	3'		1																																																
	4'			1					1	1	1	1					1	1	1	1						1	1	1	1							1	1	1	1				1	1	1	1					
	5'				1				1				1				1					1				1				1					1				1					1							
	6'					1				1				1				1					1				1				1					1				1					1						
	7'						1				1				1				1					1				1				1					1				1					1					
	8'							1				1	1	1	1	1	2	1	1	1	1	2	2	2	2	3	2	2	2	3	3	3	3	3	4	3	3	3	3	4	4	4	4	5	4	4	4	4	5		

Photometric Curves

Cat. # RT4-05L35-...-FRF-...-4'
Frosted Flush Lens
Wattage/ft - 4.85
Lumens/Watt - 117

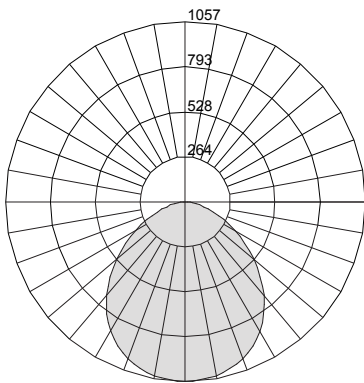

Cat. # RT4-09L35-...-FRF-...-4'
Frosted Flush Lens
Wattage/ft - 7.79
Lumens/Watt - 115

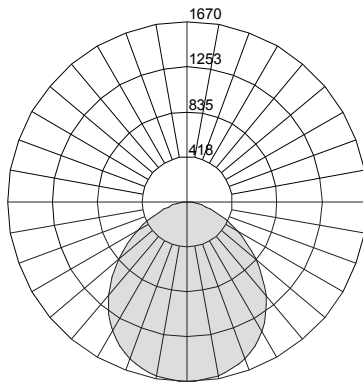

Cat. # RT4-05L40-...-FRF-...-4'-ASYM
Frosted Flush Lens
Wattage - 5.25
Lumens/Watt - 110

