

Type:	Project:	Qty:
	Date:	
Catalog #:		

Description:

The Regolo RM4 LED series is a recessed, nominal 4" wide profile, slot unit designed to be mud in for a trimless appearance. The product is ideal for illuminating corridors, open and private offices, classrooms, lobbies and general purpose rooms.

Specifications:

Construction: The housing consists of visible extruded aluminum mud ring trim rails with formed cold rolled steel back channel and heavy gauge end caps. Steel alignment tabs and white snap-in joiner clips are used for continuous row applications. Luminaire is finished textured white.

Reflector / Driver: Reflector / driver cover is finished with high reflectance white paint. Optional asymmetric semi-specular aluminum reflector. Standard constant current electronic driver with 0-10V dimming input; dimming range from 100% down to 1%. Universal (UNV) voltage is from 120 - 277V, 50/60 Hz.

Shielding: Extruded frosted acrylic or satin white acrylic snap-in lens with DR, flush or regressed.

LED Module: Distributed LED array in a variety of lumen output packages. LED color is available in 3000K, 3500K or 4000K and in 80CRI or 90CRI. Module is replaceable. L90 ≥ 100,000 hrs.

Mounting: Inaccessible ceiling types, mud ring for a trimless appearance. IC rated. Individual mount or continuous runs.

Labels: ETL listed, conforms to UL Standard 1598 and 8750, Damp location.

Warranty: 5-year limited warranty on LED and Driver.

Flush Lens

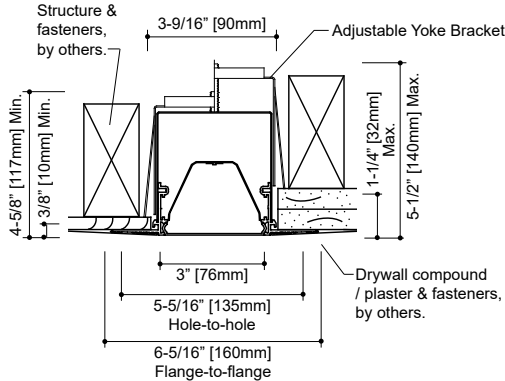

Regressed Lens

Drop Lens Option

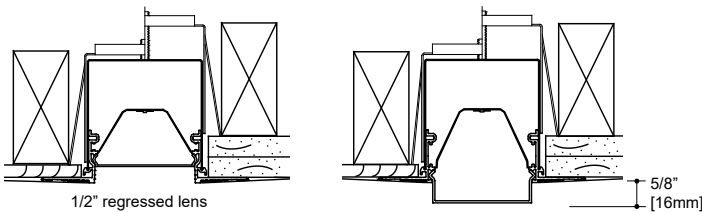

Ordering Information

Sample: RM4-10H35-UNV-L12-1C-FRL-WH-4'

Series	Lumen Package ² / Color	Voltage	Driver	Circuit	Shielding/Position	Color	Length	Options	
RM4 ¹						WH			
RM4 (Mud Ring - Nom. 4")	03 (~390 lm/ft, 3.28W/ft)	80CRI	UNV	Dimming (0-10V)	1C Single Circuit FR (Frosted) F (Flush lens) ST (Satin white) R ⁵ (Regressed lens) L (Luminous Acrylic End Drop lens) D (Opaque Metal End Drop lens)	WH (White - Mud Ring Standard)	2'	CP Chicago Plenum DSOS Combined Daylight & Occupancy Sensor FLEX 6' of Flex ASYM ⁸ Asymmetric Reflector (See Page 2) GLR Fusing SHW Shallow Wall See Accessories for Corners and Downlight Modules	
	05 (~568 lm/ft, 4.85W/ft)	L30	120	D ³ (Dim to 1%)			1E Single Circuit w/ EM Circuit		3'
	06 (~724 lm/ft, 6.38W/ft)	L35	277	D0 ⁴ (Dim to 1%, fade to off)			1B ⁵ Single Circuit w/ Battery Pack		4'
	09 (~898 lm/ft, 7.79W/ft)	L40		D02 ⁴ (Dim to 0%)					5'
	10 (~1036 lm/ft, 9.39W/ft)	L40		Lutron Dimming					6'
		H30		See Page 2 for Ordering Codes			CEC		7'
		H35		CEC Compliant (10W Battery Pack)					8'
		H40		DALI Dimming					
				eldoLED ECOdrive					
				ELE (Dim to 1%)					
			eldoLED SOLOdrive						
			ELS (Dim to 0%)						

Notes:

- Some products are DesignLights Consortium™ Qualified, refer to www.designlights.org Qualified. Products List under family models for details.
- Nominal lumen output per foot for frosted lens and 3500K.
- Standard driver, don't connect low-voltage wires for non-dimming applications. Consult factory for specifications and manufacturer.
- Consult factory for specifications and manufacturer.
- Battery pack not available in fixtures 3' or less.
- We recommend our Satin White lens for the Regressed position.
- 6" increments are common custom lengths. We can provide custom run length down to the nearest (+/- 1/8").
- Not available with Drop Lens.
- Only available with Frosted Flush lens.



Lens Options

Shielding

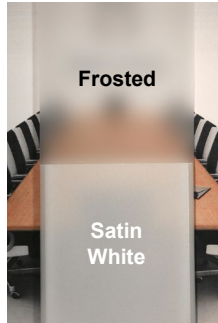

Frosted Lens
This diffuser is designed for a balance between efficiency and lens uniformity. (Transmission ~ 89%)

Satin White Lens
This diffuser is designed for visible lens uniformity. It's recommended for regressed lens configuration in our shallow housing. (Transmission ~ 69%)

Lutron Driver Ordering Codes

Nulite Code	Lutron Prefix	Lutron Series	Dim Level	Quantity of Wires	Dim to Dark (Smooth)
L11*	PEQ	Hi-Lume™ Premiere	0.1%	2	X
L12	LTEA	Hi-Lume™ 2-Wire 120V forward phase	1%	No Control Wires - Uses Hot	
L15	LDE1	Hi-Lume™ H-Series	1%	2	X
L16	LDE5	Hi-Lume™ 5-Series	5%	2	

*Maximum lumen package with L11 is 05

"L" Luminous Acrylic End Drop Lens

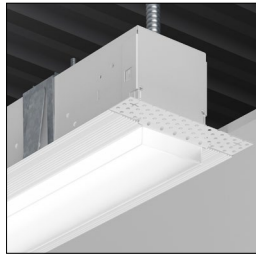

"R" Regressed Lens

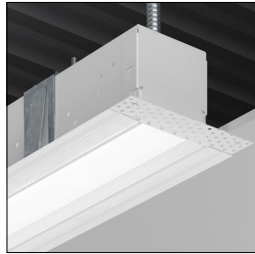

ASYM Option

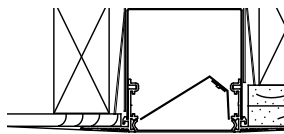

Sensor Option



Occupancy and/or Daylight Sensor (Surface Mount Shown)

Individual Lengths

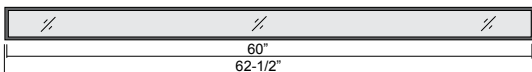
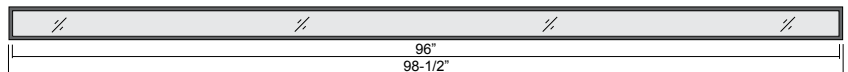
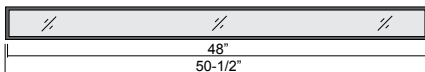
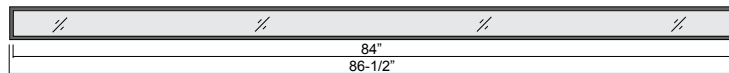
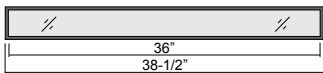
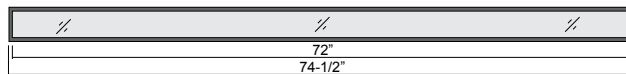
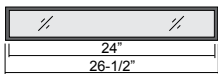

Continuous Run Lengths

Run Length

Number of Housings	Run Length																																																	
	2'	3'	4'	5'	6'	7'	8'	9'	10'	11'	12'	13'	14'	15'	16'	17'	18'	19'	20'	21'	22'	23'	24'	25'	26'	27'	28'	29'	30'	31'	32'	33'	34'	35'	36'	37'	38'	39'	40'	41'	42'	43'	44'							
2'	1																																																	
3'		1																																																
4'			1				1	1	1	1						1	1	1	1					1	1	1	1					1	1	1	1							1	1	1	1					
5'				1				1			1								1					1								1												1						
6'					1				1			1								1					1							1													1					
7'						1				1			1								1					1						1														1				
8'							1				1	1	1	1	1	2	1	1	1	1	2	2	2	2	3	2	2	2	3	3	3	3	4	3	3	3	3	4	4	4	4	4	4	5	4	4	4	4	5	

Run length doesn't include overlapping flange.

Continuous Row Joiner Detail

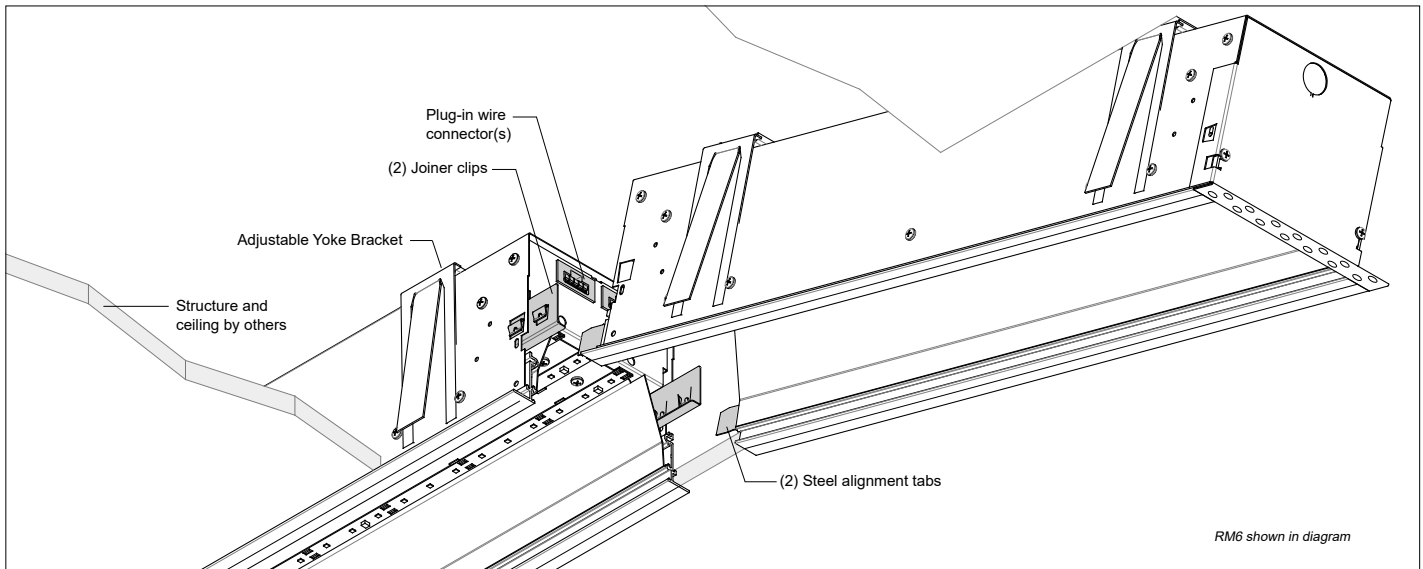

Photometric Curves

Cat. # RM4-05L35-...-FRF-...-4'
 Frosted Flush Lens
 Wattage/ft - 4.85
 Lumens/Watt - 117

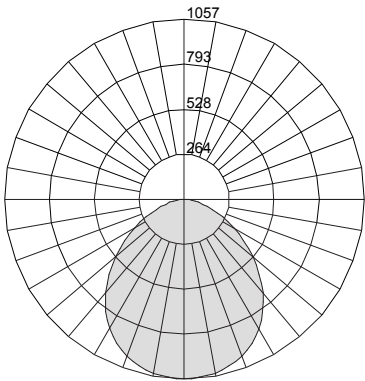

Cat. # RM4-09L35-...-FRF-...-4'
 Frosted Flush Lens
 Wattage/ft - 7.79
 Lumens/Watt - 115

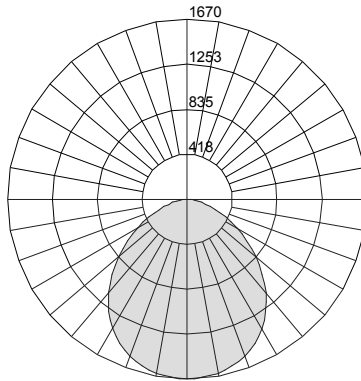

Cat. # RM4-05L40-...-FRF-...-4'-ASYM
 Frosted Flush Lens
 Wattage - 5.25
 Lumens/Watt - 110

