



Type:	Project:	Qty:
	Date:	
Catalog #:		

Description:

The Regolo RG6 LED series is a recessed, nominal 6" wide profile, slot unit designed for grid ceiling systems. This product is ideal for illuminating corridors, open and private offices, classrooms, lobbies and general purpose rooms.

Specifications:

Construction: The housing consists of visible extruded aluminum trim rails with formed cold rolled steel back channel and heavy gauge end caps. Steel alignment tabs and white snap-in joiner clips are used for continuous row applications. Luminaire is finished textured white.

Reflector / Driver: Reflector / driver cover is finished with high reflectance white paint. Optional asymmetric semi-specular aluminum reflector. Standard constant current electronic driver with 0-10V dimming input; dimming range from 100% down to 10%. Universal (UNV) voltage is from 120 - 277V, 50/60 Hz.

Shielding: Extruded frosted or satin white acrylic snap-in lens with DR.

LED Module: Distributed LED array in a variety of lumen output packages. LED color is available in (L30) 3000K, (L35) 3500K or (L40) 4000K. Module is replaceable. L90 ≥ 100,000 hours.

Mounting: Ceiling grid system. Can be installed in the popular lay-in ceiling systems which has a 6" on-center zone. Non-IC rated. Individual mount or continuous runs.

Labels: ETL listed, conforms to UL Standard 1598 / 8750 and CSA Standard C22.2, Damp location.

Warranty: 5-year limited LED luminaire warranty.

Flush Lens

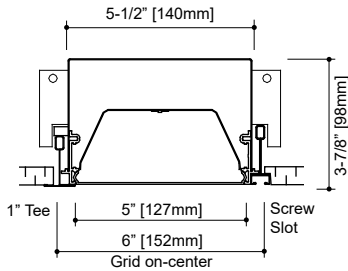

Regressed Lens

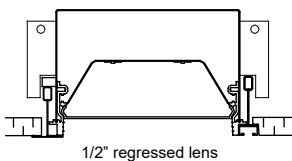

ASYM Option

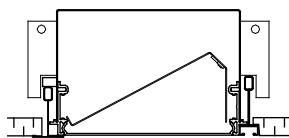

Ordering Information

Sample: RG6-10L40-UNV-ELS-1C-STR-20'

Series	Lumen Package ² / Color	Voltage	Driver	Circuit	Shielding/Position	Length	Options	
RG6 ¹								
RG6 (Grid Nom. 6")	05 (~571 lm/ft, 4.85W/ft)	L30	UNV	Dimming (0-10V) D ³ (Dim to 10%) D1 ⁴ (Dim to 1%) D0 ⁴ (Dim to 0%) Lutron Dimming See Page 2 for Ordering Codes DALI Dimming eldoLED ECOdrive ELE (Dim to 1%) eldoLED SOLOdrive ELS (Dim to 0%)	1C Single Circuit 1E Single Circuit w/ EM Circuit 1B Single Circuit w/ Battery Pack	FR (Frosted) ST (Satin white) F (Flush lens) R ⁵ (Regressed lens)	2'	CP Chicago Plenum OS End of run Occupancy Sensor DS End of run Daylight Sensor FLEX 6' of Flex ASYM ⁷ Asymmetric Reflector GLR Fusing See Accessories for Corners and Downlight Modules
	06 (~728 lm/ft, 6.38W/ft)	L35	120				3'	
	09 (~882 lm/ft, 7.79W/ft)	L40	277				4'	
	10 (~1035 lm/ft, 9.39W/ft)						5'	
	13 (~1269 lm/ft, 11.6W/ft)						6'	
	17 (~1576 lm/ft, 14.6W/ft)						7'	
			8'					
			Continuous Runs ⁶					
			XX' Specify run length in 1 foot increments. Consult factory for custom lengths.					

Notes:

- Some products are DesignLights Consortium™ Qualified, refer to www.designlights.org Qualified Products List.
- Nominal lumen output per foot for frosted lens and 3500K.
- Standard driver, don't connect low-voltage wires for non-dimming applications. Consult factory for specifications and manufacturer.
- Consult factory for specifications and manufacturer.
- We recommend our Satin White lens for the Regressed position.
- 6" increments are common custom lengths. We can provide custom run length down to the nearest (+/- 1/8").
- Only available with Frosted Flush lens.



Specifications and dimensions are subject to change without notification. Specification sheets on our website supersede all other versions. 2016 Rev. D1 Nulite reserves the right to bulk package any order.

Ceiling Grid Details

1" Grid Detail

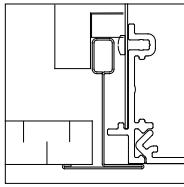

Standard Tile

9/16" Grid Detail

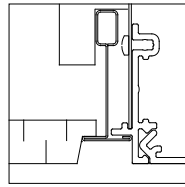

Tegular Tile

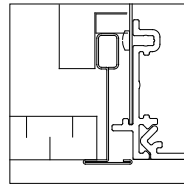

Standard Tile - 1-1/2" "T" height & supported by grid hook extension

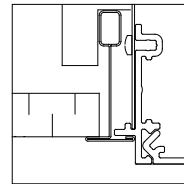

Standard Tile - Drop-down Luminaire

Screw Slot Detail

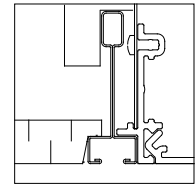

Tegular Tile

1" End Detail

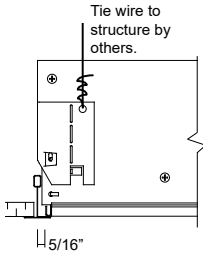

9/16" End Details

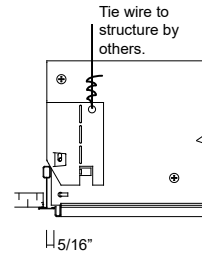
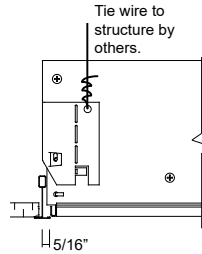
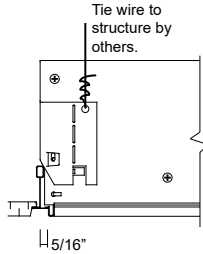

Screw Slot End Detail

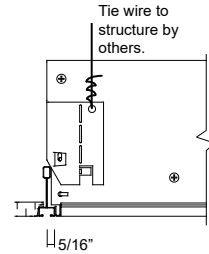

Lens Options

Shielding

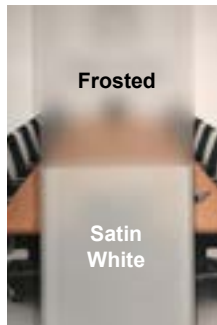

Frosted Lens
This diffuser is designed for a balance between efficiency and lens uniformity. (Transmission ~ 89%)

Satin White Lens
This diffuser is designed for visible lens uniformity. It's recommended for regressed lens configuration in our shallow housing. (Transmission ~ 69%)

Lutron Driver Ordering Codes

Nulite Code	Lutron Prefix	Lutron Series	Dim Level	Control Type	
				3-Wire	Eco-System™
L11	L3DAE	Hi-lume™	1%		Yes
L12	L3DA3W	Hi-lume™	1%	Yes	
L15	LDE1*	Hi-lume™ - H Series	1%		Yes
L16	LDE5	5-Series	5%		Yes

* Soft-on, Fade-to-Black™

Position

Regressed Lens - "R"



1/2" Regressed Lens (Satin White lens is recommended)

Sensor Option



Occupancy and/or Daylight Sensor (Surface Mount Shown)

Specifications and dimensions are subject to change without notification.

Individual Lengths

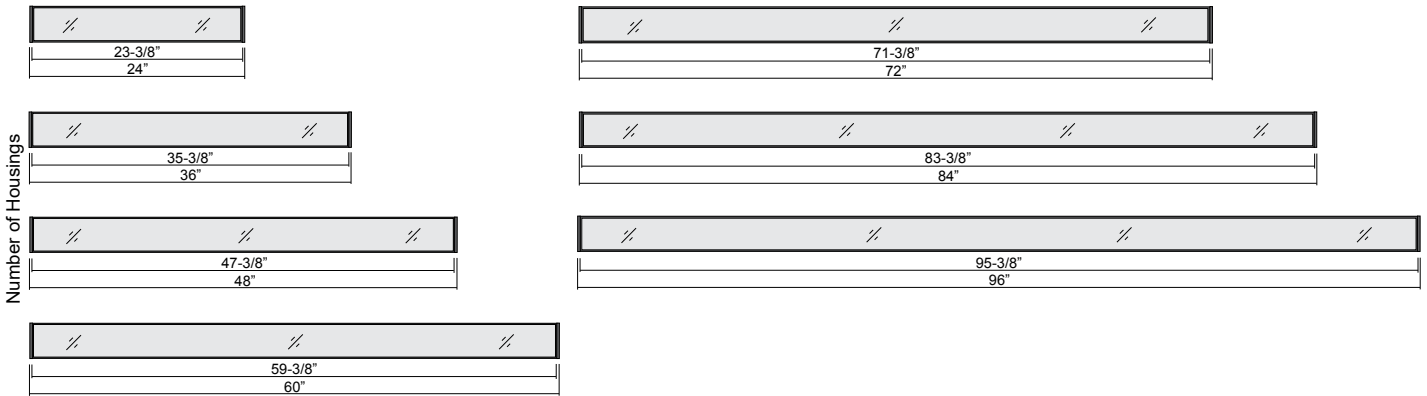

Continuous Row Joiner Detail

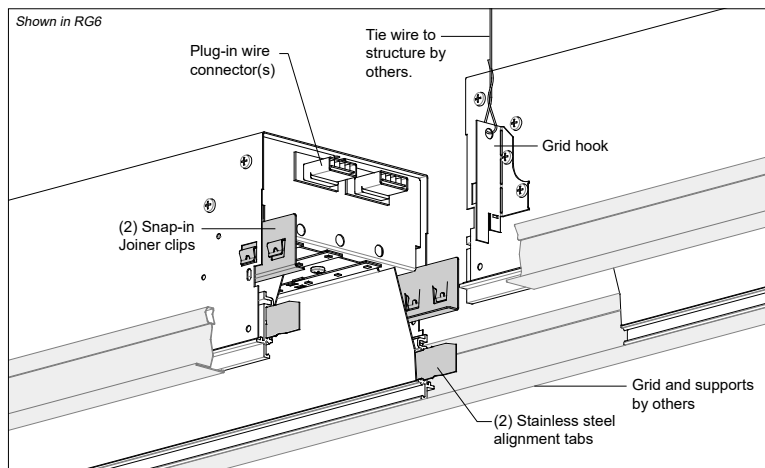

Continuous Run Lengths

Run Length

	2'	3'	4'	5'	6'	7'	8'	9'	10'	11'	12'	13'	14'	15'	16'	17'	18'	19'	20'	21'	22'	23'	24'	25'	26'	27'	28'	29'	30'	31'	32'	33'	34'	35'	36'	37'	38'	39'	40'	41'	42'	43'	44'							
2'	1																																																	
3'		1																																																
4'			1					1	1	1	1				1	1	1	1					1	1	1	1				1	1	1	1							1	1	1	1							
5'				1				1			1				1				1				1				1							1																
6'					1			1			1				1				1			1				1							1																	
7'						1		1			1				1				1			1				1						1																		
8'							1			1	1	1	1	1	2	1	1	1	1	2	2	2	2	3	2	2	2	3	3	3	3	4	3	3	3	3	4	4	4	4	4	5	4	4	4	4	5			

Specifications and dimensions are subject to change without notification.

2016 Rev. D1

Photometric Curves

Cat. # RG6-05L35-...-FRF-...-4'
 Wattage/ft - 4.85
 Lumens/Watt - 118

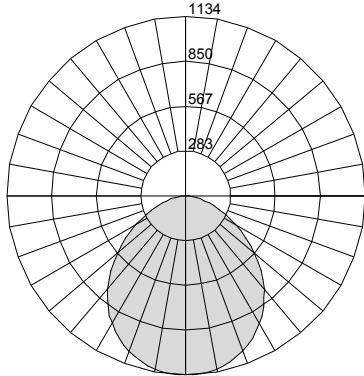

Cat. # RG6-09L35-...-FRF-...-4'
 Wattage/ft - 7.79
 Lumens/Watt - 113

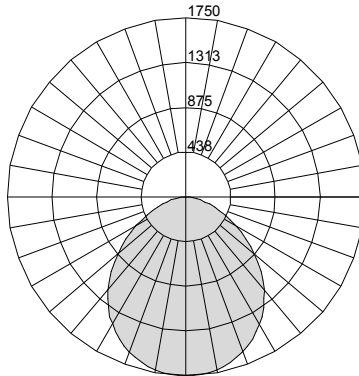

Cat. # RG6-05L35-...-FRF-...-4'-ASYM
 Wattage/ft - 5.25
 Lumens/Watt - 109

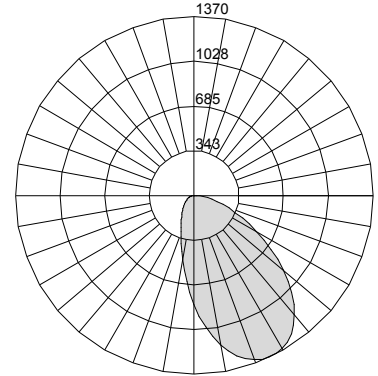

Specifications and dimensions are subject to change without notification.