



Type:	Project:	Qty:
	Date:	
Catalog #:		

Description:

The Nulite Regolo RG6 series is a narrow recessed, nominal 6" wide profile, slot unit designed for grid ceilings. This product is ideal for illuminating corridors, open and private offices, classrooms, lobbies and general purpose rooms.

Specifications:

Construction: The housing consists of visible extruded aluminum trim rails with formed cold rolled steel back channel and heavy gauge end caps. Steel alignment tabs and white snap-in joiner clips are used for continuous row applications. Luminaire is finished textured white.

Reflector / Ballast: Reflector ballast cover is finished with high reflectance white paint. Standard electronic, Class P, ballast. Universal (UNV) voltage ballast is from 120 - 277V.

Shielding: Extruded frosted acrylic or satin white acrylic snap-in lens with DR or semi-specular cross blade baffle.

Lamping: 1, 2 or 3 lamp cross-section T5, T5HO or T8. Luminaire can be ordered with lamps, consult factory.

Mounting: Grid ceiling types. Non-IC rated. Individual mount or continuous runs. RG6 can be installed in the popular lay-in ceiling systems which has a 6" on-center zone.

Labels: UL / cUL listed, Non-IC rated, for Damp location.

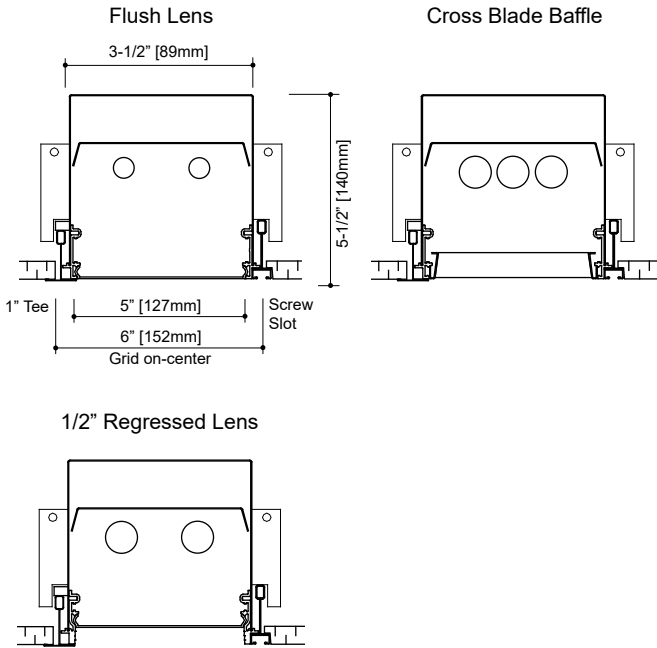

Ordering Information

Sample: RG6-2T8-N-277-PSN-1C-FRF-24'

Series	Lamp	Staggered	Voltage	Ballast	Circuit	Shielding / Position	Length	Options
RG6								
RG6 (Grid - Nom. 6')	T5	N (Non-staggered)	UNV	T8 Options	1C Single Circuit	FR (Frosted)	2'	GLR Fusing
	1T5HO		120	IS (Standard)	2C ² Dual Circuit	ST (Satin white)	3'	FLEX 6' of Flex
	1T8		277	PS	1E Single Circuit w/ EM Circuit	SB (Semi-spec Blade)	4'	OS Occupancy Sensor at end of run / unit
	2T5		347 ¹	HEIS	2E ² Dual Circuit w/ EM Circuit	R (Regressed Lens)	5'	DS Daylight Sensor at end of run / unit
	2T5HO			HEPS	1B ³ Single Circuit w/ Battery Pack		6'	
	2T8			T5 / T5HO	2B ^{2,3} Dual Circuit w/ Battery Pack		7'	
	3T5			PS (Standard)			8'	
	3T5HO			HEPS ¹				
	3T8			All Lamp Dimming Options				
				DIM ¹ Dimming				
				SD ¹ Step Dimming				
				IS=Instant Start				
				PS=Program Start				
				HEIS=High Efficiency Instant Start				
				HEPS=High Efficiency Program Start				

Notes:

1. Consult factory.
2. Not available in all options, consult factory.
3. Specific voltage must be ordered for this option.

Specifications and dimensions are subject to change without notification. Specification sheets on our website supersede all other versions. 2017 Rev. D1 Nulite reserves the right to bulk package any order.

Ceiling Grid Details

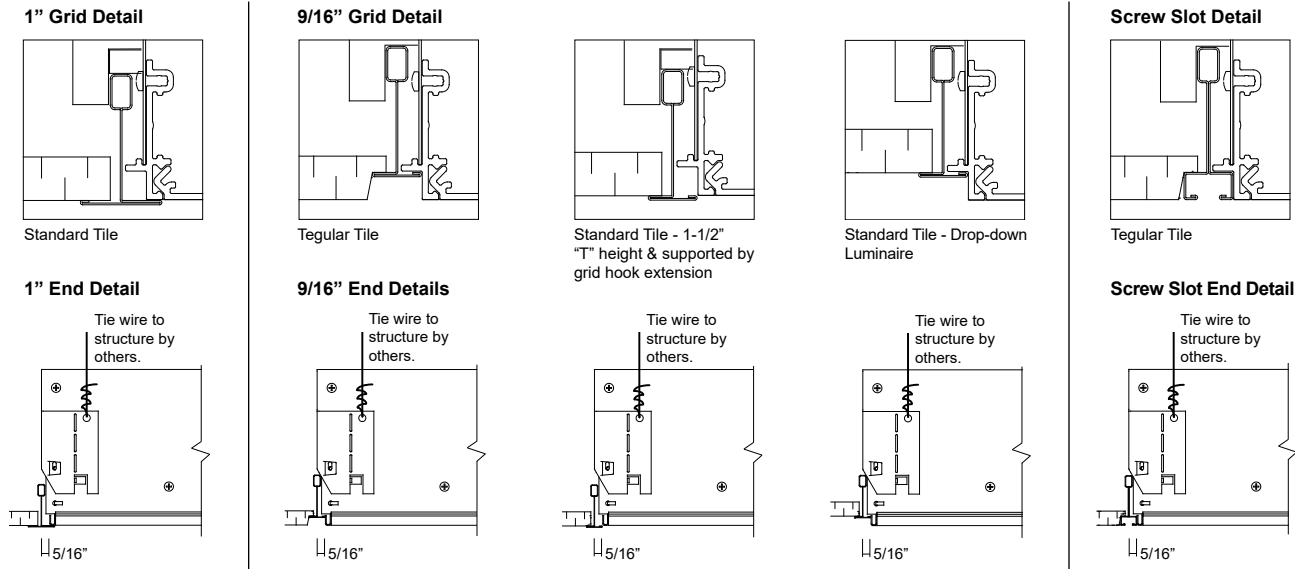

Shielding Options



Frosted Lens
This diffuser is designed for a balance between efficiency and lens uniformity. (Transmission ~ 89%)

Satin White Lens
This diffuser is designed for visible lens uniformity. It's recommended for regressed lens configuration in our shallow housing. (Transmission ~ 69%)

Regressed Lens - "R"



1/2" Regressed Lens

Semi-Specular Baffle

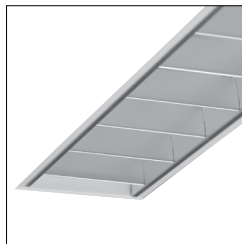

Sensor Options



Occupancy or Daylight Sensor in a nominal 3" long insert plate. Lamps extend under the sensor plate and are removable without removing the sensor.

Specifications and dimensions are subject to change without notification.

Individual Lengths

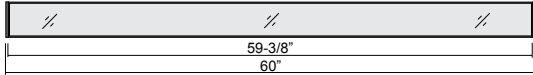
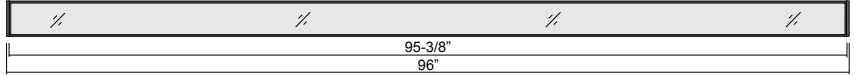
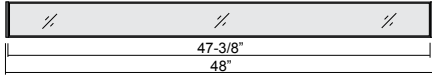
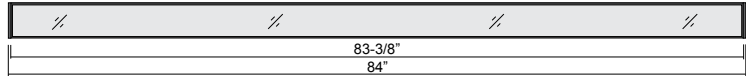
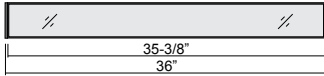
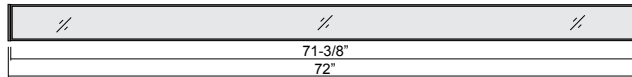
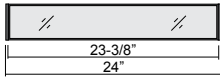

Continuous Row Joiner Detail

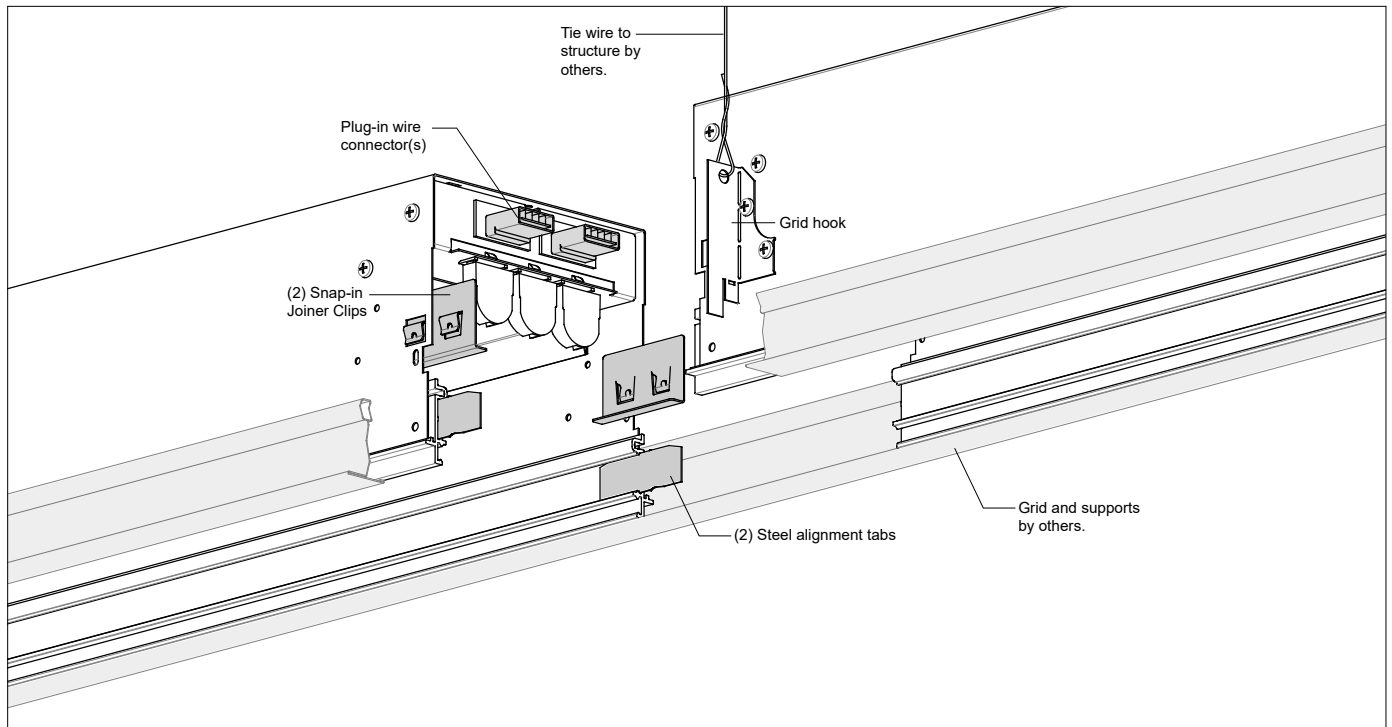

Continuous Non-Staggered Run Lengths

Non-Staggered Run Length (A = Stand Alone Housing, S = Starter Housing, M = Mid Housing, E = End Housing)

	2'	3'	4'	5'	6'	7'	8'	9'	10'	11'	12'	13'	14'	15'	16'	17'	18'	19'	20'	21'	22'	23'	24'	25'	26'	27'	28'	29'	30'	31'	32'	33'	34'	35'	36'	37'	38'	39'	40'		
24A	1																																								
36A		1																																							
48A			1																																						
60A				1																																					
72A					1																																				
84A						1																																			
96A							1																																		
72S								1	1															1	1																
96S										1	1	1	1	1	1	1																									
96M																																									
36E								1	1																																
48E									1	1																															
60E										1																															
72E											1																														
84E												1																													
96E													1																												

Shaded columns require all 4' lamps.

Photometric Curves

Cat. # RG6-2T5-N-...-FRF-...-4'
Frosted Flush Lens
Initial lamp lumens - 5200

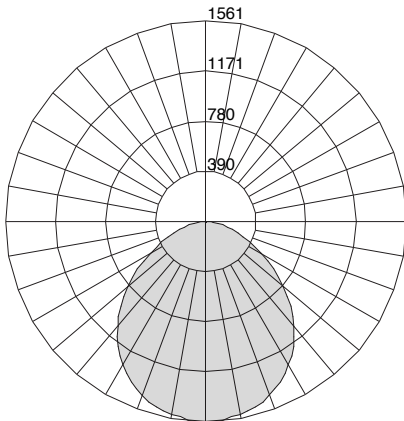

Cat. # RG6-2T8-N-...-FRF-...-4'
Frosted Flush Lens
Initial lamp lumens - 5600

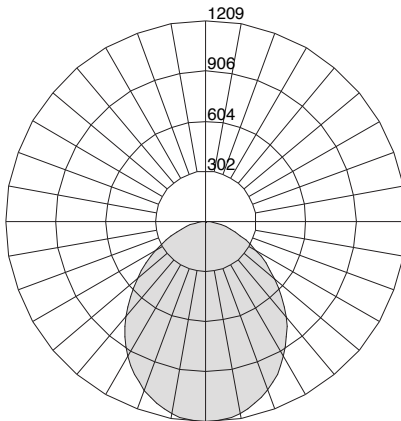

Cat. # RG6-2T8-N-...-SB-...-4'
Specular Blade Baffle
Initial lamp lumens - 5600

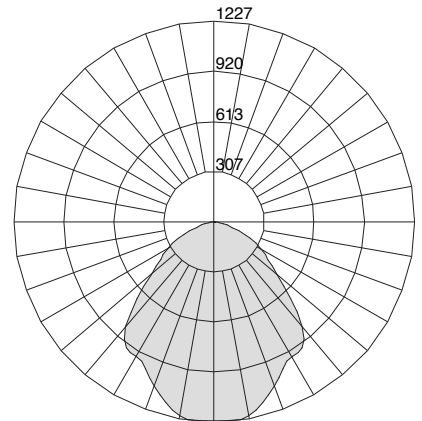

Specifications and dimensions are subject to change without notification.