

INDIVIDUAL FIXTURES

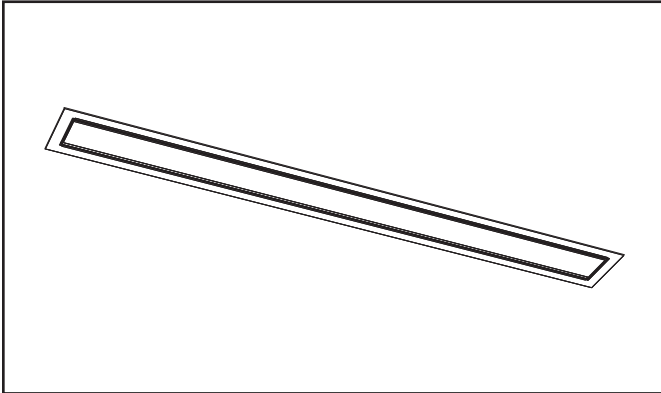

WARNINGS:

- Do not assemble continuous run on the ground and lift into place. Joints will distort and not create a tight fit. Joining hardware will have to be purchased and replaced.
- Risk of electrical shock or fire, disconnect power during installation or servicing. Read all instructions completely before starting installation. Install and wire in accordance to all national and local codes by a certified electrician. Fixture may be sharp, handle with care. Let fixture cool before maintenance.

CONTINUOUS ROW FIXTURES

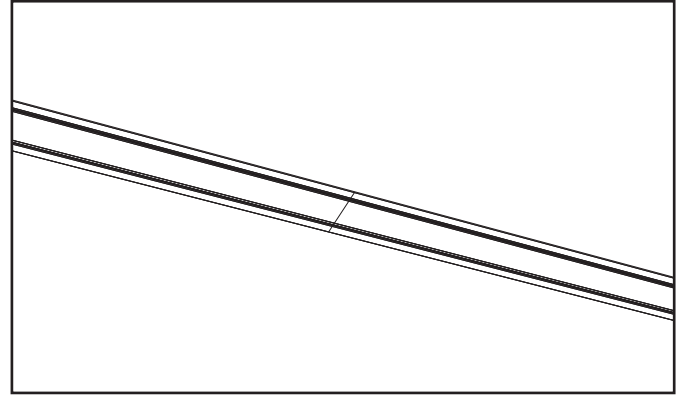

AVERTISSEMENTS

- Risque d'électrocution ou d'incendie. Déconnectez l'alimentation durant l'installation ou la maintenance. Lisez attentivement toutes les instructions avant de commencer toute installation. Faites installer et câbler selon les normes Nationales et Locales par un électricien certifié. Les installations peuvent être coupantes, à manipuler avec précaution. Laissez refroidir les installations avant une opération de maintenance.

ADVERTENCIA

- Riesgo de descarga eléctrica o un incendio, desconecte la alimentación durante la instalación o servicio. Leer todas las instrucciones completas antes de empezar la instalación. Instalar y cablear en acuerdo a las reglas nacionales y códigos locales por un electricista certificado. El accesorio puede estar agudo, agarre con cuidado deje que el accesorio. Enfriar antes de mantenimiento.

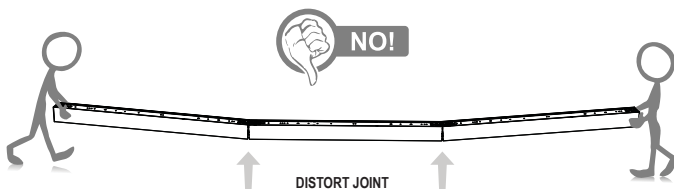

LIGHTING SYSTEM COMPONENTS

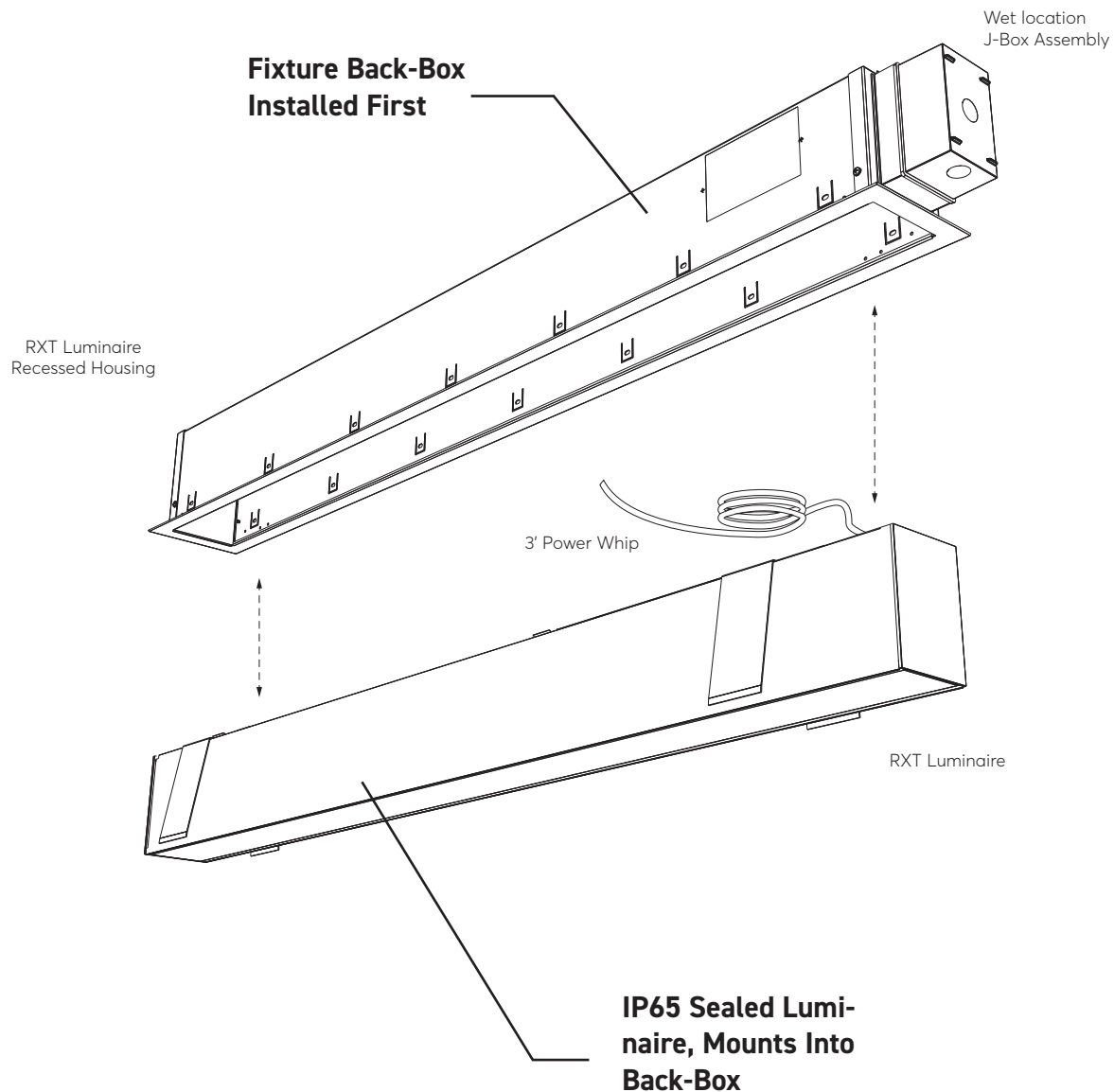

*Every luminaire will have an integral driver.

LIGHTING SYSTEM COMPONENTS

INDIVIDUAL LUMINAIRE

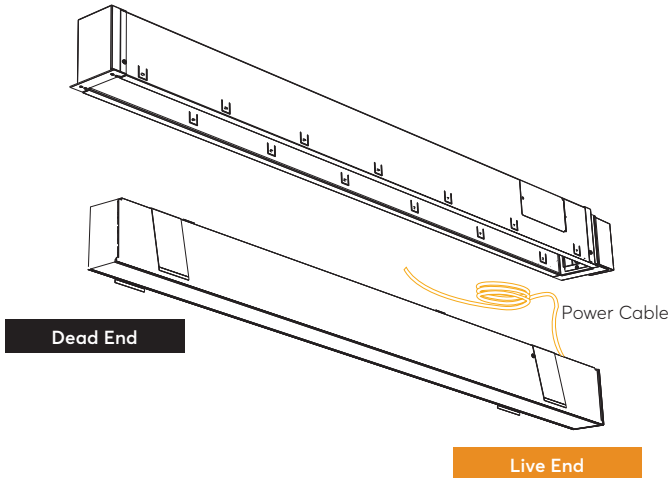

CONTINUOUS LUMINAIRE

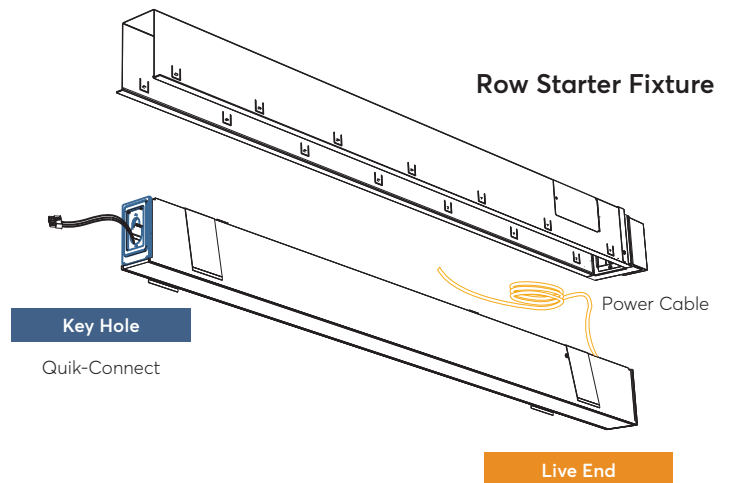

Mounting Components for Continuous Fixtures

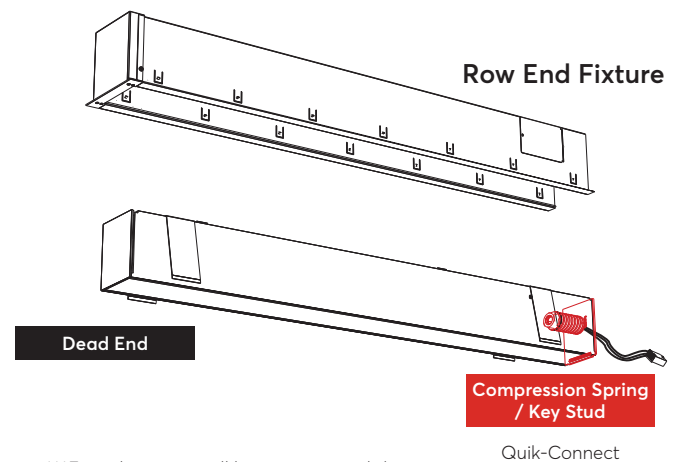
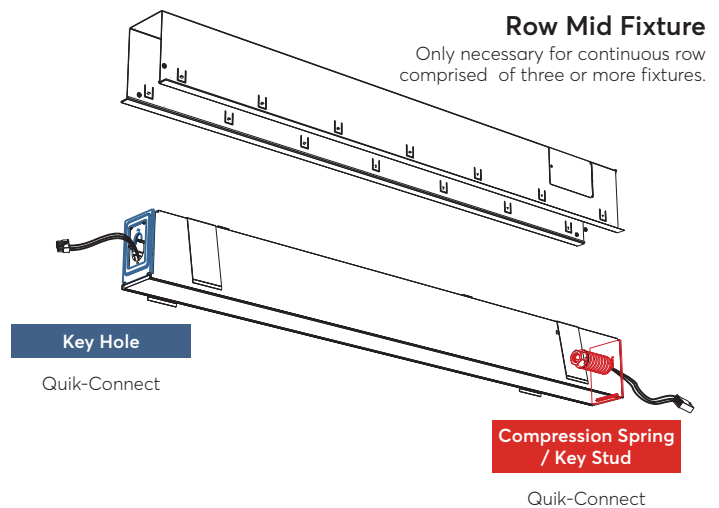
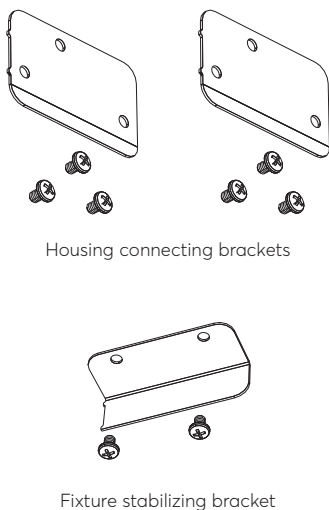

***Every luminaire will have an integral driver.

INSTALLING RXT RECESSED LUMINAIRES

Sheet Rock / Recessed w/ Flange

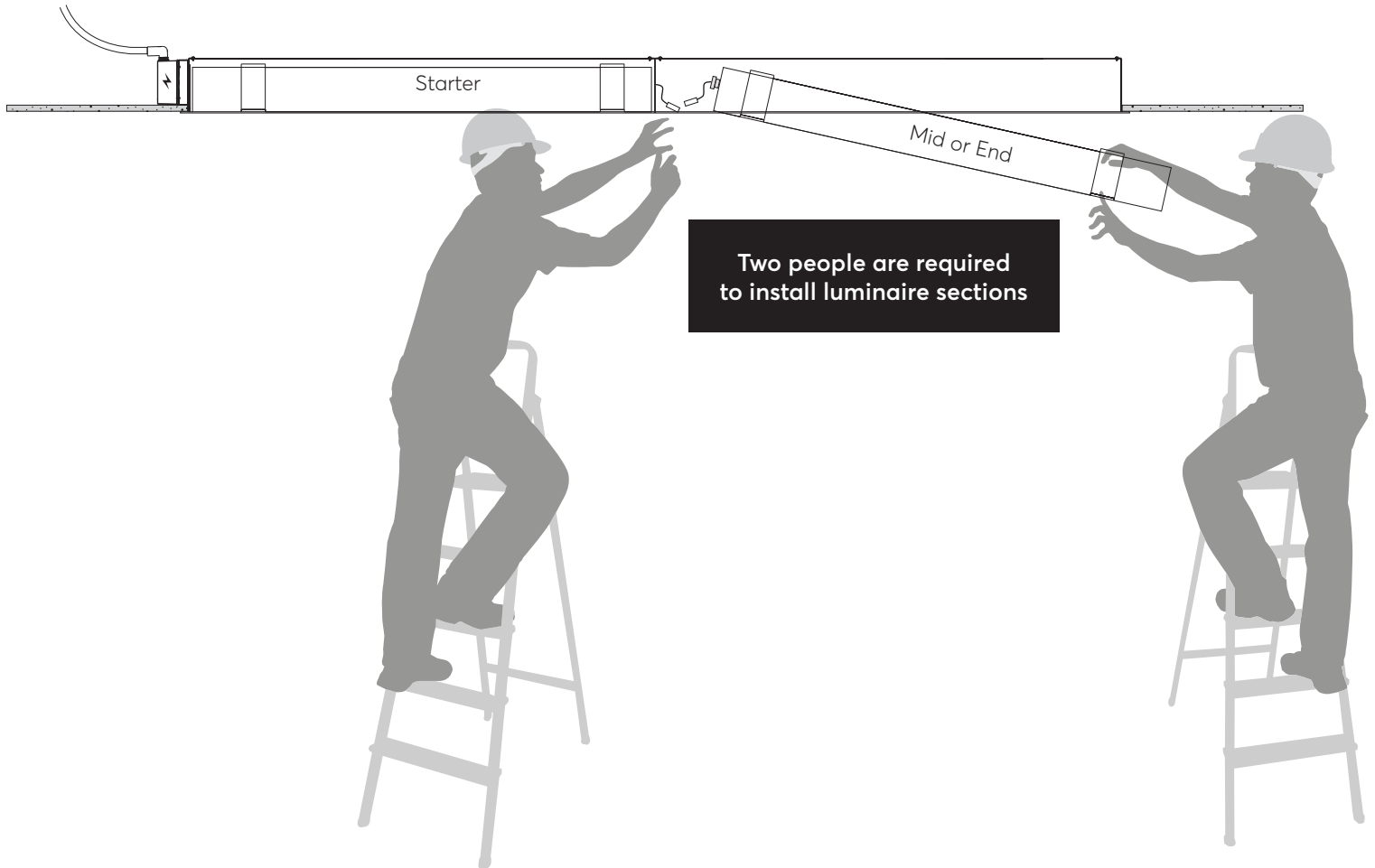

The **NOMINAL FIXTURE LENGTH** is referenced in the catalog number for **INDIVIDUAL** and **ROW** FIXTURES.

NOMINAL FIXTURE LENGTHS ARE EXACT INCREMENTS OF 12" OR 305 mm

Example: Cat# RXT-F-FF-07L35-U-D-W-16

**Nominal Row Length:
16' (8' + 8') Continuous Row
(192" / 4877mm)**

"Individual" Nominal Fixture Lengths		
Length (feet)	Length (inches)	Length (mm)
2'	24"	610 mm
3'	36"	915 mm
4'	48"	1219 mm
5'	60"	1524 mm
6'	72"	1829 mm
7'	84"	2134 mm
8'	96"	2438 mm

INDIVIDUAL FIXTURE MOUNTING DIMENSIONS

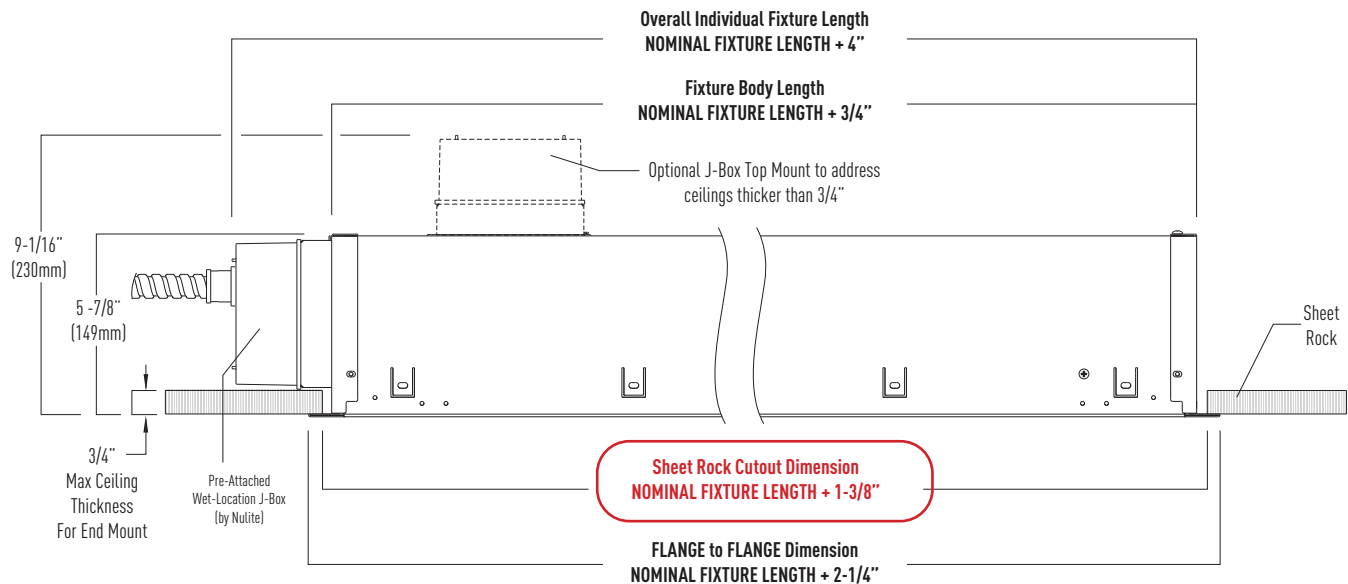

CONTINUOUS ROW MOUNTING DIMENSIONS

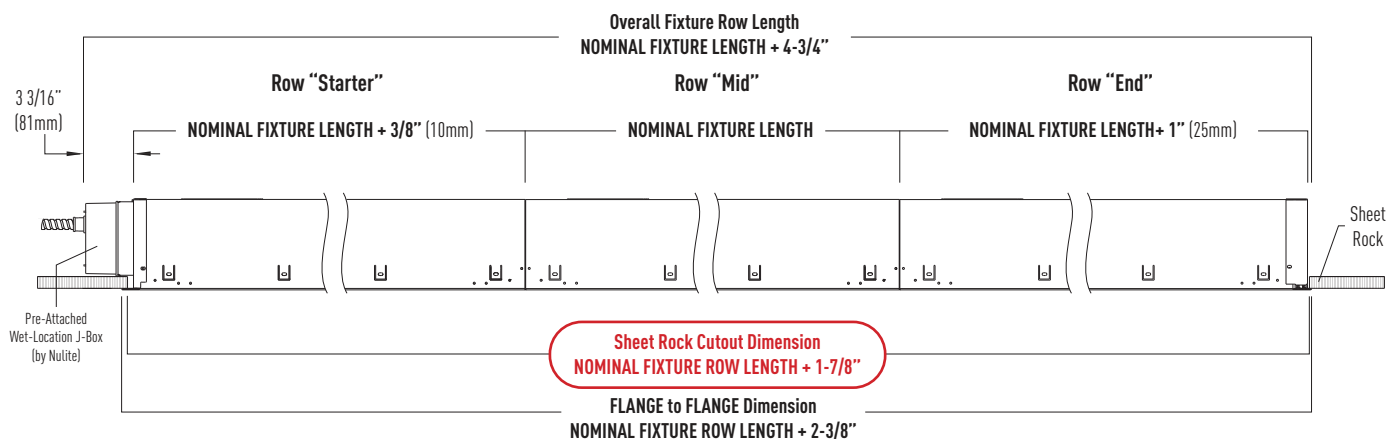

[illegible]

INSTALLING AN INDIVIDUAL OR ROW STARTER LUMINAIRE

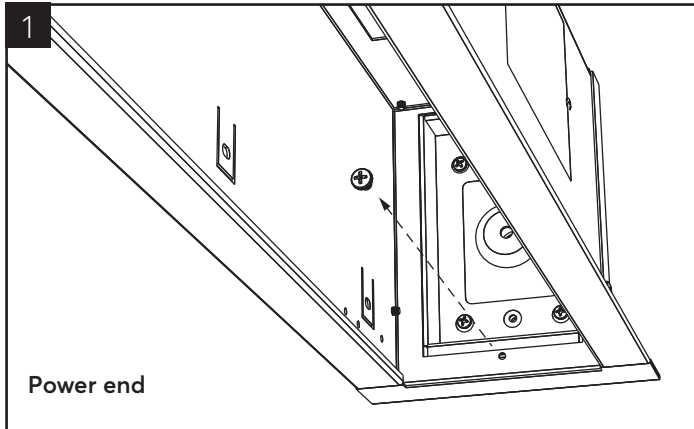

Remove screw from inside of housing to dislodge the j-box assembly

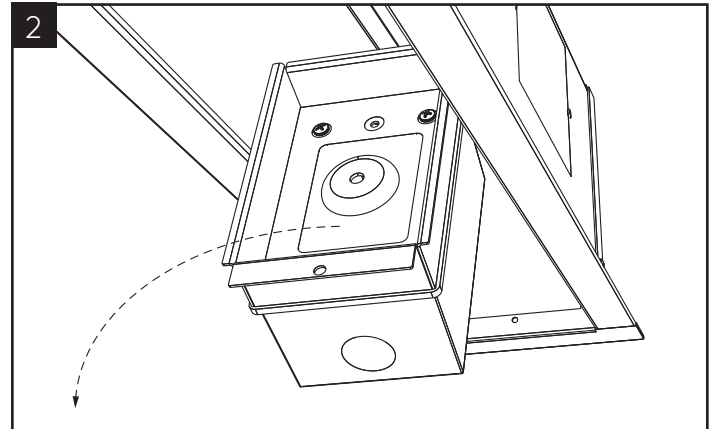

Remove the entire J-box assembly from the housing and set aside

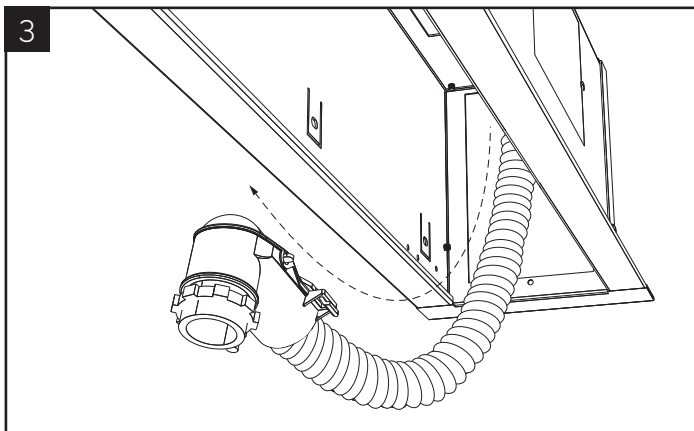

Pull the line power flex from the ceiling through the opening at the end of the fixture

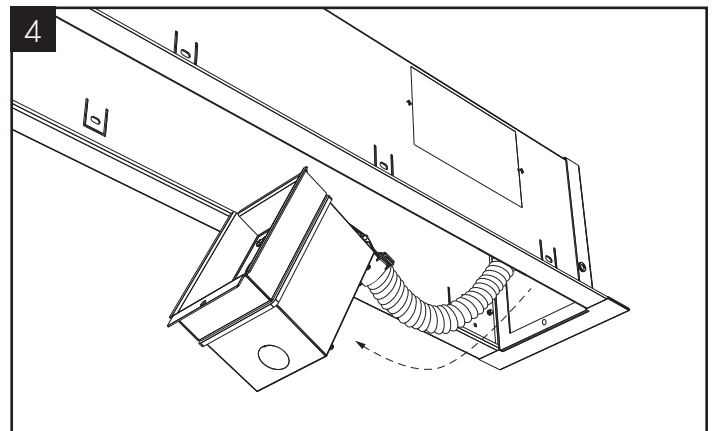

Attach the flex to the wet location j-box assembly

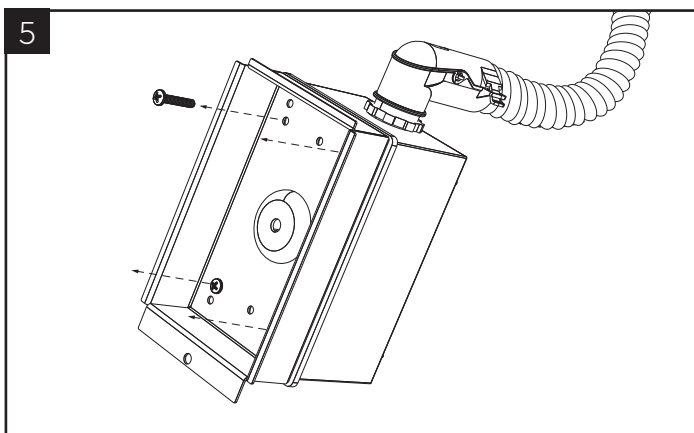

Remove the screws from the j-box cover plate

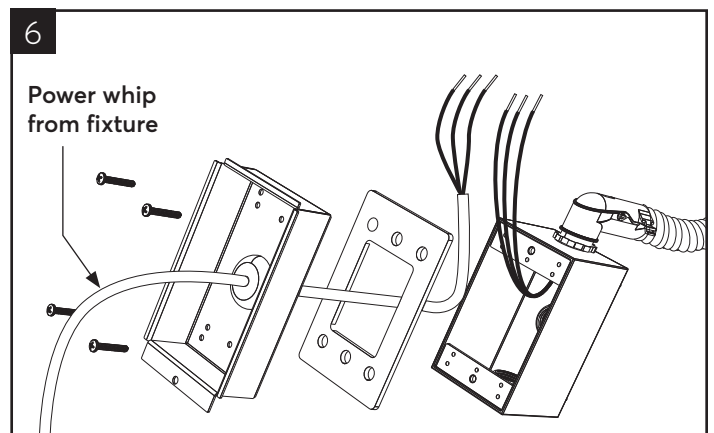

Separate the components of the j-box assembly and feed the fixture whip through the bushing, and gasket

INSTALLING AN INDIVIDUAL OR ROW STARTER LUMINAIRE

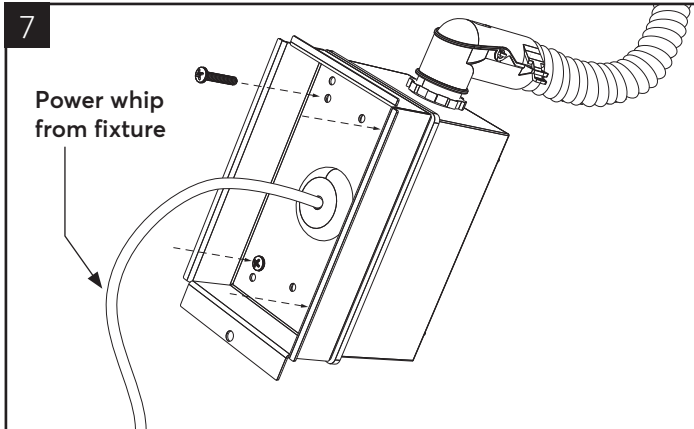

Make wire connection per local code and reassemble the j-box assembly

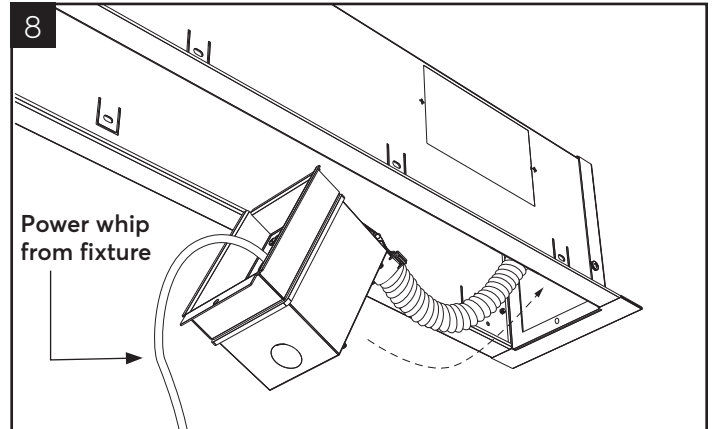

Feed the assembled j-box back through the housing opening and secure with the screw from step 1

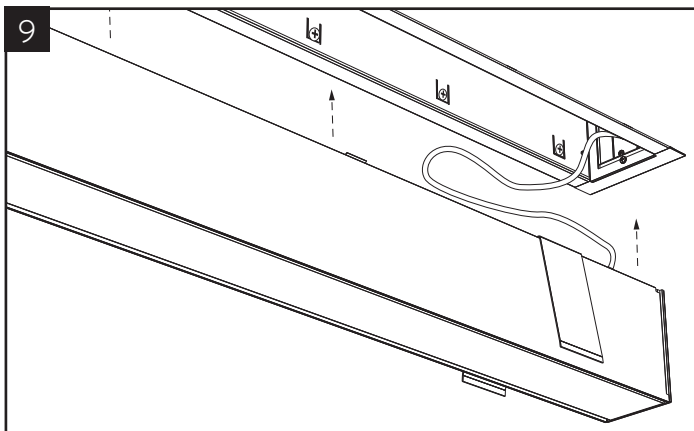

Feed the fixture into the housing opening. Tuck the excess power whip above the fixture

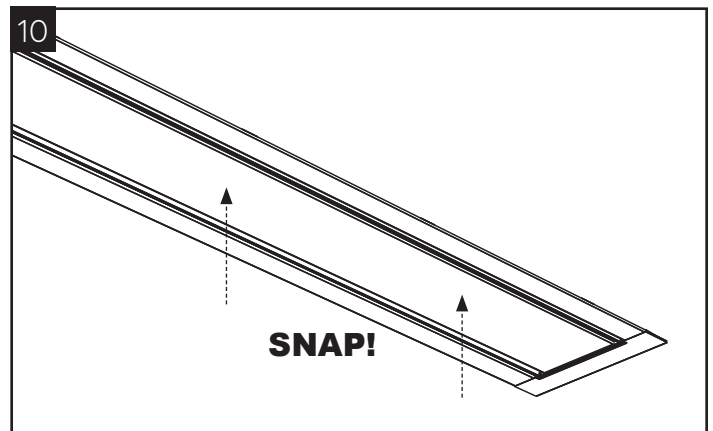

Press fixture up into the housing until the retainer spring snap into place

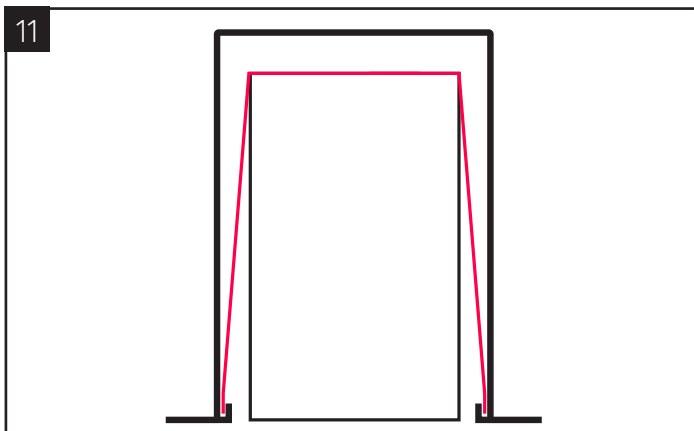

The retainer springs will rest on the inside lip of the housing holding it securely in place

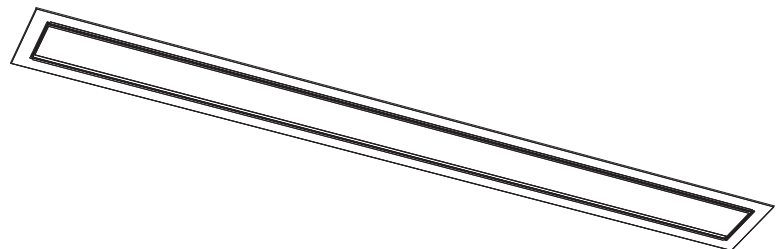

The diagram illustrates a continuous cable system. It shows a horizontal cable with three sections separated by break symbols (two parallel diagonal lines). The first section on the left is labeled "Blocking" and shows a cable with a single support point. The middle section shows a cable with two support points. The third section on the right shows a cable with two support points and a "Wet Location J-Box" at the end, which is connected to a power source (indicated by a lightning bolt symbol). The entire system is labeled "Continuous" at the bottom.

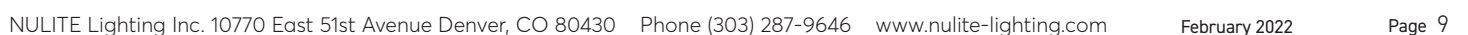

INSTALLING A ROW-MID OR ROW-END (AFTER STARTER HAS BEEN INSTALLED, STEPS 1-11 FROM PAGE 6-7)

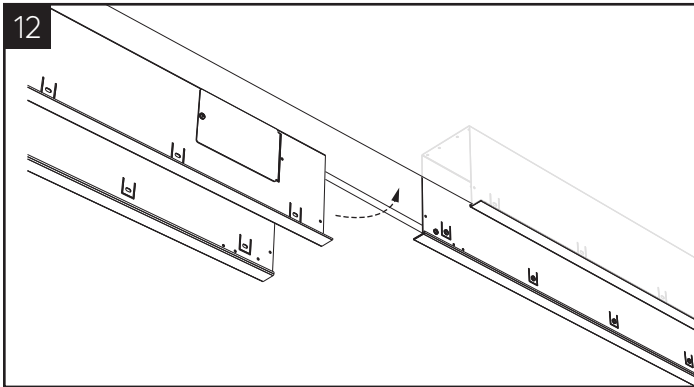

Locate next housing section in the row and push it into the ceiling cut-out next to the previous housing section

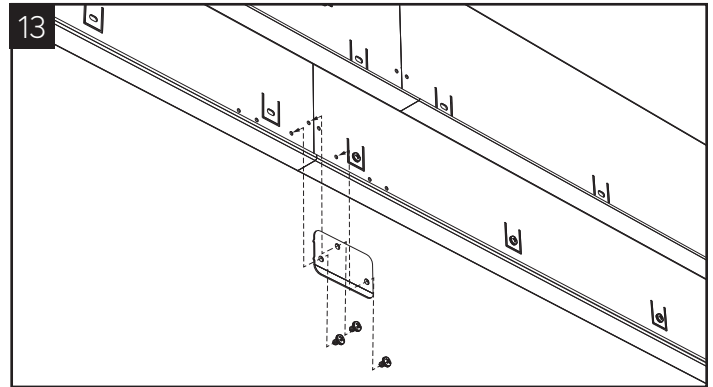

Install the housing connecting brackets as shown on both sides of the housing

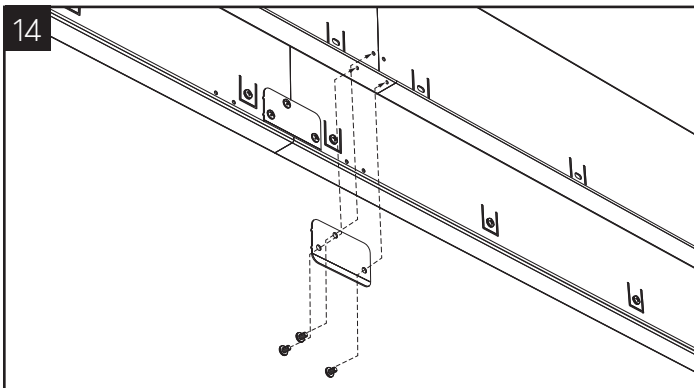

Ensure the brackets have created a tight fit to join the sections properly

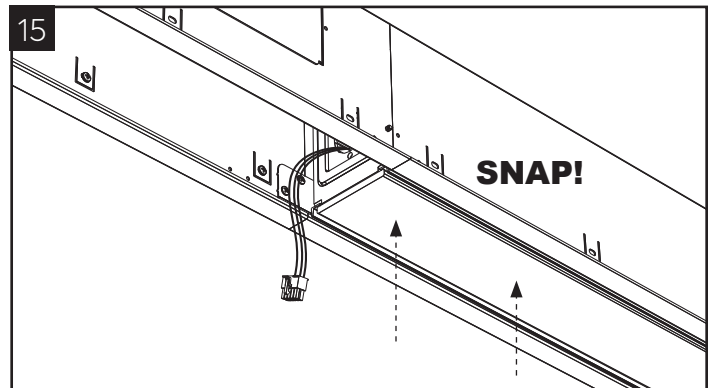

Prepare the first housing section and install the row starter fixture according to steps 1-11 on pages 6 & 7

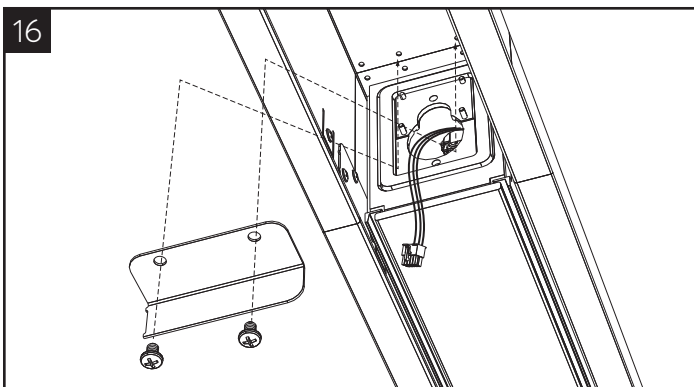

Install the fixture stabilizing bracket. This bracket is used to stabilize the first fixture while connecting the next fixture.

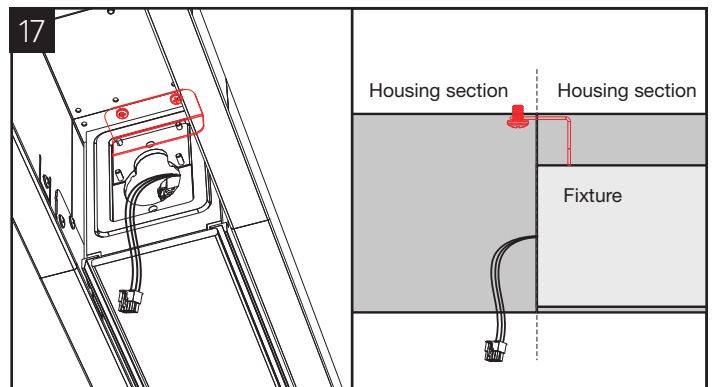

The stabilizing bracket prevents the fixture from lifting up when installing the next fixture in the row

INSTALLING A ROW-MID OR ROW-END

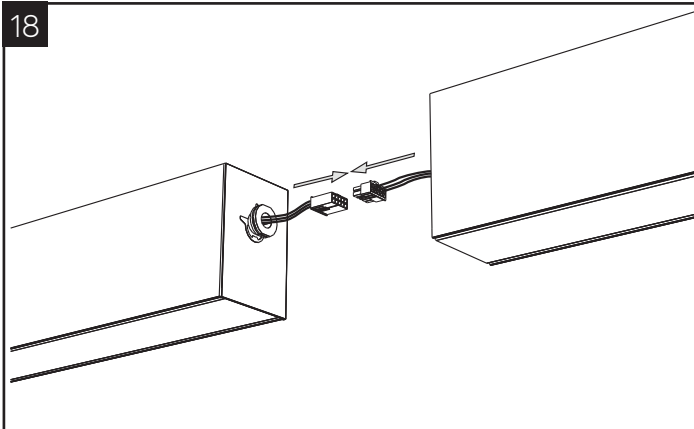
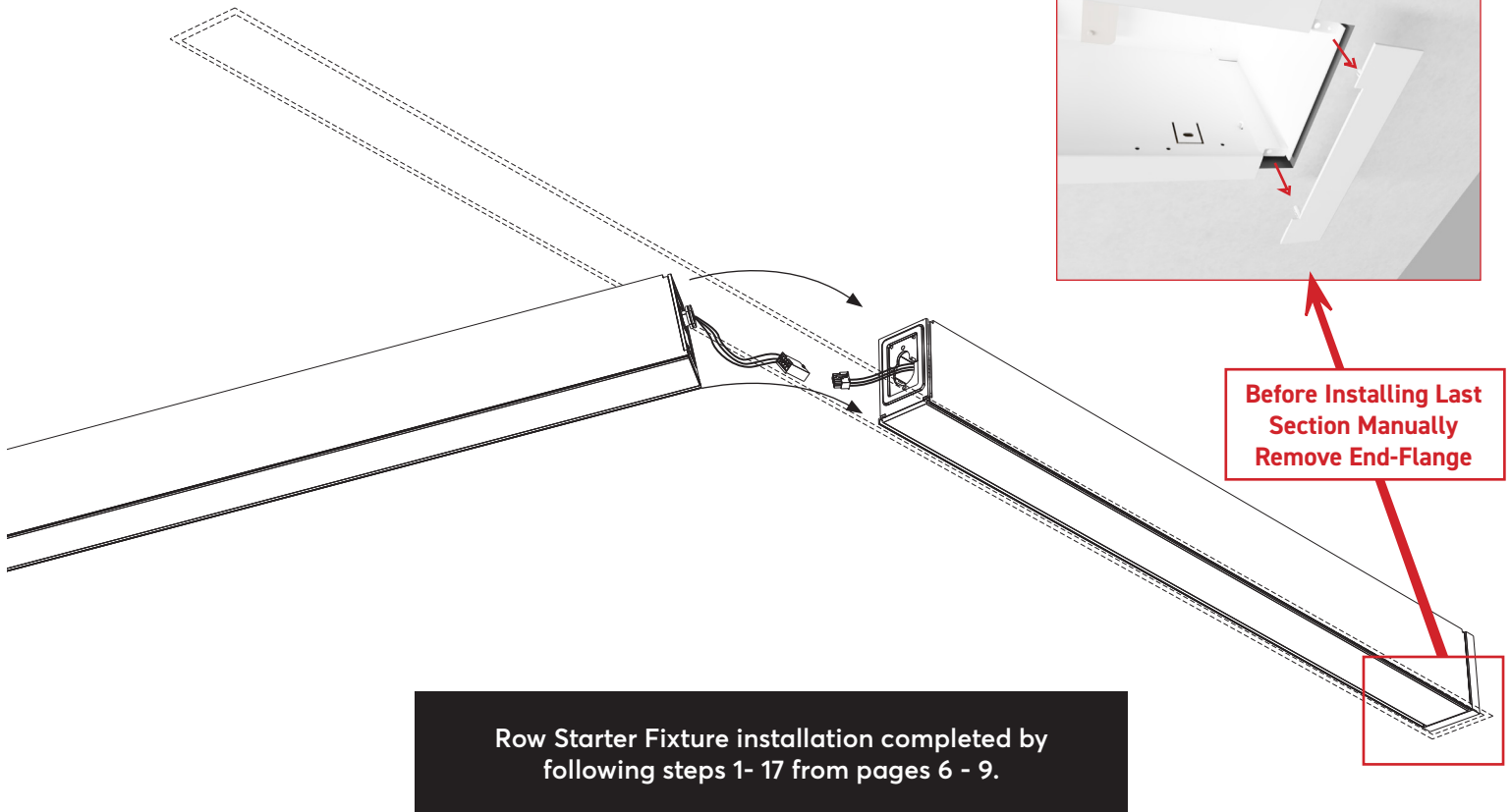

Connect the male and female quick connector to power the next luminaire in the row

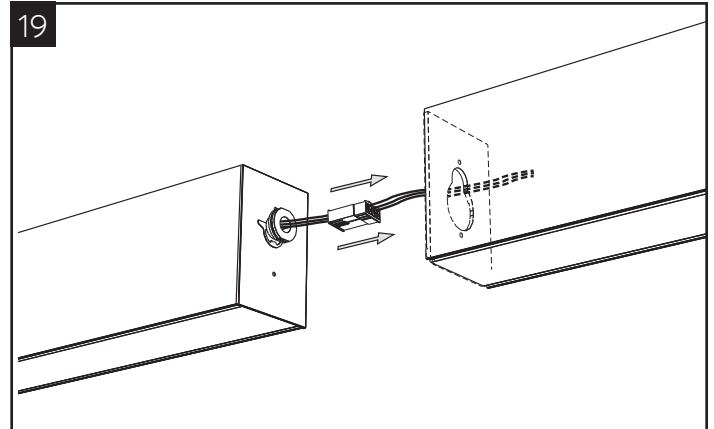

Tuck the wires and connectors into the starter or previous luminaire in the row

INSTALLING A ROW-MID OR ROW-END (AFTER STARTER HAS BEEN INSTALLED, STEPS 1-17 FROM PAGE 6-9)

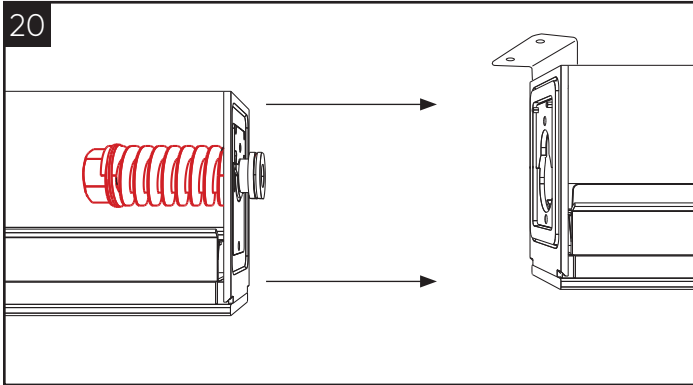

Push the luminaires together ensuring proper alignment

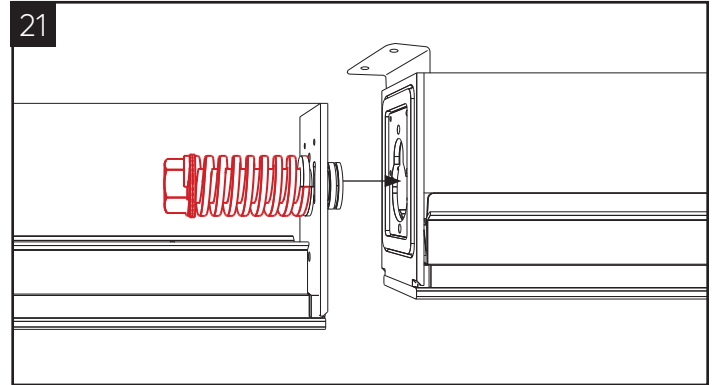

Insert the key stud from the new luminaire into the key hole on the previous luminaire

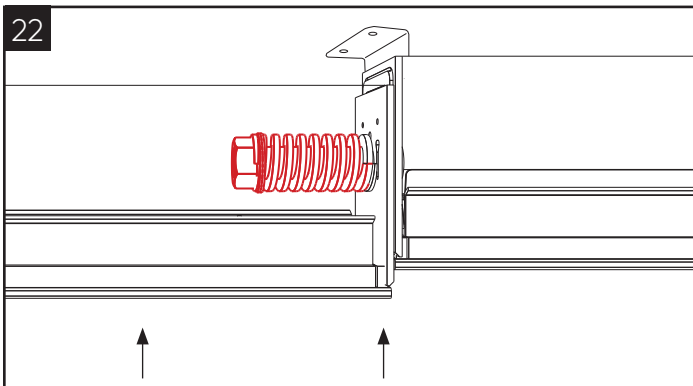

Push upward on the new luminaire to secure it to the previous luminaire

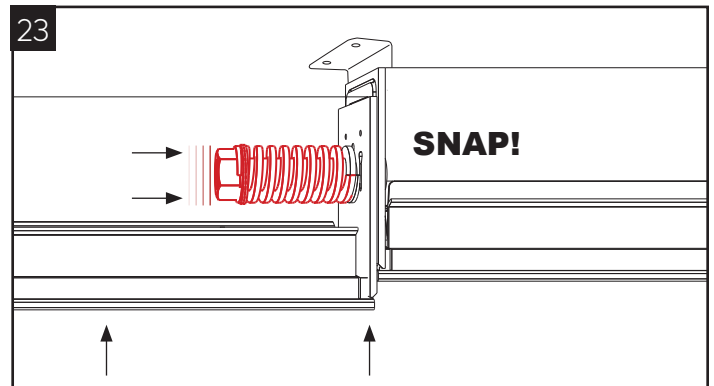

The upward motion will tighten the internal compression spring as the luminaires SNAP together for a secure fit

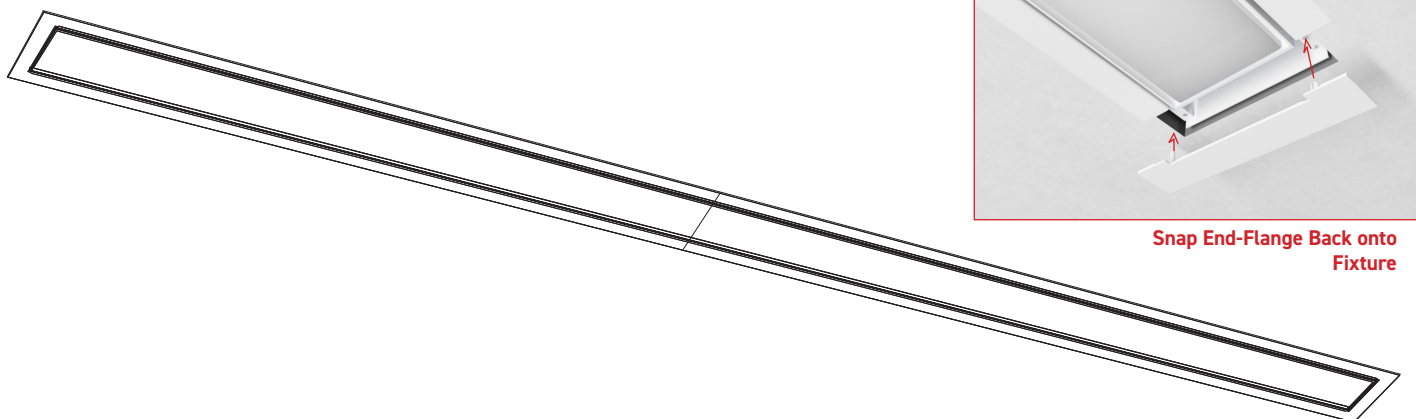

Snap End-Flange Back onto Fixture