

INDIVIDUAL FIXTURES

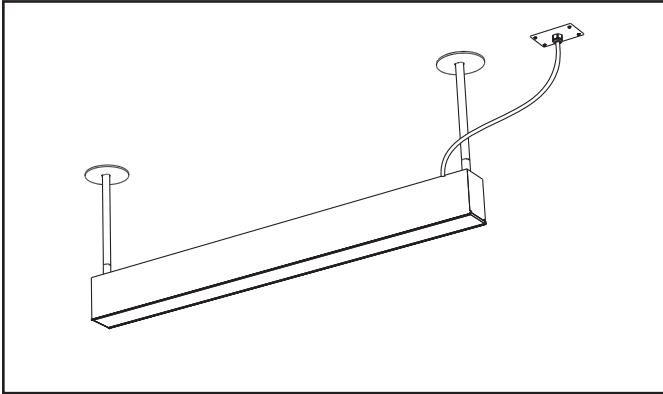

CONTINUOUS ROW FIXTURES

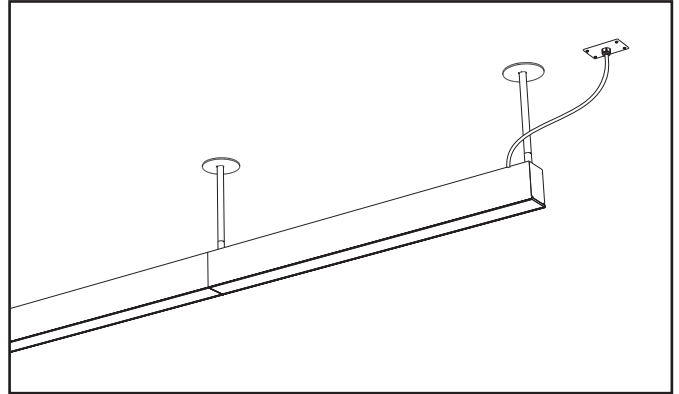

WARNINGS:

- Do not assemble continuous run on the ground and lift into place. Joints will distort and not create a tight fit. Joining hardware will have to be purchased and replaced.
- Risk of electrical shock or fire, disconnect power during installation or servicing. Read all instructions completely before starting installation. Install and wire in accordance to all national and local codes by a certified electrician. Fixture may be sharp, handle with care. Let fixture cool before maintenance.

AVERTISSEMENTS

- Risque d'électrocution ou d'incendie. Déconnectez l'alimentation durant l'installation ou la maintenance. Lisez attentivement toutes les instructions avant de commencer toute installation. Faites installer et câbler selon les normes Nationales et Locales par un électricien certifié. Les installations peuvent être coupantes, à manipuler avec précaution. Laissez refroidir les installations avant une opération de maintenance.

ADVERTENCIA

- Riesgo de descarga eléctrica o un incendio, desconecte la alimentación durante la instalación o servicio. Leer todas las instrucciones completas antes de empujar la instalación. Instalar y cablear en acuerdo a las reglas nacionales y códigos locales por un electricista certificado. El accesorio puede estar agudo, agarre con cuidado deje que el accesorio. Enfriar antes de mantenimiento.

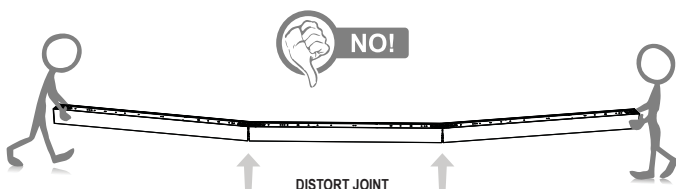

LIGHTING SYSTEM COMPONENTS

INDIVIDUAL LUMINAIRE

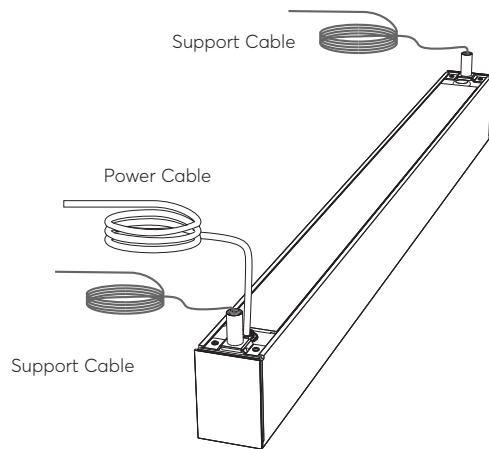

CONTINUOUS LUMINAIRE

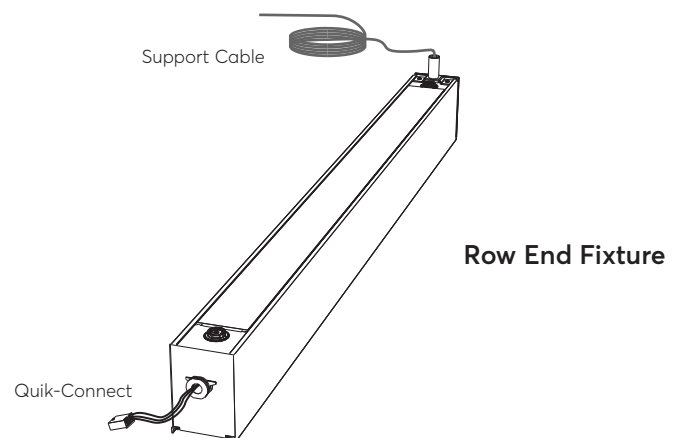
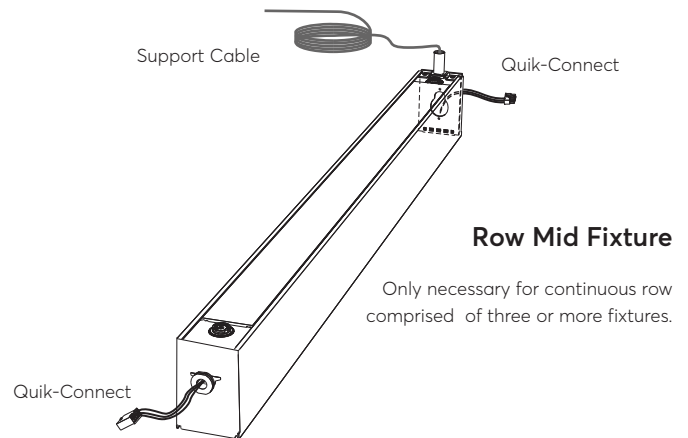
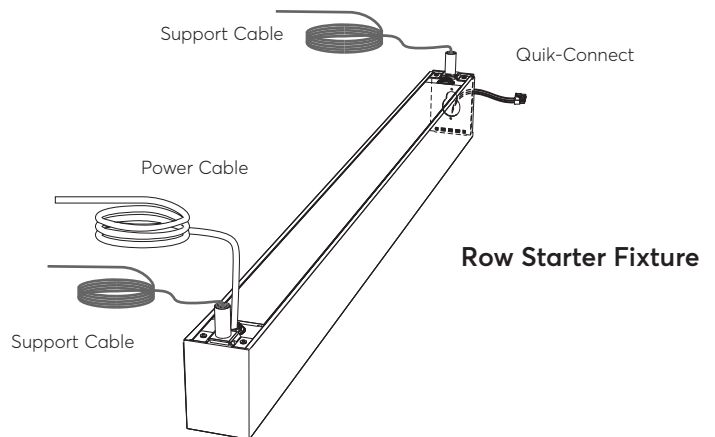

Mounting and Electrical Components

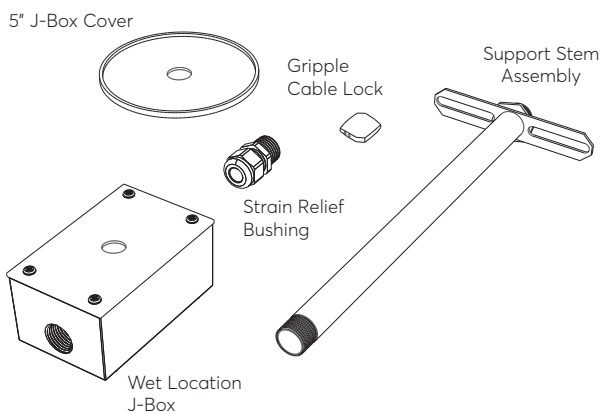

Package Contents

- (2) 5" diameter j-box cover (1 for mid or end fixtures)
- (2) Support stem Assemblies (1 for mid or end fixtures)
- (2) Stainless steel aircraft cable coupler (1 for mid or end fixtures)
- (2) Gripple cable lock (1 for mid or end fixtures)
- (1) Strain relief bushing (for individual or starter only)
- (1) Wet location j-box (for individual or starter only)

***Every luminaire will have an integral driver.

LUMINAIRE INSTALLATION PLANNING

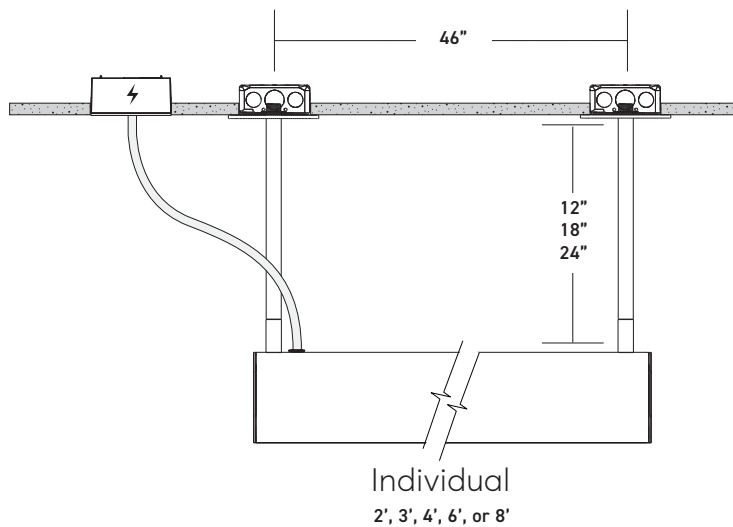
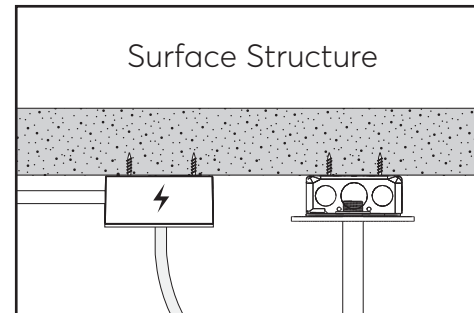
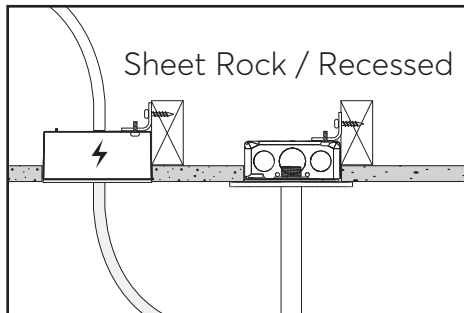

Wet Location J-box
for electrical connection

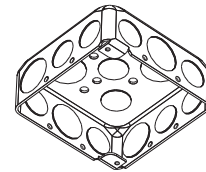
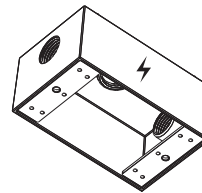

Standard 4x4 J-Box
for support connection

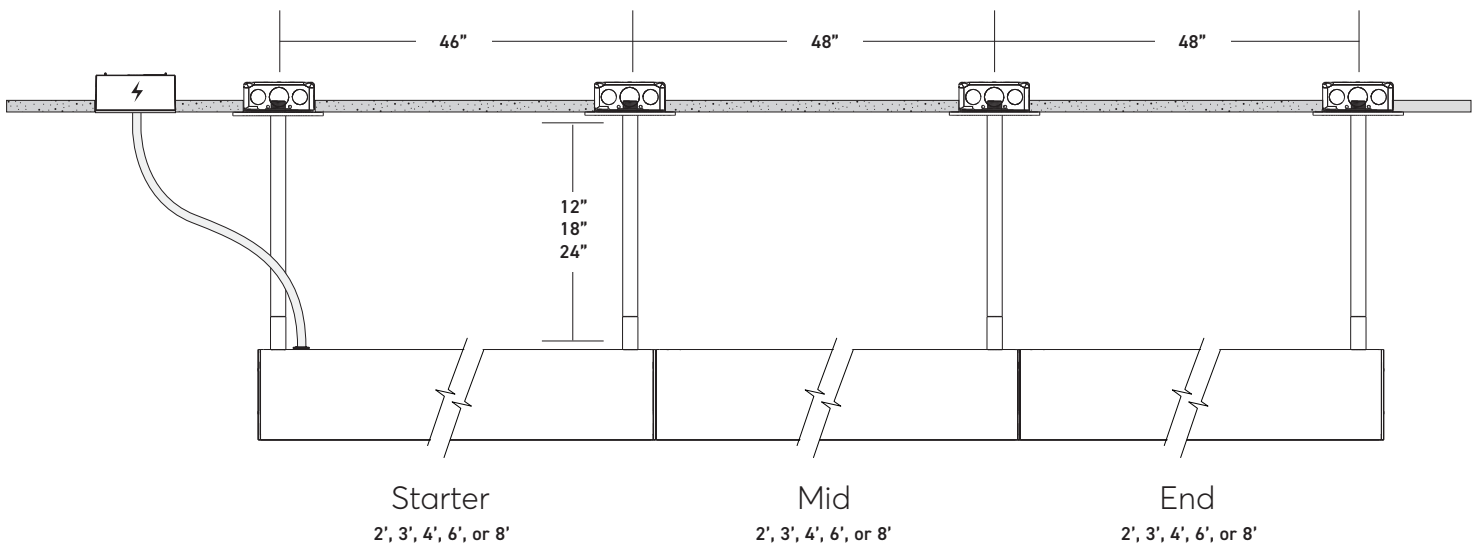

INSTALLING AN INDIVIDUAL OR ROW STARTER LUMINAIRE

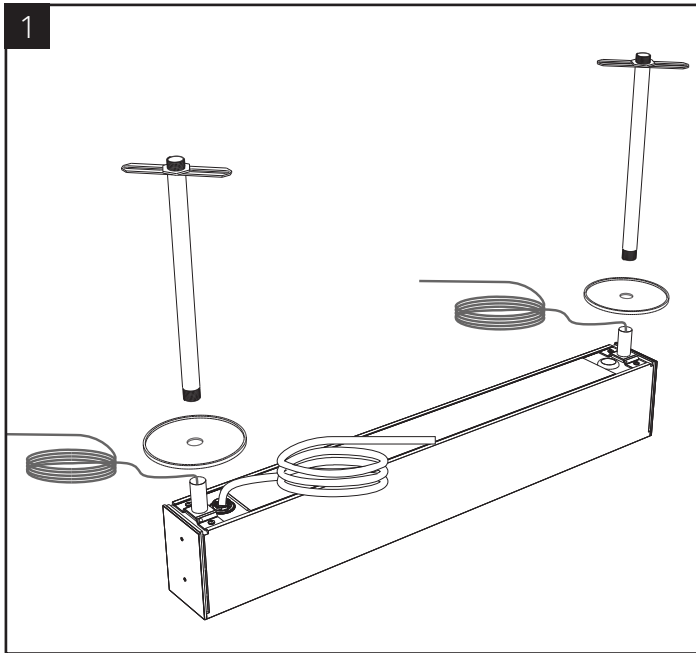

1 Prepare the luminaire for installation

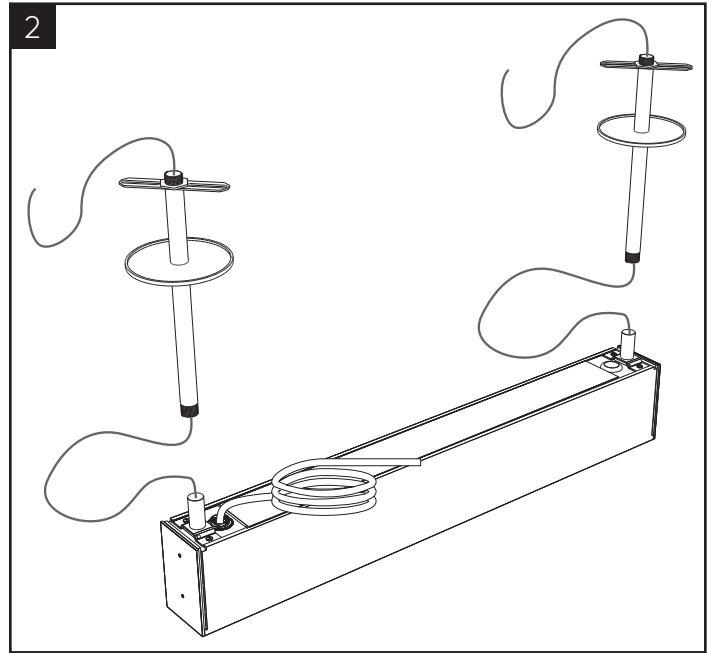

2 Feed the two support cables through the 5" canopies and the support tubes

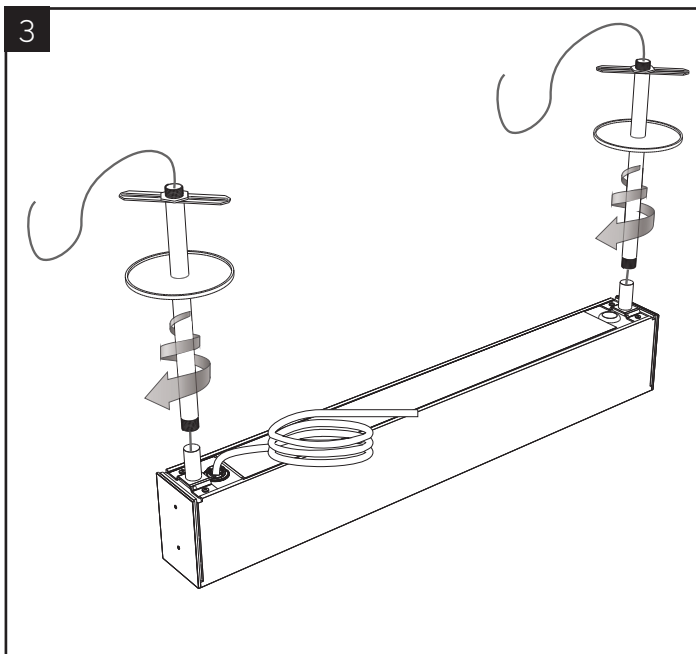

3 Thread the support tubes into the couplers at the top ends of the luminaire

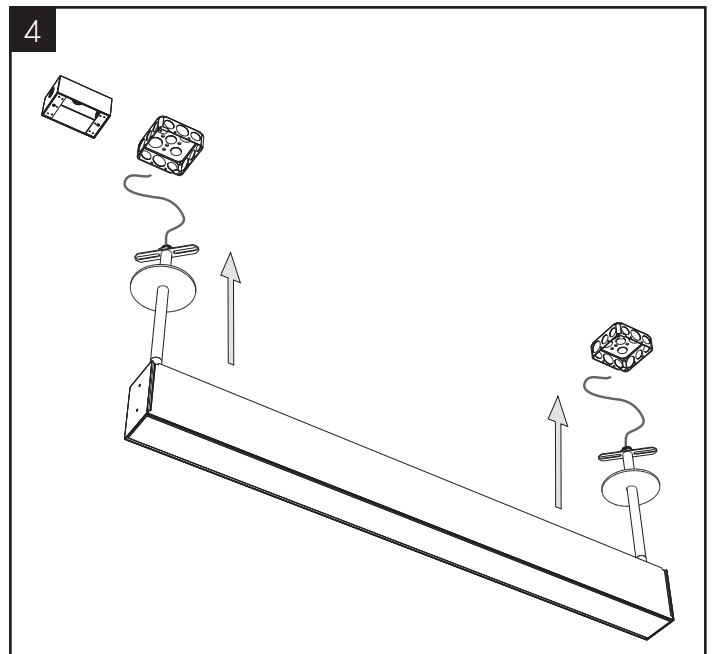

4 Lift luminaire to ceiling for ceiling support connection

INSTALLING AN INDIVIDUAL OR ROW STARTER LUMINAIRE

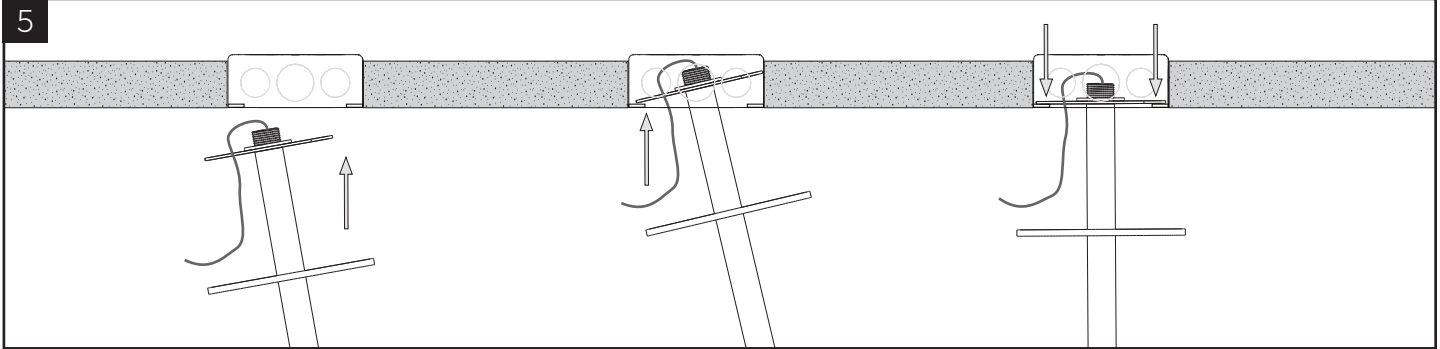

Insert the hanger bracket at the top of the support tube into the junction box (by others) so that it is above the screw tabs. Let the support tube rest on the screw tabs.

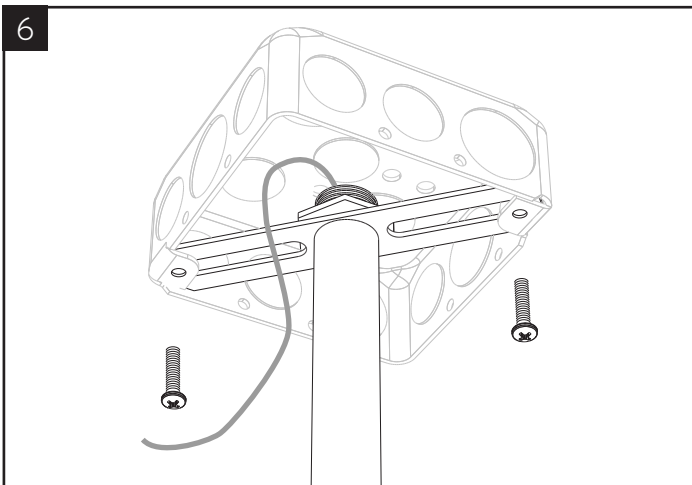

Insert two screws into the screw tabs to secure the support tube assembly

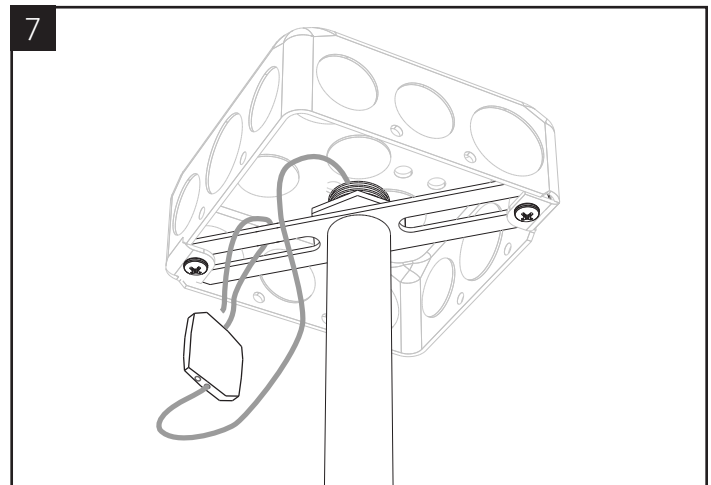

Locate the Gripper cable lock and feed the support cable through the holes as shown

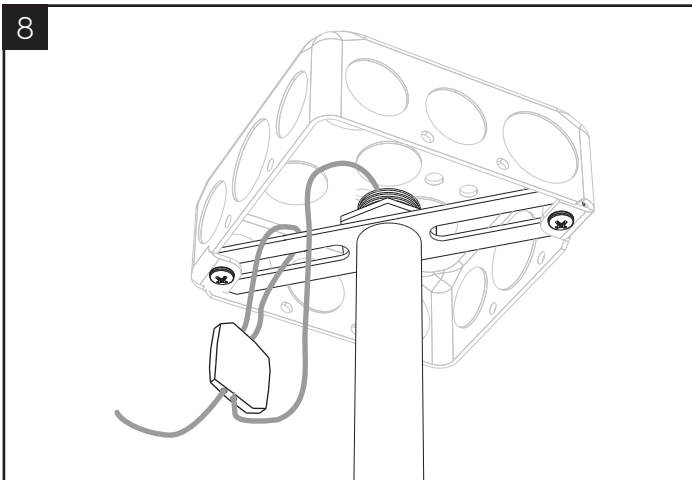

Pull excess cable through the cable lock and trim any excess support cable

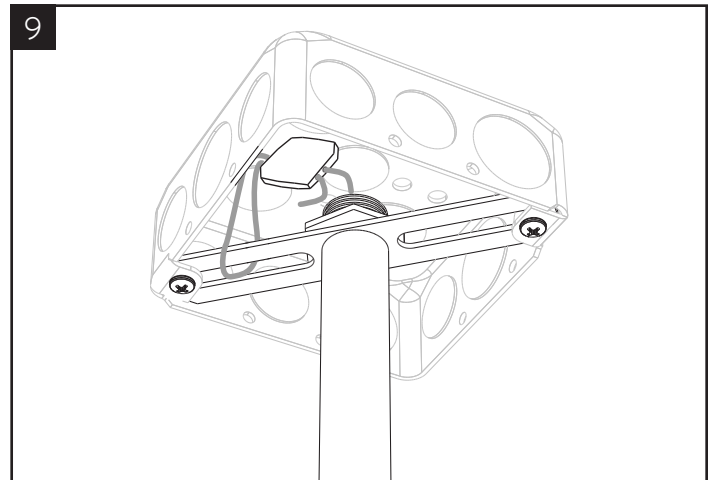

Tuck the cable lock and support cable up into the junction box ensuring no part is hanging below the box opening

INSTALLING AN INDIVIDUAL OR ROW STARTER LUMINAIRE

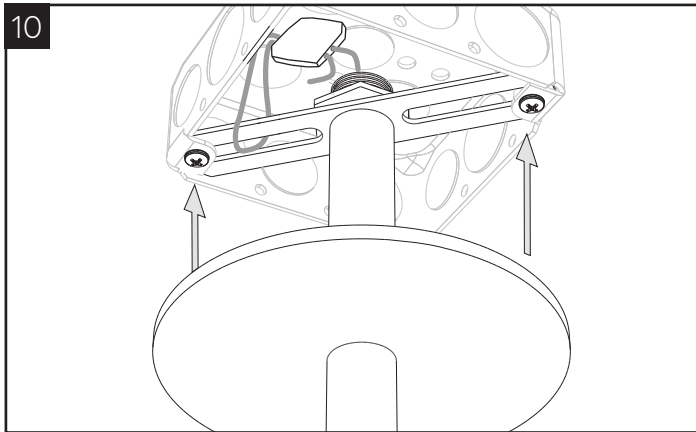

Slide the 5" canopy up the support tube

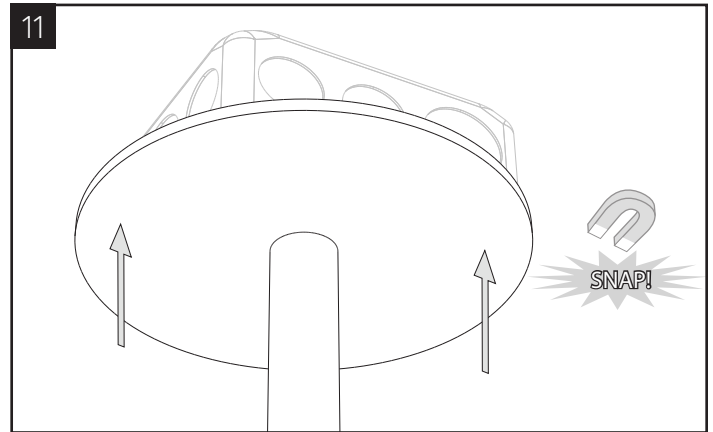

The canopy is secured to the box with magnets. No other hardware is necessary

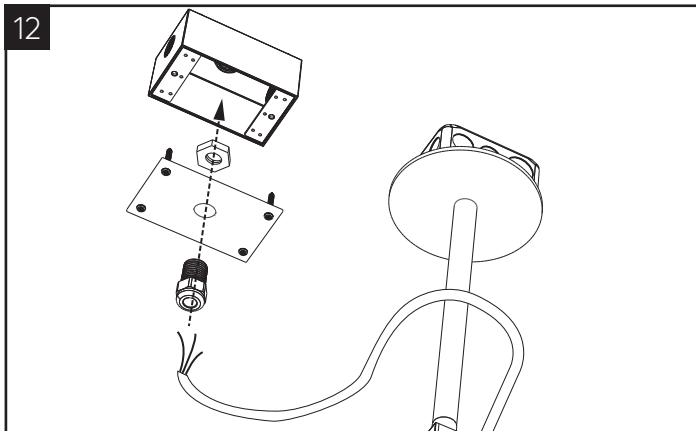

Feed the power cable from the luminaire through the strain relief bushing, wet location j-box cover, and bushing nut

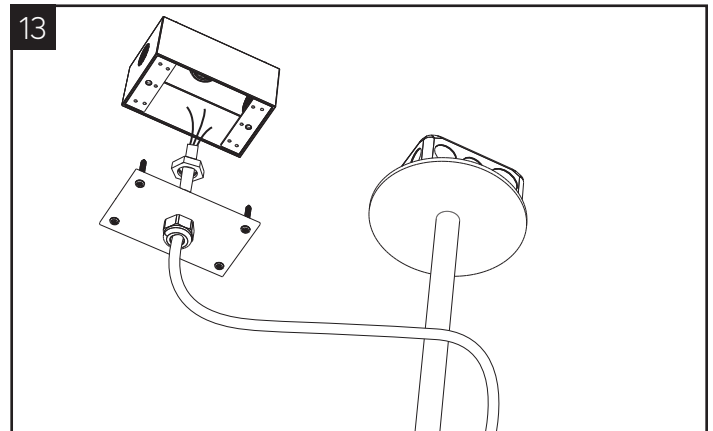

Secure the cable by tightening the bushing nut

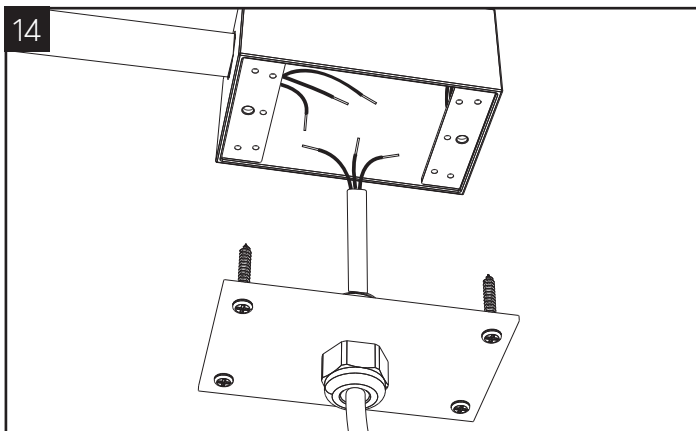

Connect the power wires to line power adhering to all local electrical codes

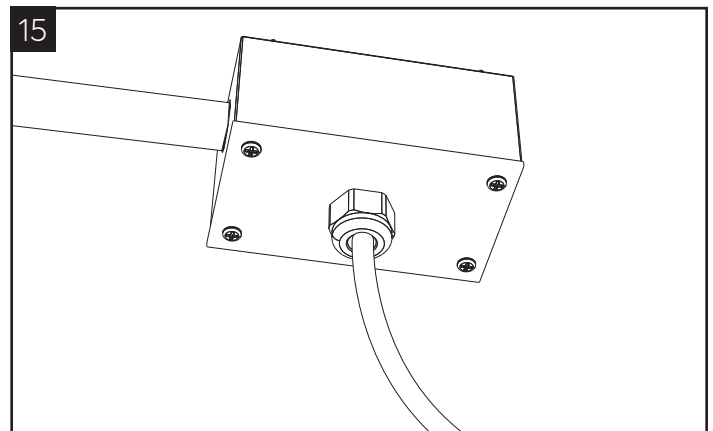

Tuck wire connections into the wet location box and secure the cover

INSTALLING A ROW-MID OR ROW-END

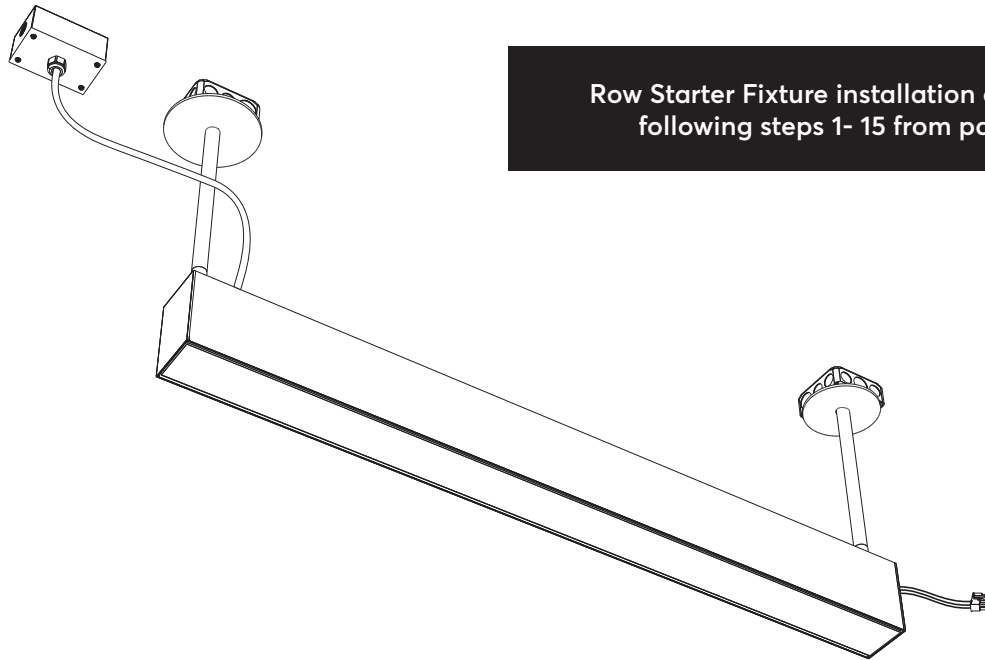

16

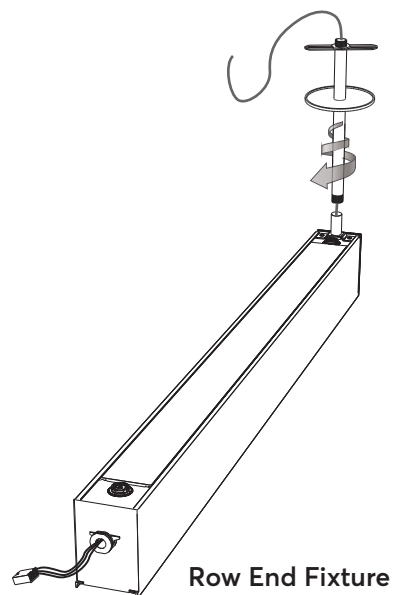
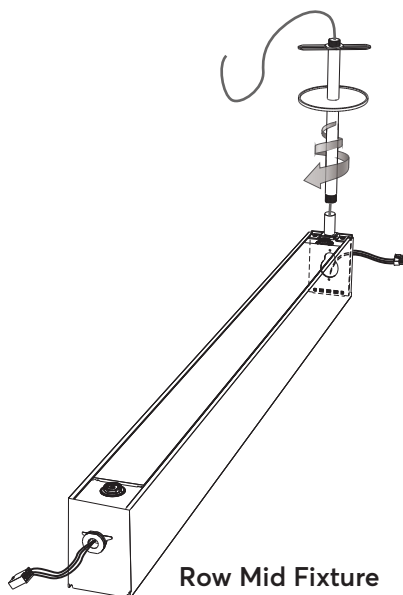

Prepare the next luminaire in the row for installation by following steps 1 - 4 on page 4

INSTALLING A ROW-MID OR ROW-END (AFTER STARTER HAS BEEN INSTALLED, STEP 1-6 FROM PAGE 3, 4, 5, & 6)

After the "starter" is fully secured with two hanging points, then make power connection and mount the next luminaire, then join them together as shown in the steps below.

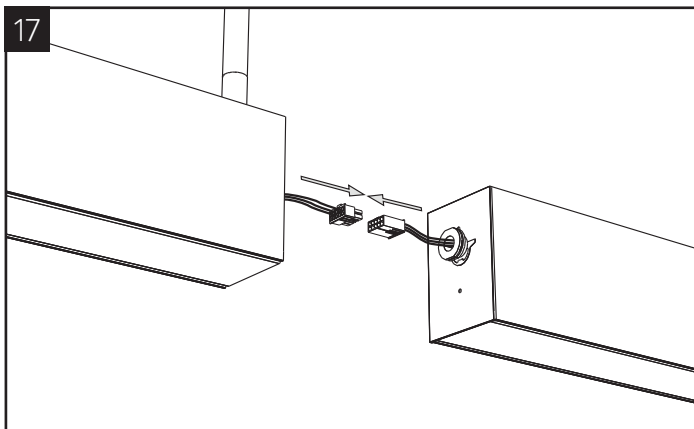
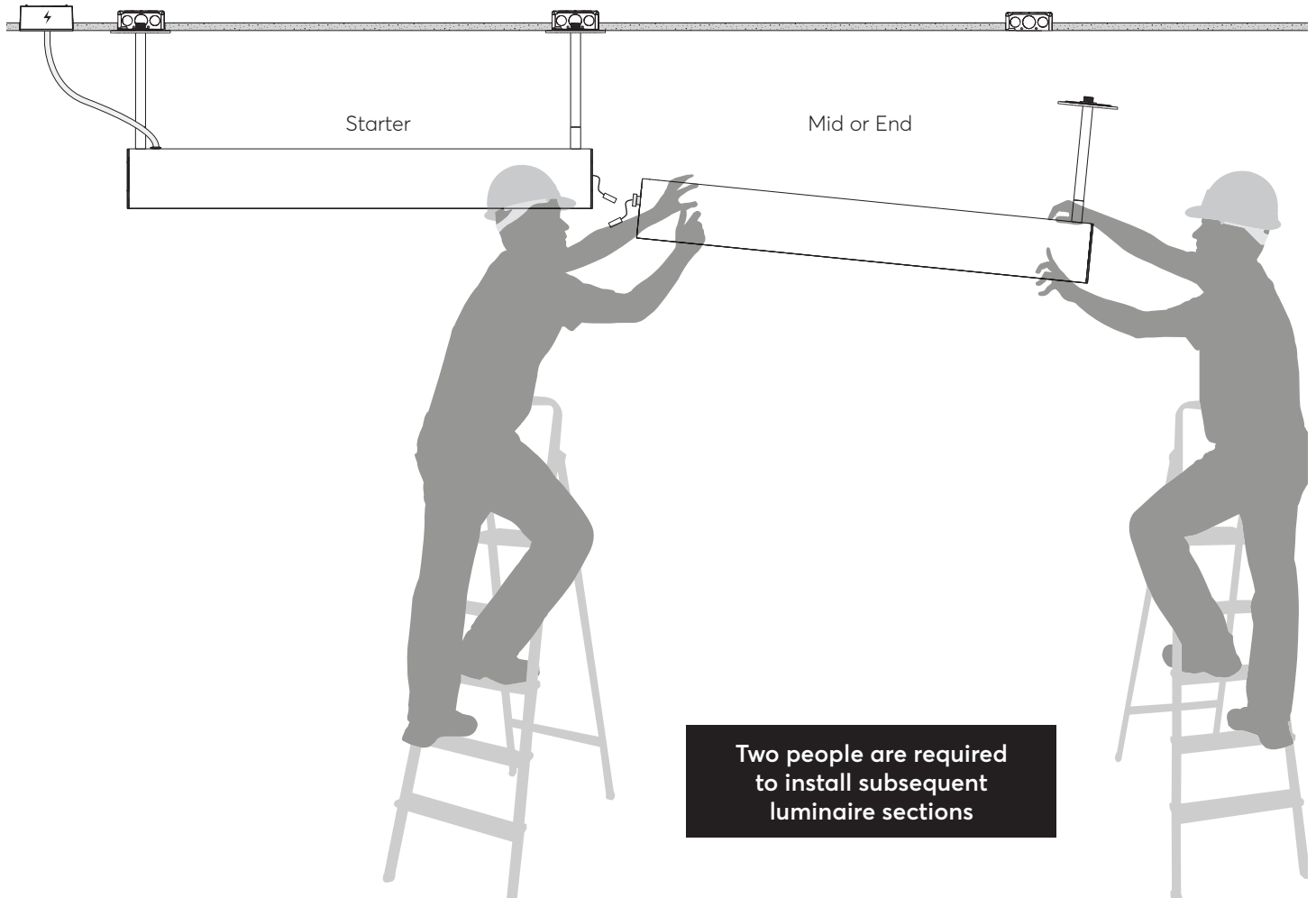

Connect the male and female quick connector to power the next luminaire in the row

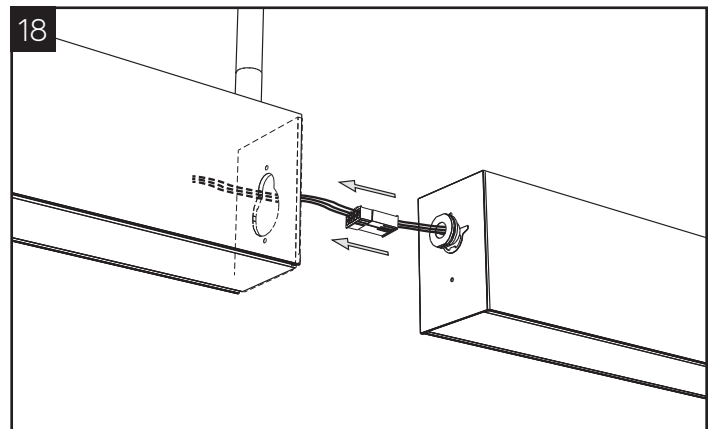

Tuck the wires and connectors into the starter or previous luminaire in the row

INSTALLING A ROW-MID OR ROW-END (AFTER STARTER HAS BEEN INSTALLED, STEP 1 -6 FROM PAGE 3, 4, 5, & 6)

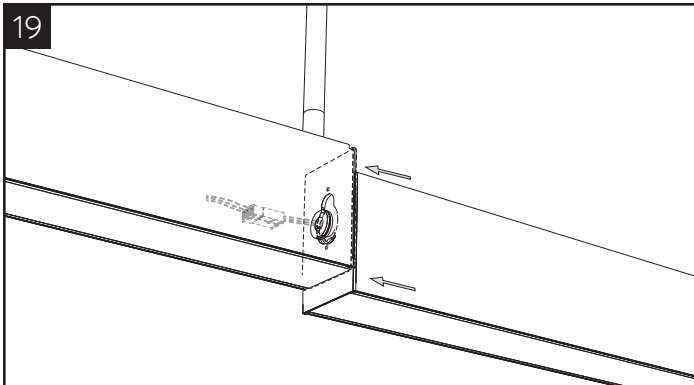

Insert the key stud from the new luminaire into the key hole on the previous luminaire

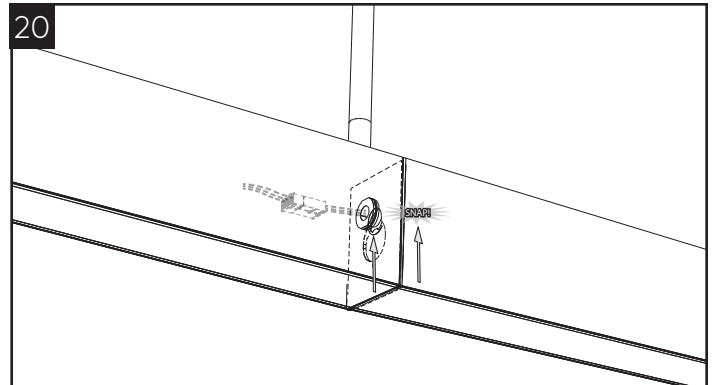

Push up on the new luminaire until the fixtures SNAP together

