

WARNINGS:

- Do not assemble continuous run on the ground and lift into place. Joints will distort and not create a tight fit. Joining hardware will have to be purchased and replaced.
- Risk of electrical shock or fire, disconnect power during installation or servicing. Read all instructions completely before starting installation. Install and wire in accordance to all national and local codes by a certified electrician. Fixture may be sharp, handle with care. Let fixture cool before maintenance.

AVERTISSEMENTS:

- Risque d'électrocution ou d'incendie. Déconnectez l'alimentation durant l'installation ou la maintenance. Lisez attentivement toutes les instructions avant de commencer toute installation. Faites installer et câbler selon les normes Nationales et Locales par un électricien certifié. Les installations peuvent être coupantes, à manipuler avec précaution. Laissez refroidir les installations avant une opération de maintenance.

ADVERTENCIA:

- Riesgo de descarga eléctrica o un incendio, desconecte la alimentación durante la instalación o servicio. Leer todas las instrucciones completas antes de empezar la instalación. Instalar y cablear en acuerdo a las reglas nacionales y códigos locales por un electricista certificado. El accesorio puede estar agudo, agarre con cuidado deje que el accesorio. Enfriar antes de mantenimiento.

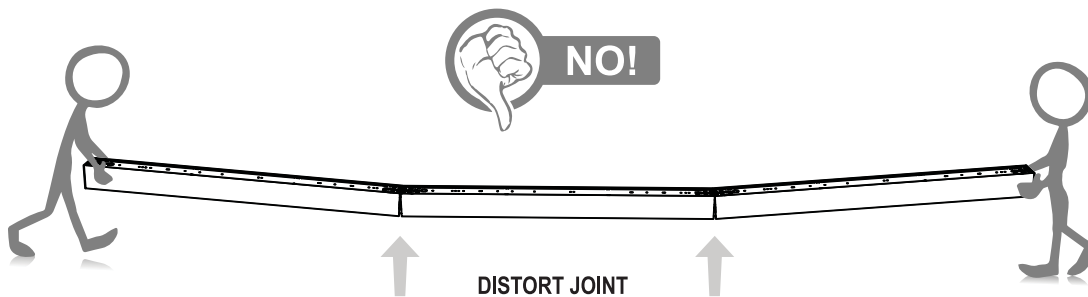

CEILING MOUNTING DETAILS

Inaccessible Ceilings (Sheet Rock Typical)

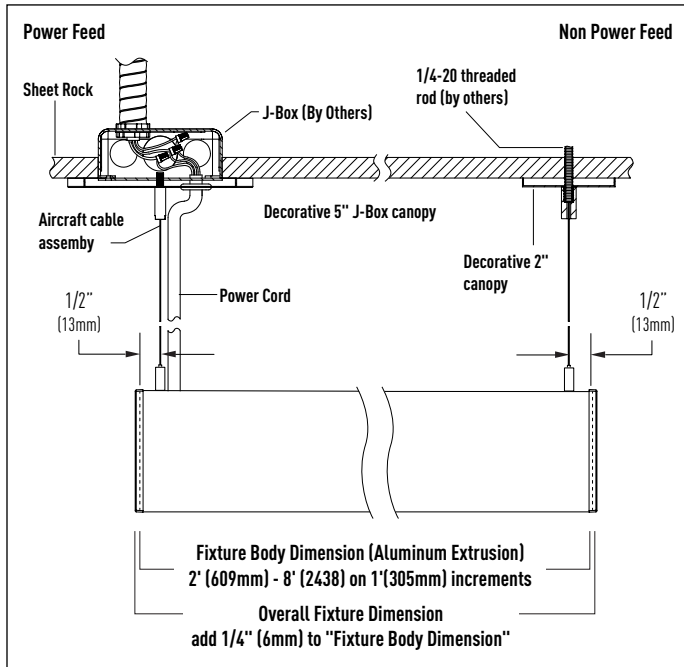

Acoustical Tile Grid Ceilings

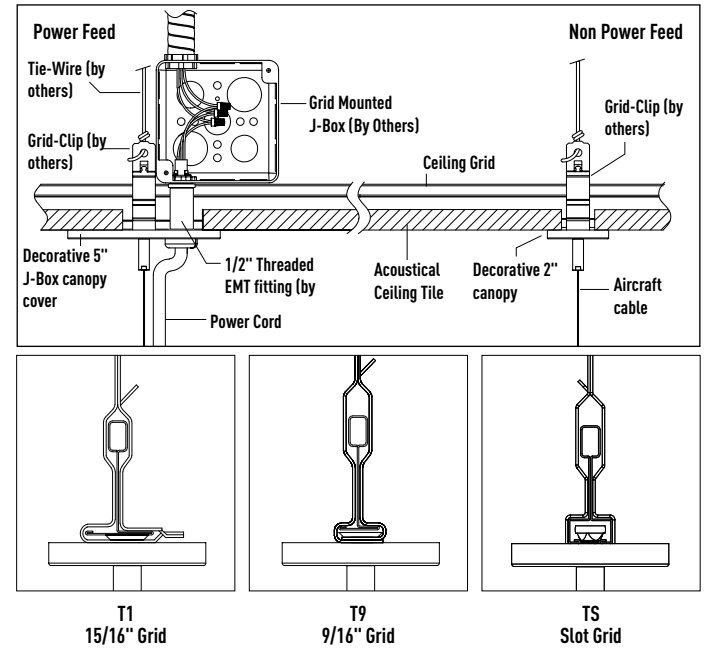

ROW LAYOUT DETAILS

REFERENCE DIMENSIONS FOR AIRCRAFT CABLE FIXTURE SUSPENSION MOUNTS

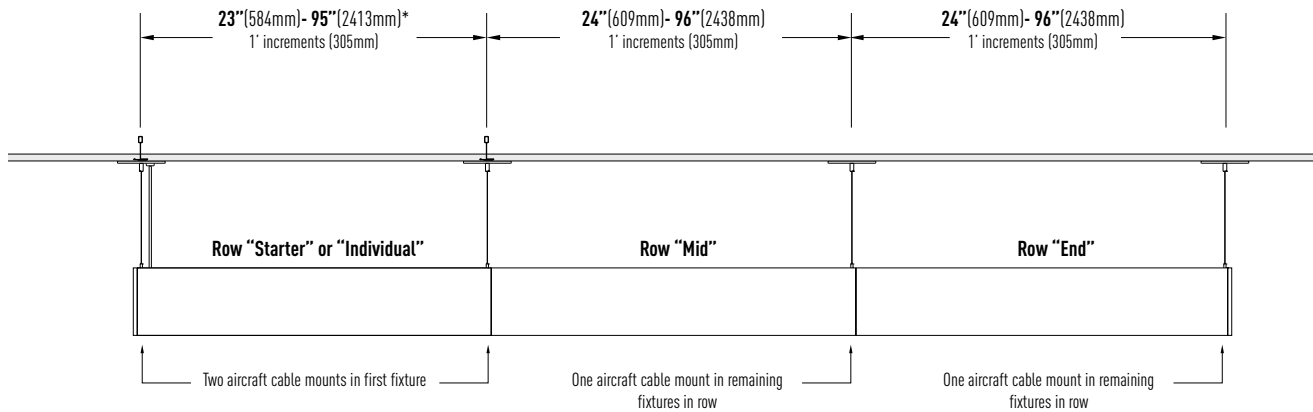

LIGHTING SYSTEM COMPONENTS

1. LUMINAIRE

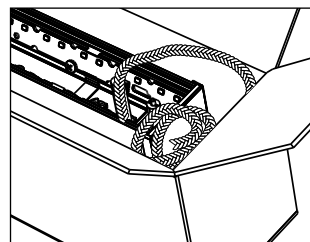
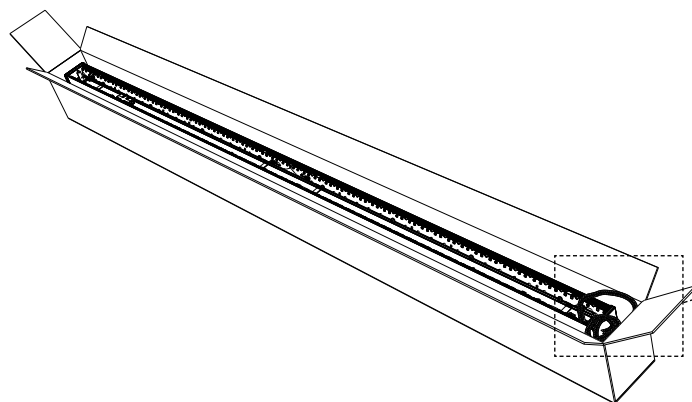

Package Contents

- Luminaire
- Includes factory installed 5 conductor line voltage power cord
(48" Aircraft Cable = 78" Power Cord
120" Aircraft Cable = 150" Power Cord)
- Includes factory installed aircraft cable adjuster(s)

Grid Ceiling Power Mount Hardware Pack

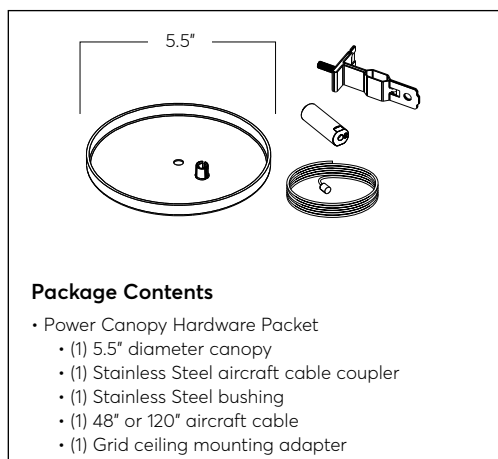

Package Contents

- Power Canopy Hardware Packet
 - (1) 5.5" diameter canopy
 - (1) Stainless Steel aircraft cable coupler
 - (1) Stainless Steel bushing
 - (1) 48" or 120" aircraft cable
 - (1) Grid ceiling mounting adapter

Sheet Rock or Surface Structure Ceiling Power Mount Hardware Pack

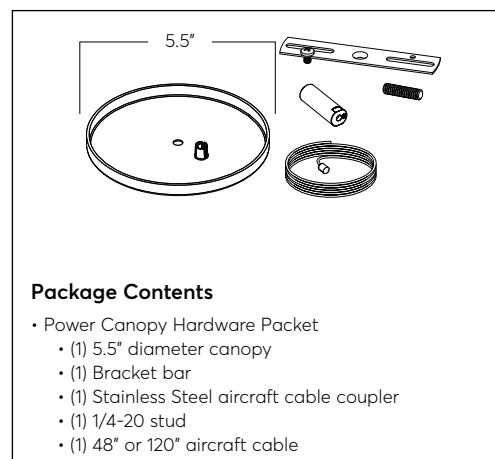

Package Contents

- Power Canopy Hardware Packet
 - (1) 5.5" diameter canopy
 - (1) Bracket bar
 - (1) Stainless Steel aircraft cable coupler
 - (1) 1/4-20 stud
 - (1) 48" or 120" aircraft cable

Grid Ceiling Non-Power Mount Hardware Pack

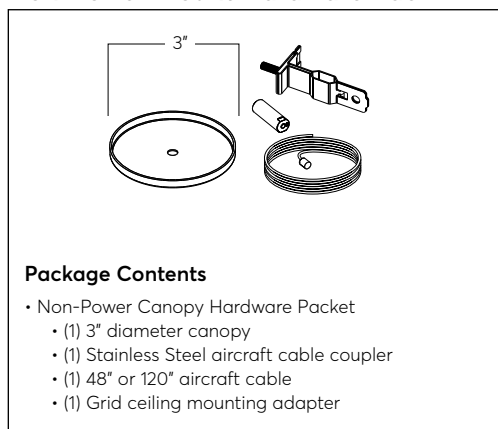

Package Contents

- Non-Power Canopy Hardware Packet
 - (1) 3" diameter canopy
 - (1) Stainless Steel aircraft cable coupler
 - (1) 48" or 120" aircraft cable
 - (1) Grid ceiling mounting adapter

Sheet Rock or Surface Structure Ceiling Non-Power Mount Hardware Pack

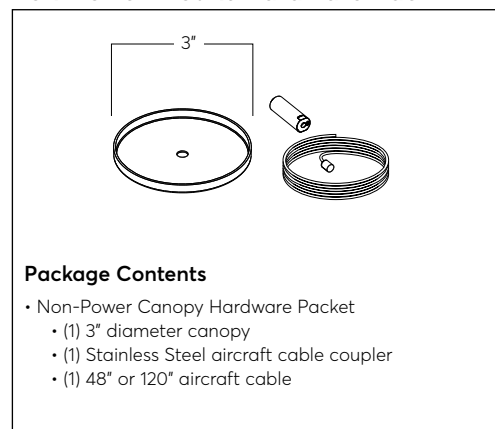

Package Contents

- Non-Power Canopy Hardware Packet
 - (1) 3" diameter canopy
 - (1) Stainless Steel aircraft cable coupler
 - (1) 48" or 120" aircraft cable

INSTALLING AN INDIVIDUAL OR ROW STARTER LUMINAIRE FOR GRID CEILING

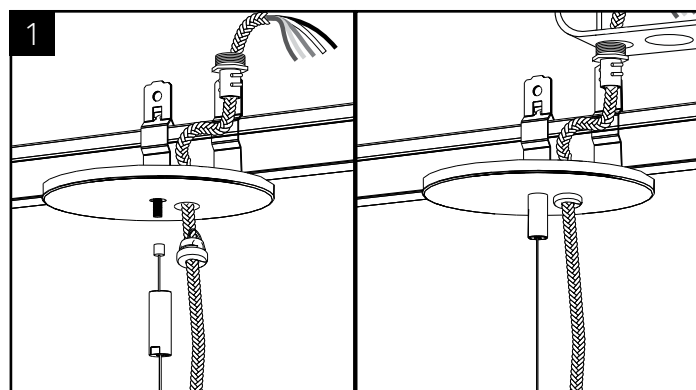
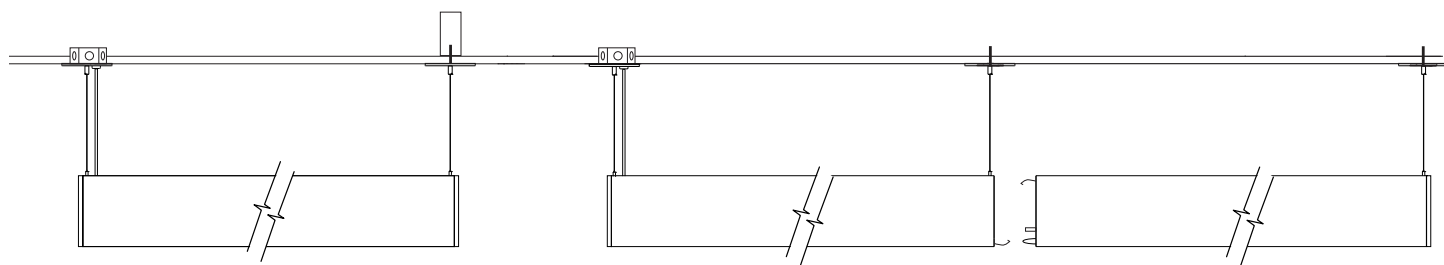

Install power mount canopy.

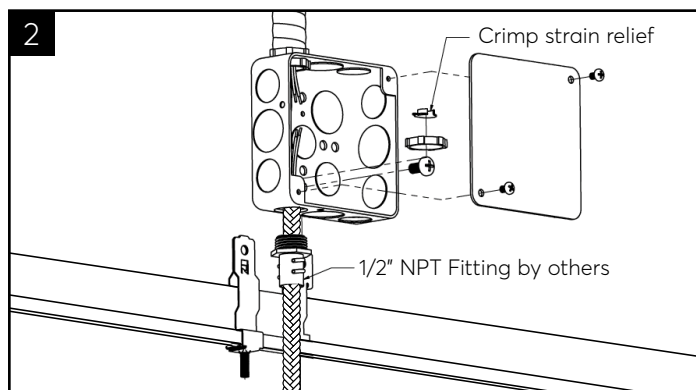

Connect wires per local electrical code.

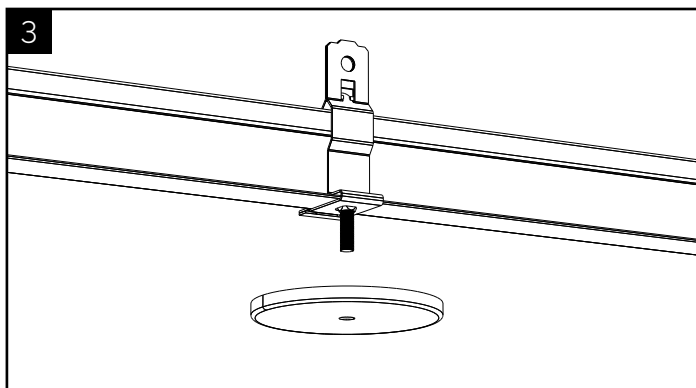

Install non-power mount canopy.

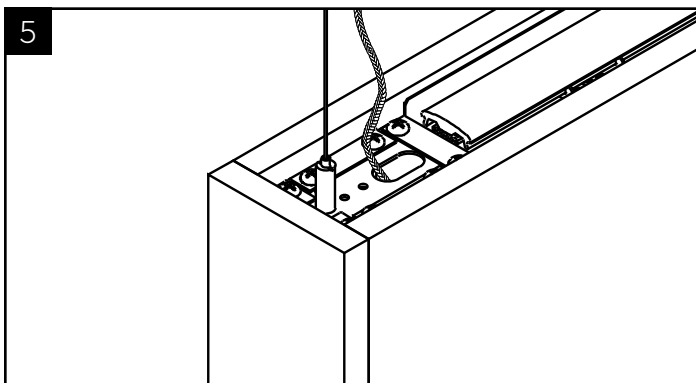
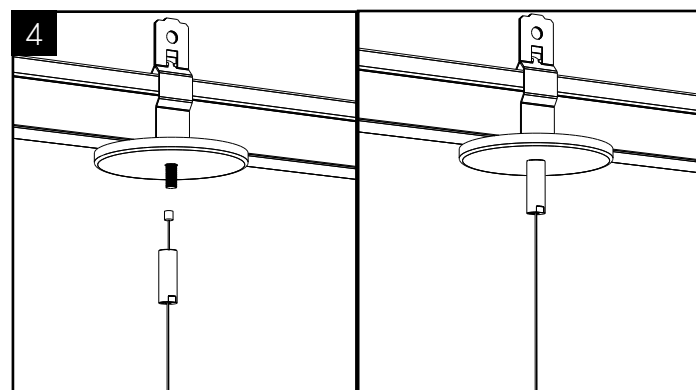

Thread aircraft cable supports through adjuster on luminaire (level and trim cable as last step).

INSTALLING AN INDIVIDUAL OR ROW STARTER LUMINAIRE FOR SHEET ROCK

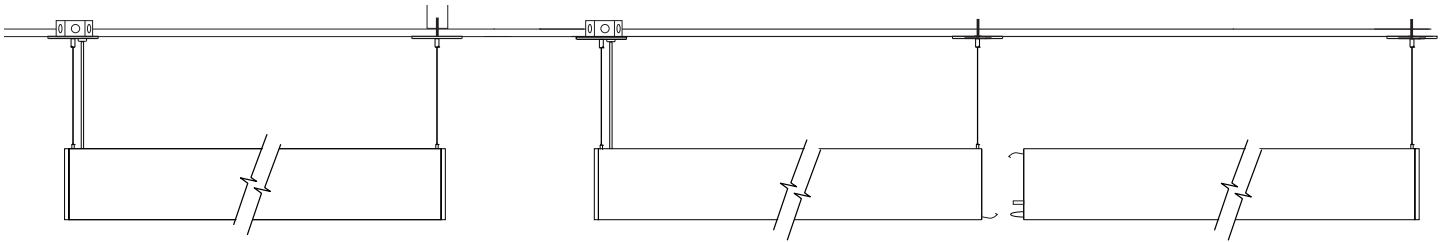

Individual

Starter

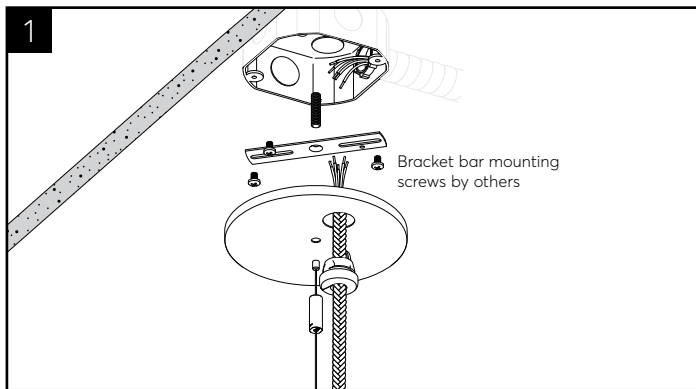

Connect wires per local electrical code.

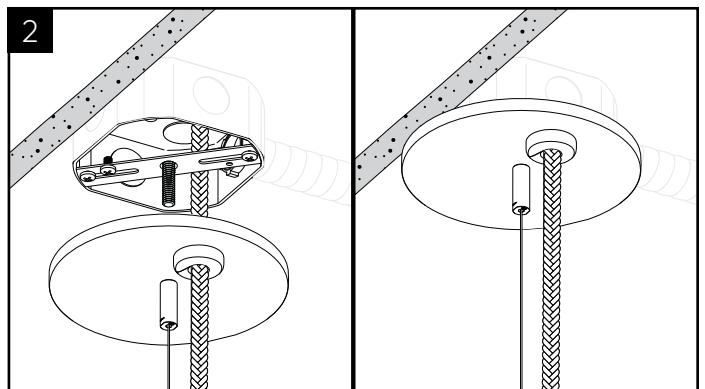

Install power mount canopy.

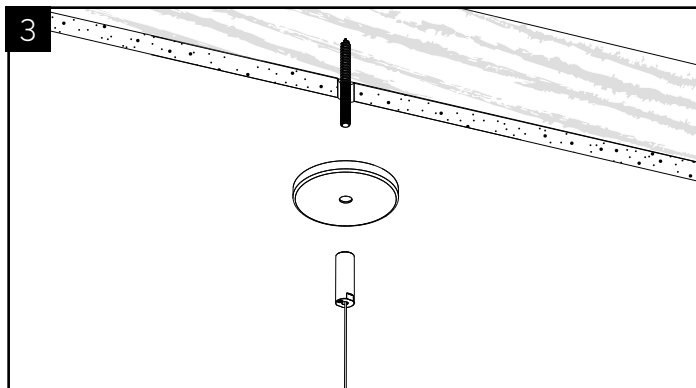

Attach non-power canopy, aircraft cable and coupler to structure, 1/4 -20 hardware by others.

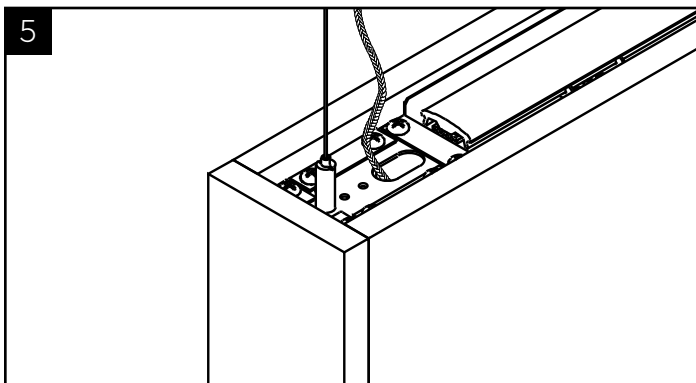
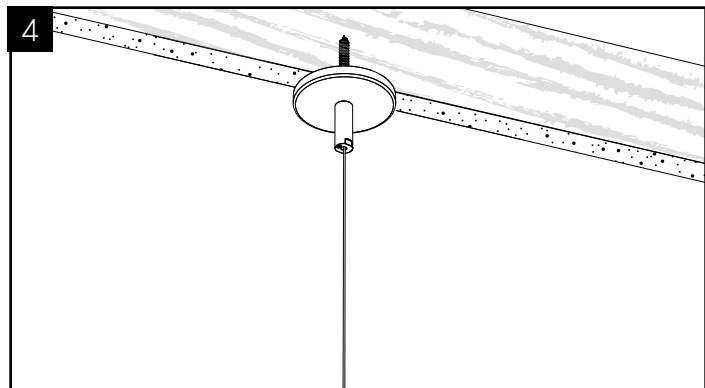

Thread aircraft cable supports through adjuster on luminaire (level and trim cable as last step).

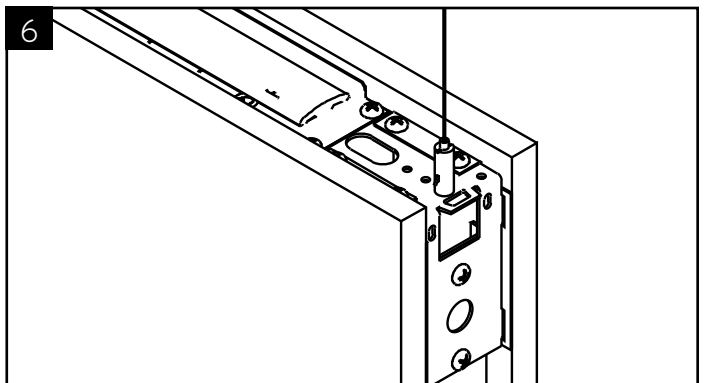

INSTALLING AN INDIVIDUAL OR ROW STARTER LUMINAIRE FOR SURFACE STRUCTURE

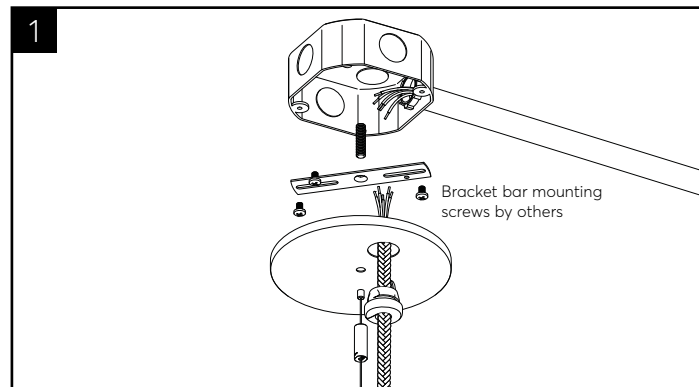
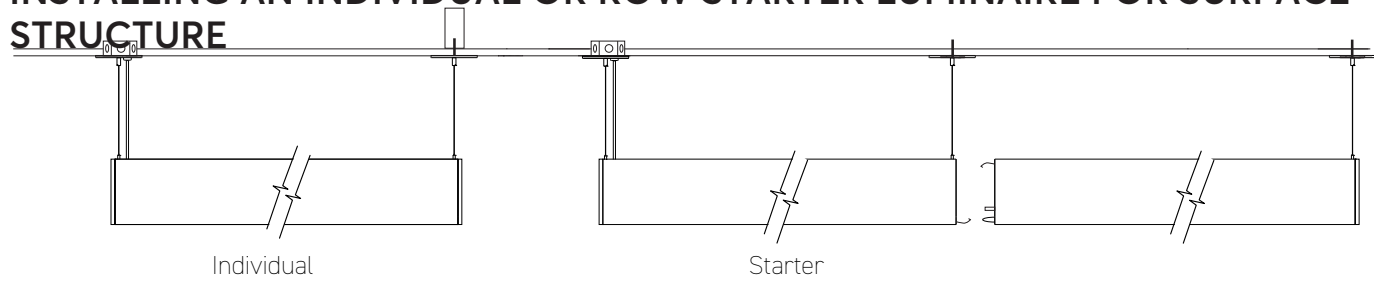

Connect wires per local electrical code.

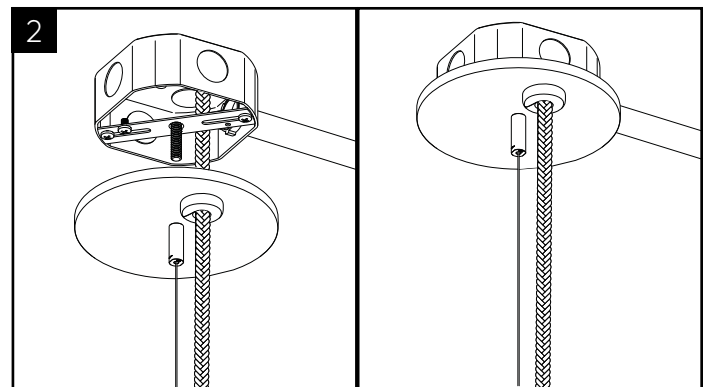

Install power mount canopy.

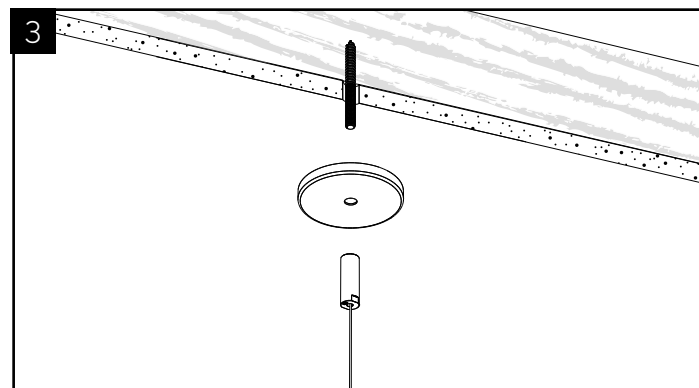

Attach non-power canopy, aircraft cable and coupler to structure, 1/4 -20 hardware by others.

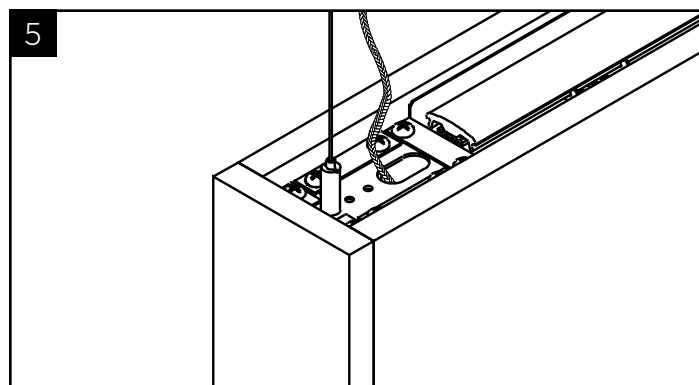
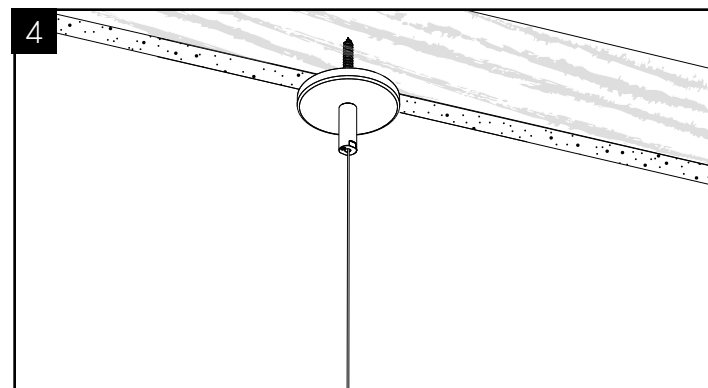

Thread aircraft cable supports through adjuster on luminaire (level and trim cable as last step).

INSTALLING A ROW-MID OR ROW-END

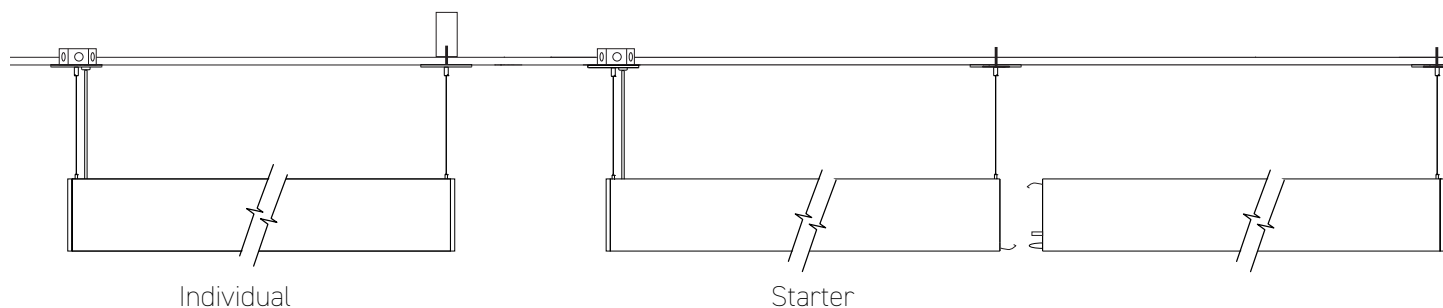

2 cable mounts in first fixture, only one cable mount in each subsequent fixture

Repeat steps 3-6 from pages 3, 4, or 5 to install the next non-power hanging point in the row.

INSTALLING A ROW-MID OR ROW-END (AFTER STARTER HAS BEEN INSTALLED, STEP 1-6 FROM PAGE 3, 4, OR 5)

After the "starter" or "mid" is fully secured with two hanging points, then make power connection and mount the next luminaire, then join them together as shown below and secure with two torsion spring latches that are integrated into the luminaire.

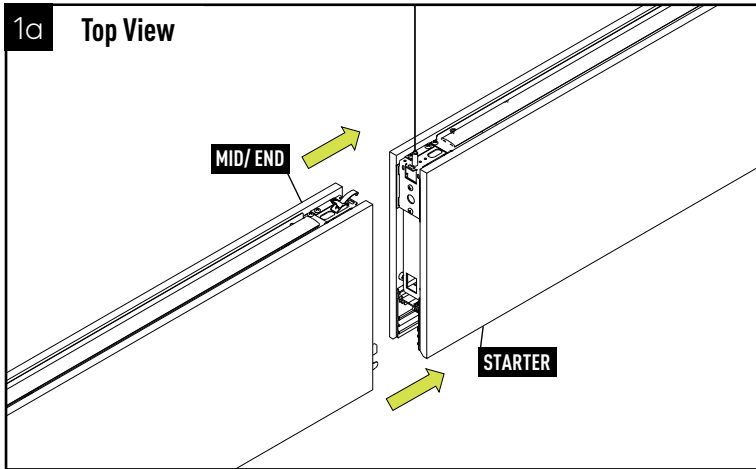

Align mid fixture with aligner-tabs in start fixture

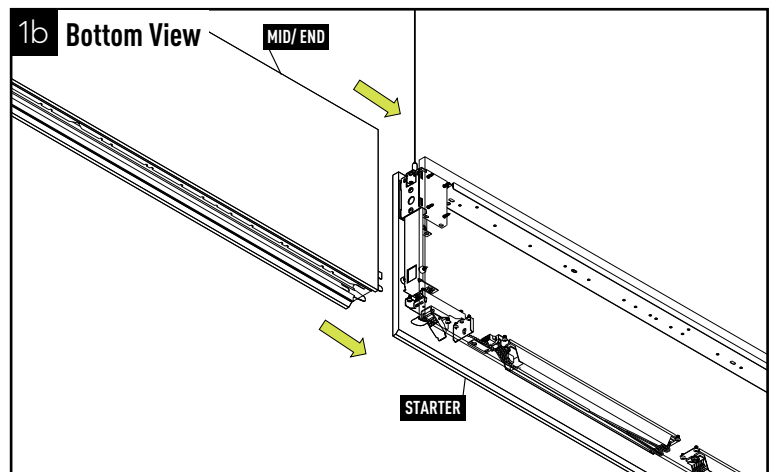

Align mid fixture with aligner-tabs in start fixture

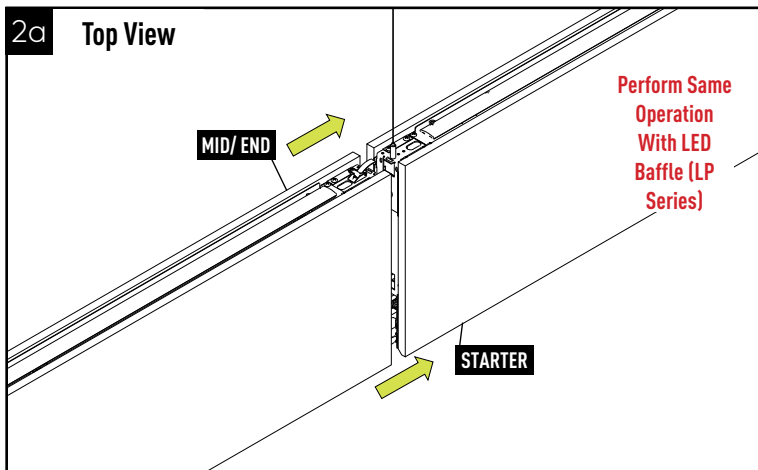

Slide fixtures together

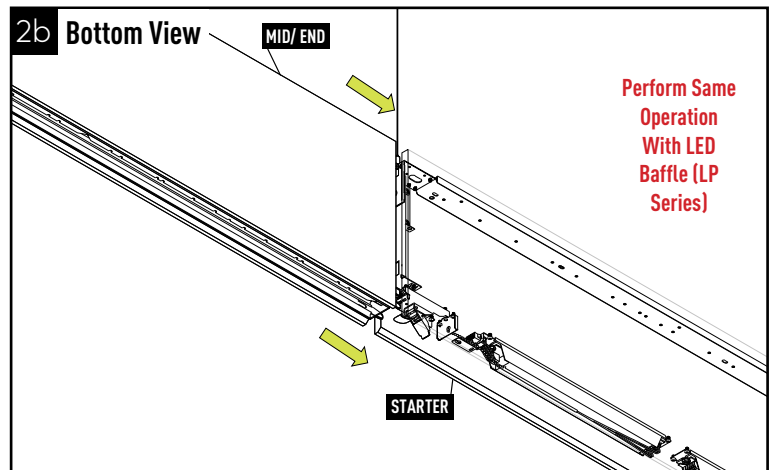

Slide fixtures together

INSTALLING A ROW-MID OR ROW-END (AFTER STARTER HAS BEEN INSTALLED, STEP 1 -6 FROM PAGE 3, 4, OR 5)

After the "starter" or "mid" is fully secured with two hanging points, then make power connection and mount the next luminaire, then join them together as shown below and secure with two torsion spring latches that are integrated into the luminaire.

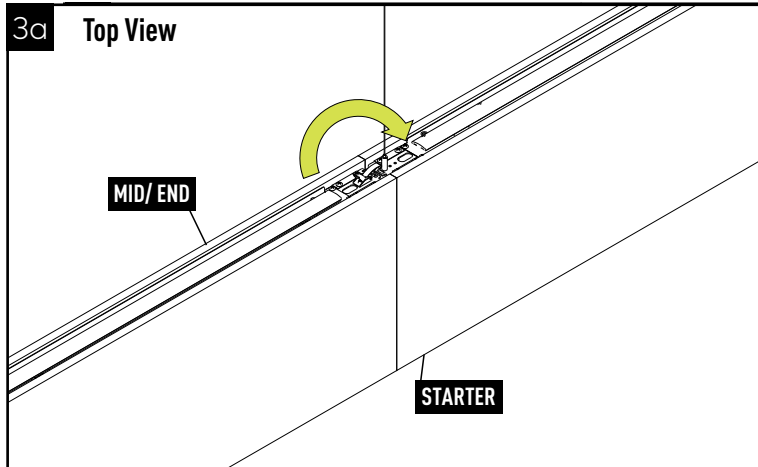

Rotate top joining-buckle into slot

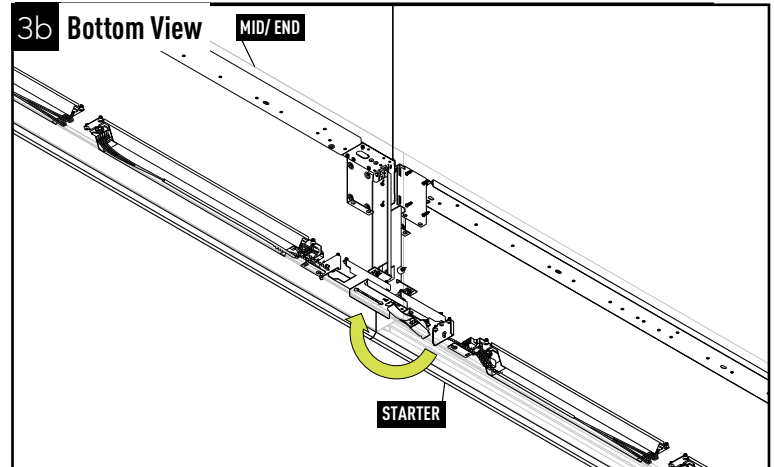

Rotate bottom joining-buckle into slot

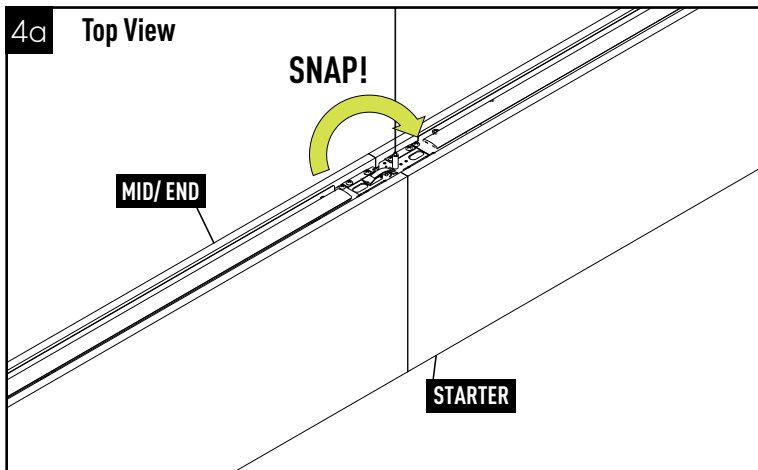

Snap top buckle for final fixture engagement

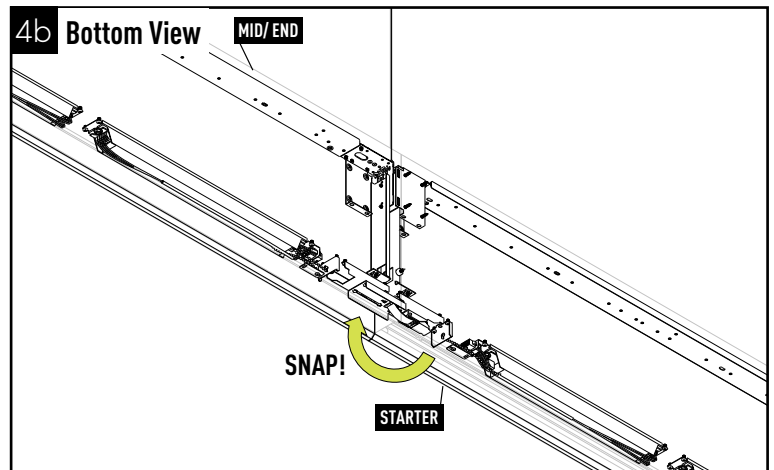

Snap bottom buckle for final fixture engagement

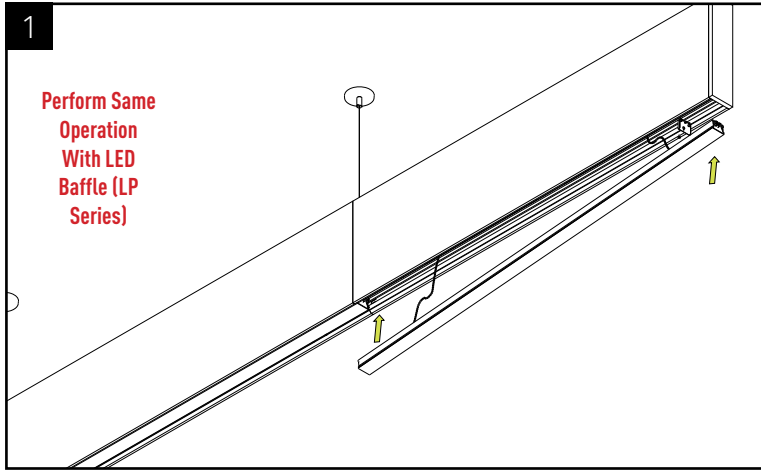

Reinstall light engines

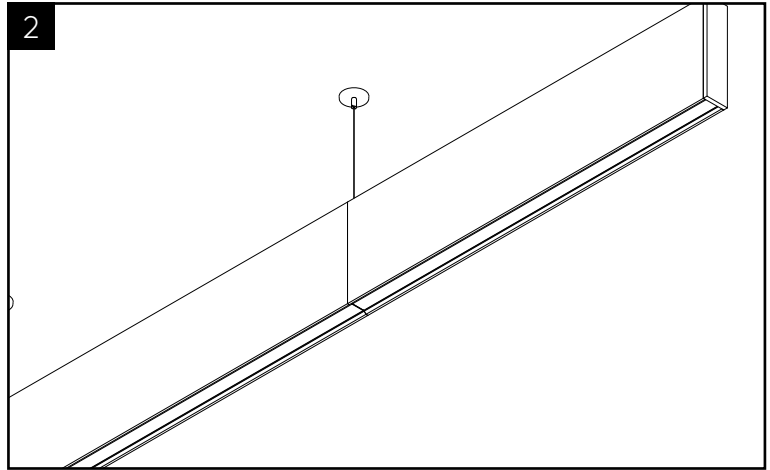

Completed row

