



Type:	Project:	Qty:
	Date:	
Catalog #:		

Description:

The Nulite INT LED is an ideal solution for lighting cold storage, food processing, parking garages, open exterior structures, commercial and industrial applications. The luminaire housing is NSF certified.

Specifications:

Construction: Rugged corrosion resistant white housing is comprised of fiberglass, continuous closed cell gasket, ribbed acrylic diffuser, toggle latches and end plugs.

Diffuser: Ribbed frosted impact resistant acrylic. Optional smooth, impact resistant acrylic, curved frosted lens (4' only).

Reflector / Driver: Driver cover/reflector is formed of 20 gauge cold rolled steel with a white powder coat finish. Constant current driver with 0-10V dimming input. Universal (UNV) voltage is from 120 - 277V, 50/60 Hz.

LED Module: Distributed LED array in a variety of lumen output packages. LED color is available in (L35) 3500K, (L40) 4000K or (L50) 5000K. Module is replaceable. L90 ≥ 100,000 hours.

Mounting: Pair of stainless steel mounting brackets included.

Labels: ETL listed Wet location, conforms to UL Standard 1598 / 8750 and CSA Standard C22.2, NSF/ANSI Standard 2, NEMA 4X, IP 66 & IP67 rated.

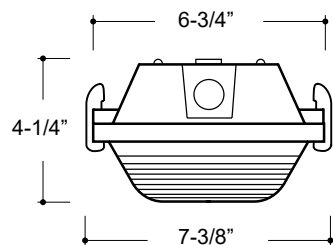

Nominal Length	Actual Length
2'	28"
4'	52"
8'	100"

Maximum Ambient Operating Temp. per Lumen Package

Nominal 2'
25 (126° F)
50 (89° F)
Nominal 4'
50 (126° F)
100 (76° F)
Nominal 8'
100 (124° F)
200 (77° F)

Optional Smooth Curved Frosted Lens (CFR)

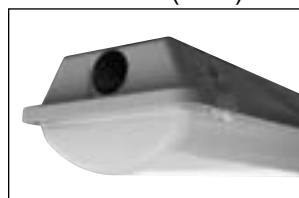

Ordering Information

Sample: INT-4-50L40-UNV-DIM-HE

Series	Length	Lumen Package ² / LED Color		Voltage	Driver	Options	
INT							
	2 ¹	Nominal 2'	L35	UNV	DIM ³ Dimming	CFR Curved Frosted Lens (Nominal 4' Lens Only)	OS65 Occupancy Sensor IP65 (Refer to technical page for distribution)
	4 ¹	25 (~ 2423 lm @ 20W)	L40	120	SD Step Dimming	SJT/6 ⁴ 6' SJT Cord	
	8	50 (~ 4845 lm @ 40W)	L50	277		CP3/6 ⁴ 6' SJT Cord Plug	
		Nominal 4'				CP3/6 (NEMA) ⁴ 6' SJT Cord - (NEMA Plug Designation) ie. CP3/6-(L7-20)	SSL Optional Stainless Steel Latches
		50 (~ 4845 lm @ 40W)					HE (1) 1/2" End Hub Entry (Factory Installed)
		100 (~ 9690 lm @ 80W)					
		Nominal 8'				EM ⁵ Emergency Battery	TP Tamper Option (Screws for Latches)
		100 (~ 9690 lm @ 80W)					
		200 (~ 19380lm @ 160W)					

Notes:

1. INT-2-25L40..., INT-4-50L40... & INT-4-100L40... are DesignLights Consortium™ Qualified, refer to www.designlights.org.
2. Approximate delivered lumens, consult factory for more lumen packages.
3. 0-10V Dimming inputs, consult factory for more information.
4. Luminaire is listed for Damp Location for this option. Consult factory for Wet Location with cord.
5. Emergency battery pack available in nominal 500, 700 and 1200 lumens. 1200 not available in 2' unit. Use EM(500), EM(700) or EM(1200) as the ordering code.



Specifications and dimensions are subject to change without notification. Specification sheets on our website supersede all other versions. 2016 Rev. E1
Nulite reserves the right to bulk package any order.

Photometric Curve

Cat. # INT-4-50L40...

Total Lumens - 4845

Total Wattage - 40.0

121 lumens per Watt

