

WARNINGS:

- Do not assemble continuous run on the ground and lift into place. Joints will distort and not create a tight fit. Joining hardware will have to be purchased and replaced.
- Risk of electrical shock or fire, disconnect power during installation or servicing. Read all instructions completely before starting installation. Install and wire in accordance to all national and local codes by a certified electrician. Fixture may be sharp, handle with care. Let fixture cool before maintenance.

AVERTISSEMENTS

- Risque d'électrocution ou d'incendie. Déconnectez l'alimentation durant l'installation ou la maintenance. Lisez attentivement toutes les instructions avant de commencer toute installation. Faites installer et câbler selon les normes Nationales et Locales par un électricien certifié. Les installations peuvent être coupantes, à manipuler avec précaution. Laissez refroidir les installations avant une opération de maintenance.

ADVERTENCIA

- Riesgo de descarga eléctrica o un incendio, desconecte la alimentación durante la instalación o servicio. Leer todas las instrucciones completas antes de empujar la instalación. Instalar y cablear en acuerdo a las reglas nacionales y códigos locales por un electricista certificado. El accesorio puede estar agudo, agarre con cuidado deje que el accesorio. Enfriar antes de mantenimiento.

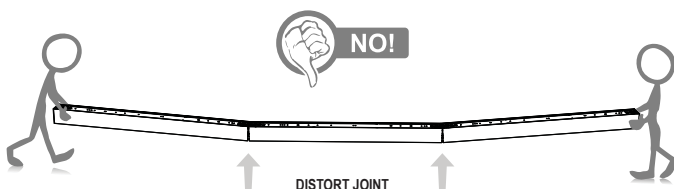

RECESSED GRID CEILING INSTALLATION DETAILS

Power Feed

Non-Power Feed

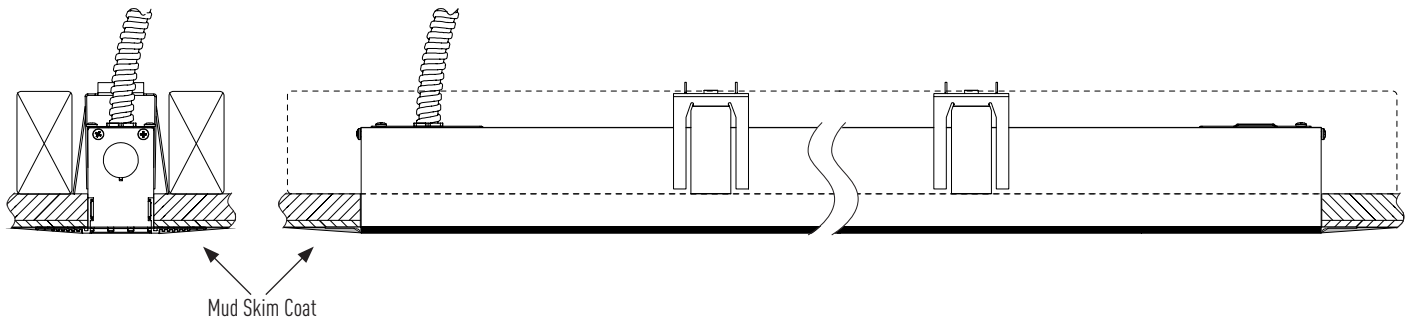

STANDARD LENGTHS

ORDERING EXAMPLE FOR STANDARD LENGTH

RM1-FF-05L40-1C-U-D-W-4

Lines

For linear individuals and continuous linear runs specify run lengths to the nearest foot for standard configurations. We can easily achieve lengths to the nearest 1/8" if necessary, custom drawings and lead times may apply.

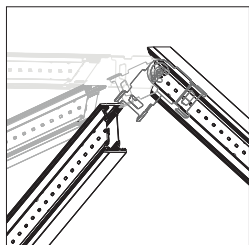
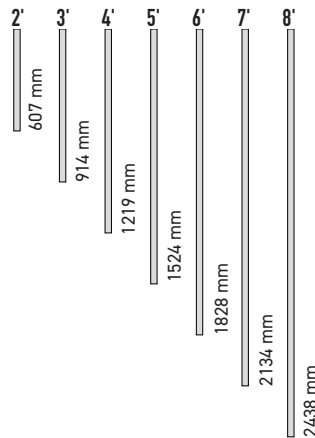

Adjustable Bracket design

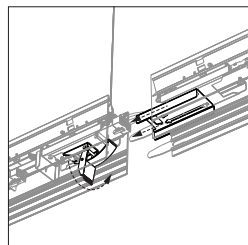

Tool less continuous joining

STANDARD SHAPES

ORDERING EXAMPLE FOR (U) SHAPE

RM1-FF-05L40-1C-U-D-W-4-U/D1-8'/D2-15'

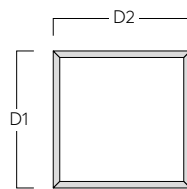

Squares and Rectangles (SQ)

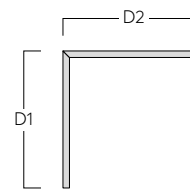

L Shapes (L)

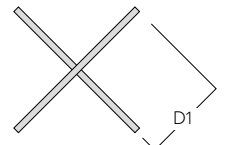

X Shapes (X)

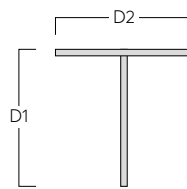

T Shapes (T)

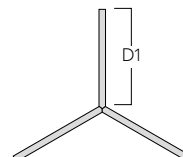

Tri Prong Shapes (TP)

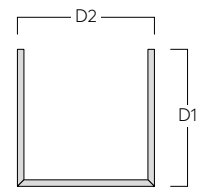

U Shapes (U)

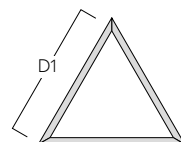

Equilateral Triangles (EQ)

Note:

Although these are standard shapes, take offs and shop drawings may be required depending on field conditions, ceiling type, etc. Consult your local Nulite rep with questions and concerns

INSTALLING AN INDIVIDUAL OR ROW STARTER LUMINAIRE

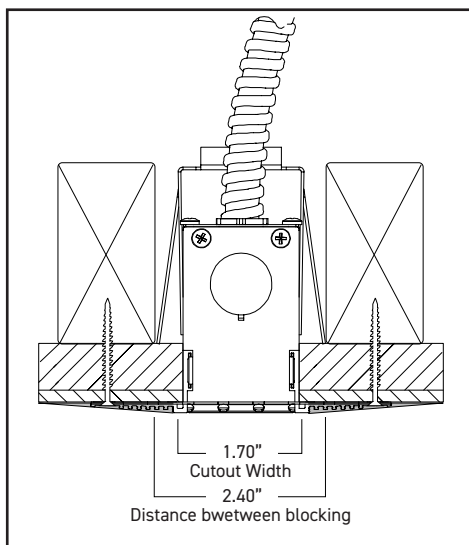
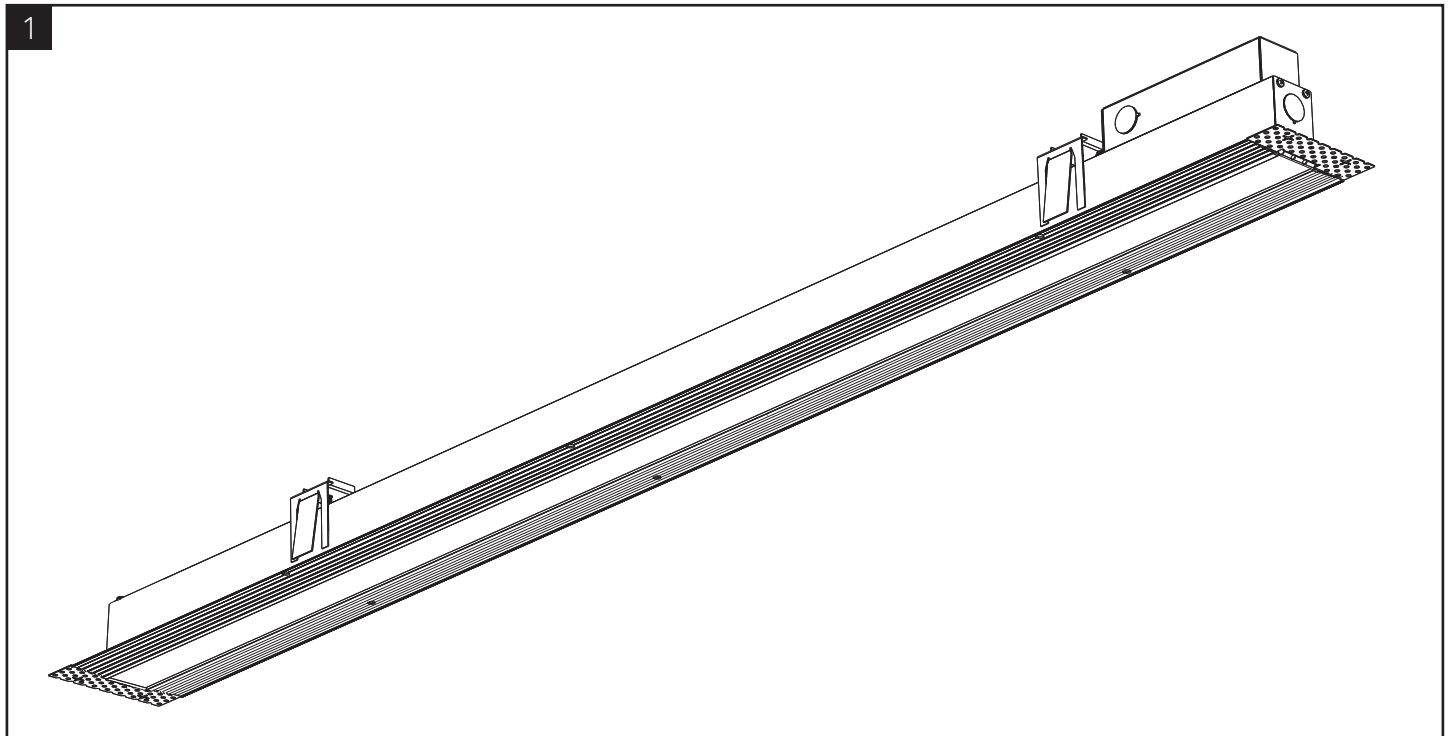

RM1 fixture end view

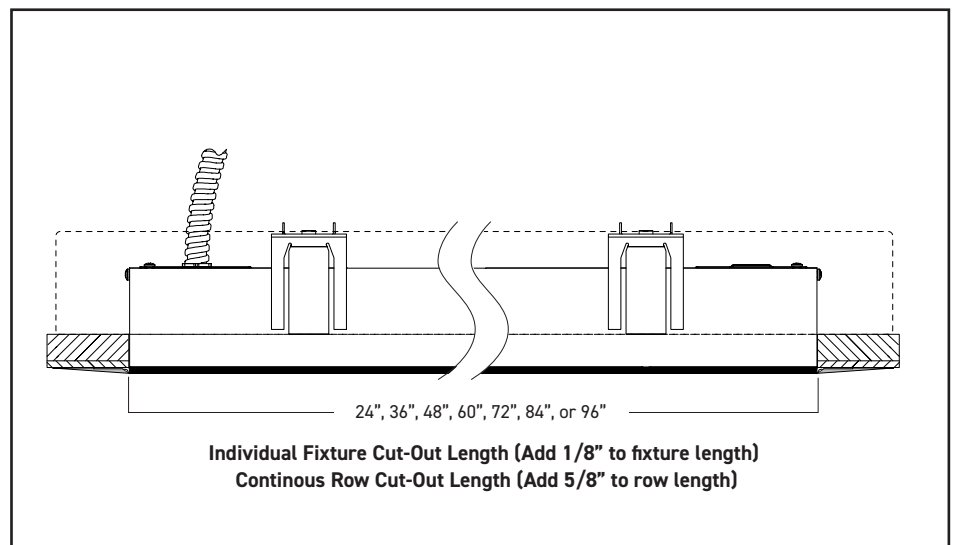

RM1 fixture side view

INSTALLING AN INDIVIDUAL OR ROW STARTER LUMINAIRE

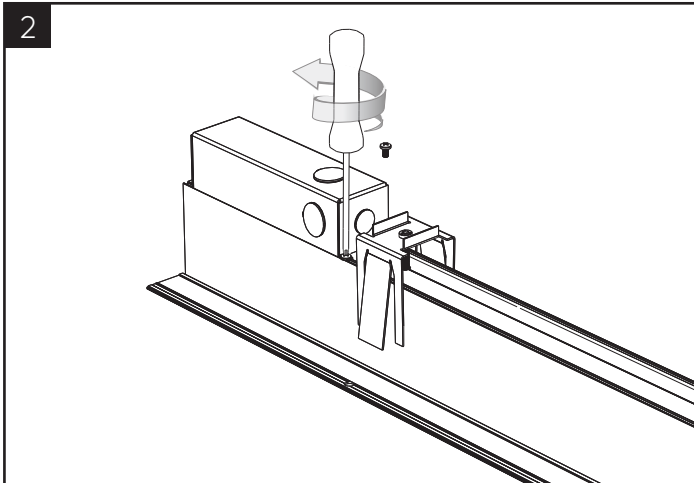

Remove splice box using screwdriver

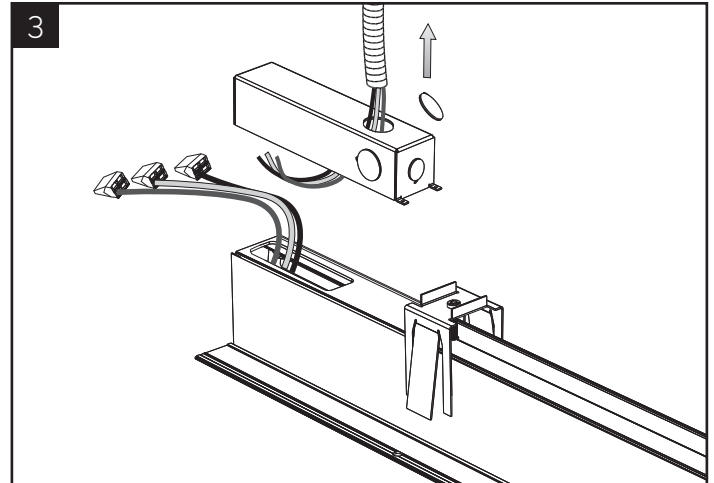

Remove knockout on splice box cover and feed line voltage leads the hole

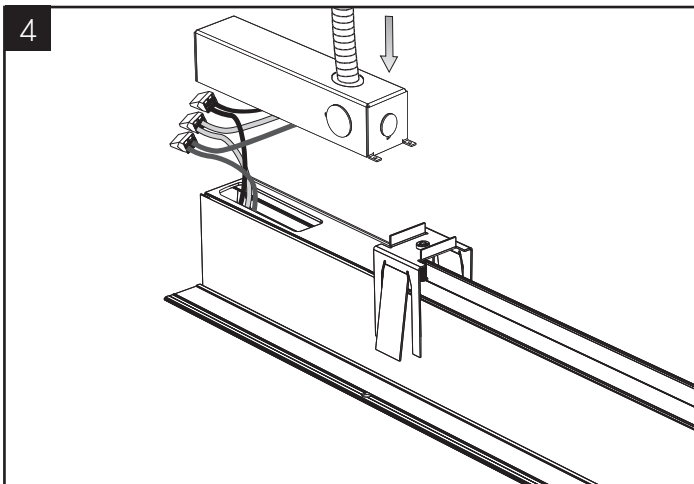

Secure the flex to the splice box cover. Connect line voltage leads to fixture leads.

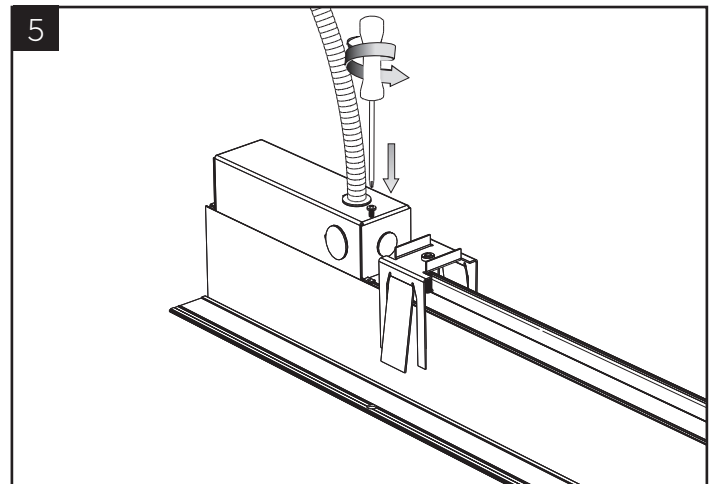

Secure the splice cover using the screws from step 2.

INSTALLING AN INDIVIDUAL OR ROW STARTER LUMINAIRE

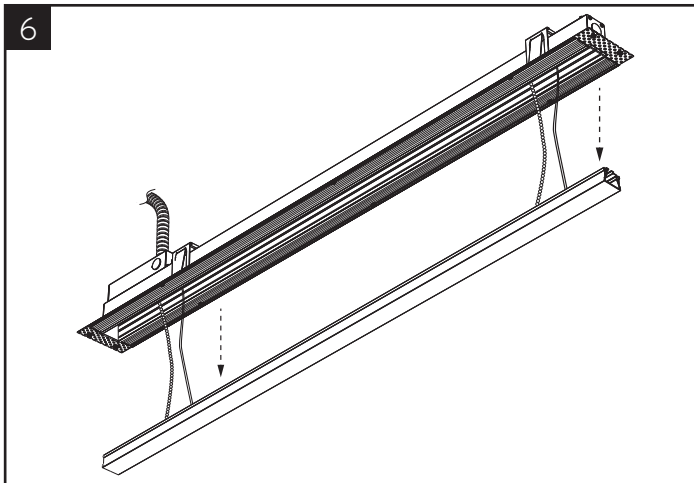

Dislodge the lens/LED board assembly from the bottom of the luminaire and let it hang by the support chains.

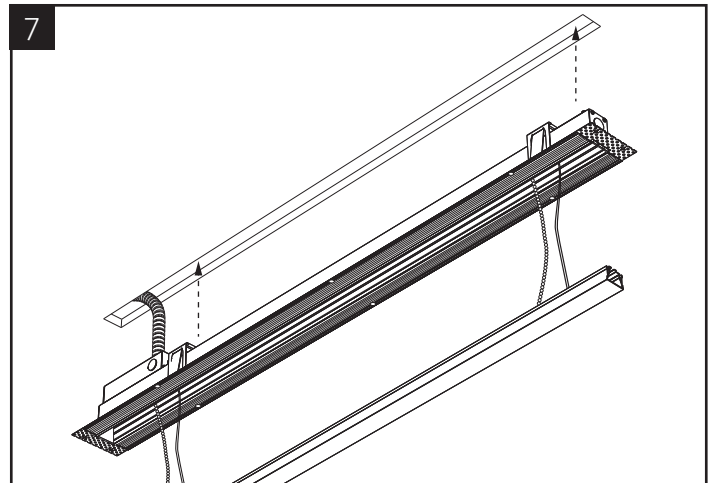

Insert luminaire into ceiling hole.

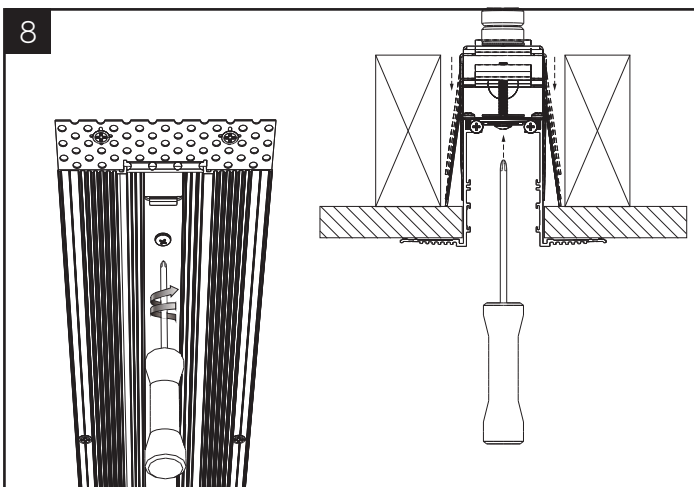

Push up on the yoke bolts. Make sure yoke legs snap over ceiling to secure the luminaire.

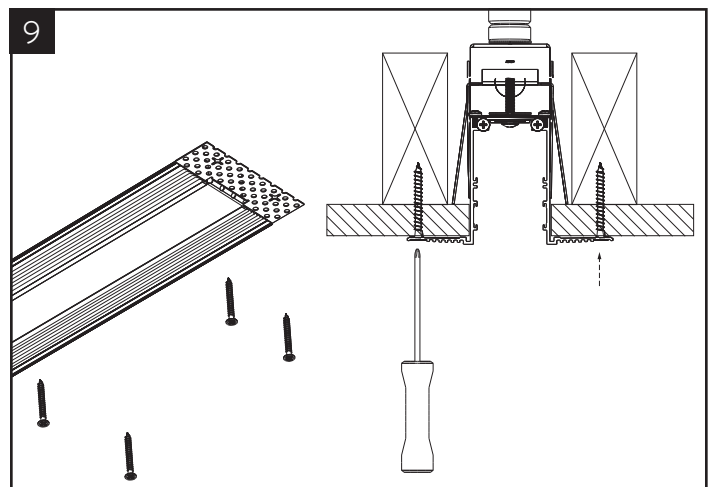

Secure the luminaire to blocking with drywall screws. Screws provided by others.

INSTALLING A ROW-MID OR ROW-END (AFTER STARTER HAS BEEN INSTALLED, STEP 2 TO 9 FROM PAGE 4 & 5)

After the "starter" or "mid" is fully secured with tie-wires, then make power connection and mount the next luminaire, then join them together as shown below and secure with two torsion spring latches that are integrated into the luminaire.

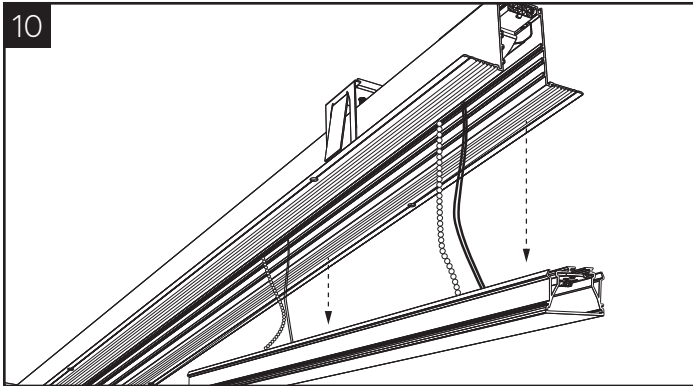

Dislodge the lens/LED board assembly from the bottom of the luminaire and let it hang by the support chains.

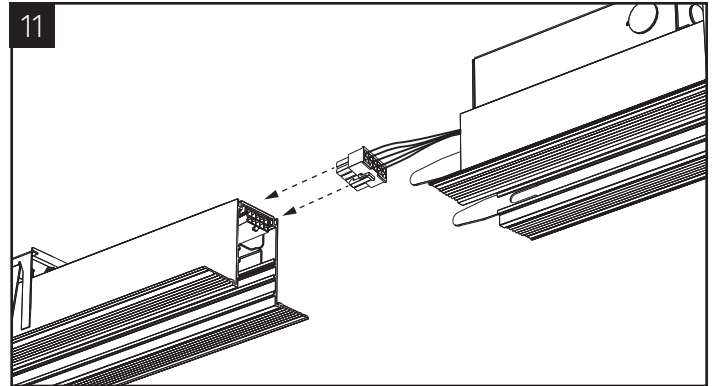

Connect male electrical connector from next fixture to female connector on the current fixture.

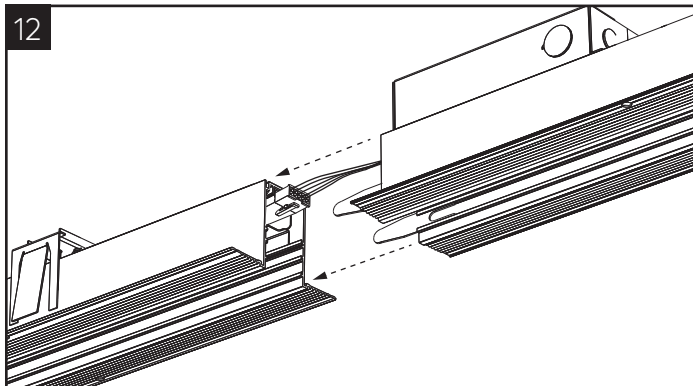

Insert alignment tabs from the next fixture into the slots on the current fixture.

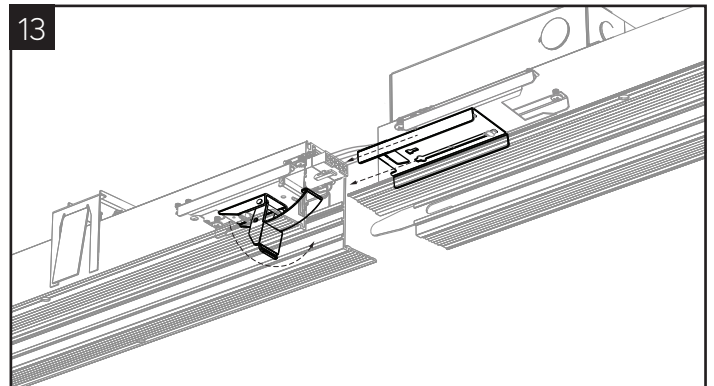

Release the alignment strap from the current fixture and extend the catch tray from the next fixture.

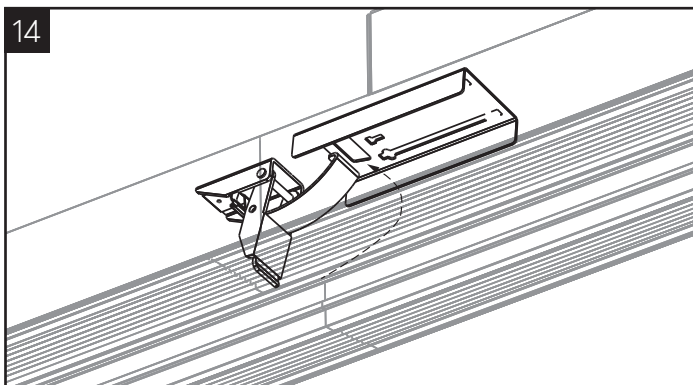

Connect the strap to the hole in the catch tray.

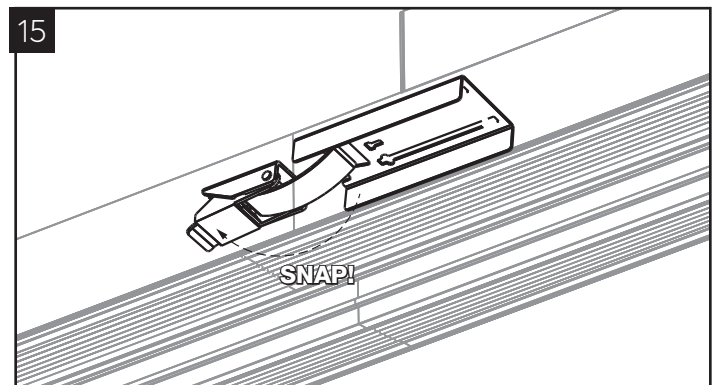

Collapse the alignment strap back to its original position to lock the two fixtures together.

INSTALLING A ROW-MID OR ROW-END (AFTER STARTER HAS BEEN INSTALLED, STEP 2 TO 9 FROM PAGE 4 & 5)

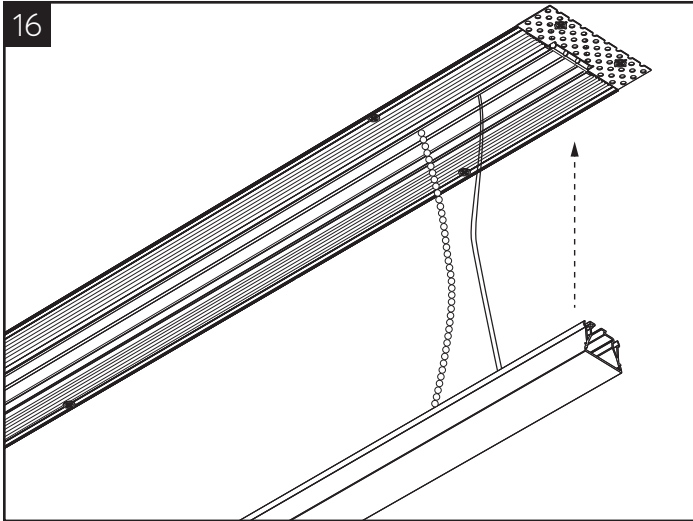

Replace the lens/LED board assembly from the bottom of the luminaire. Repeat for all fixture in the row.

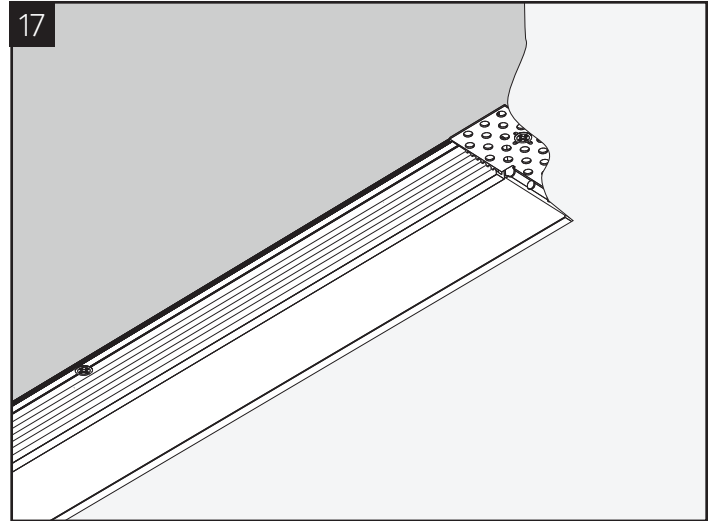

Apply joint compound around the luminaire. Feather the edges, the mud should stop at the lens and end cap.

